



Outils sécurisés pour travail en hauteur



Douilles & accessoires 1/4

Douilles & accessoires 3/8

Douilles & accessoires 1/2

Douilles & accessoires 3/4

Clés

Tournevis

Marteaux et massettes

Pinces

Outils divers

Outils isolés 1000V

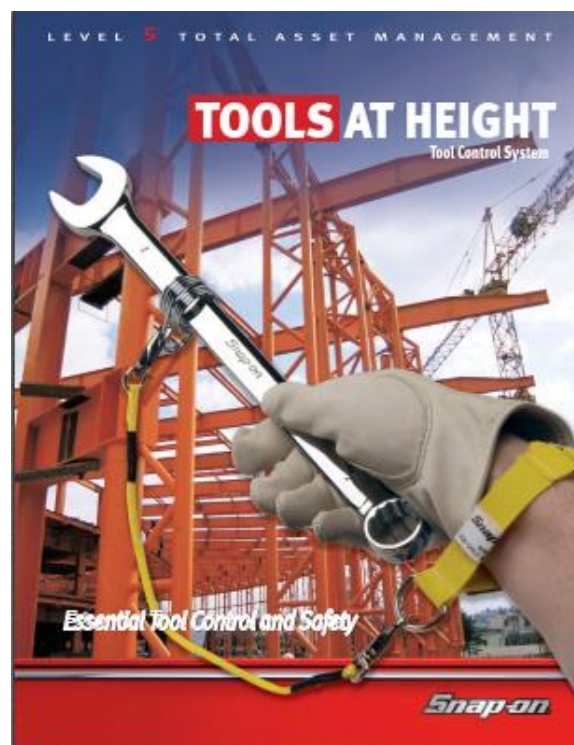

RATCHETS & HANDLES

1/4" Drive



1/4" Drive Tools@Height™ Ratchets & Accessories

| Stock No. | Description | Overall Length, inches | Repair Kit | Weight, lb (kg) |
|--------------|---|------------------------|-------------------|-----------------|
| THPRT | Pin Release Tool | - | - | - |
| THRKRT7272LB | Drive gear and screws to retrofit existing 72 ratchets models | N/A | - | 0.2 (0.09) |
| THT72 | Ratchet, Sealed Head (High Strength), Standard Handle | 4-7/16 | THRKRT72LB | 0.20 (0.09) |
| THTFY72 | Ratchet, Hi-Lok®, Flex Head | 6 1/4 | - | 0.30 (0.14) |
| THTHL72 | Ratchet, Sealed Head (High Strength), Long Handle, Soft Grip, Red | 6-7/8 | THRKRT72LB | 0.45 (0.2) |
| THTHLF72 | Ratchet, Sealed Head, Long Flex Head, Soft Grip, Red | 8-1/4 | THRKRT72LB | 0.52 (0.24) |
| THTKN72 | Ratchet, Round Head, Short Handle | 3-1/16 | RKRTHNF72 | 0.28 (0.13) |
| THTL72 | Ratchet, Sealed Head (High Strength) Long Handle | 6-1/2 | THRKRT72LB | 0.24 (0.11) |
| THTM77 | Adaptor, Ratcheting | 1-5/8 | - | 0.12 (0.05) |
| THTMR4 | Ratcheting Driver | 8-31/32 | - | 0.25 (0.11) |
| THTMRT8 | Ratcheting Driver, T-Handle | 10 | - | 0.60 (0.27) |
| THTMS70A | Spinner, Ratchet | 7/8 | - | 0.06 (0.03) |



1/4" Drive Handles

| Stock No. | Description | Overall Length, inches | Weight lb (kg) |
|-----------|---|------------------------|----------------|
| THTM10G | Breaker Bar | 6 | 0.18 (0.08) |
| THTM62B | Driver, Flexible, Standard Cable, Standard Handle | 6-3/4 | 0.20 (0.09) |
| THTM65 | Adjusting Tool, Flexible | 19-3/4" | 0.50 (0.23) |
| THT9TURBO | T-Handle, Turbo Speed (Blue-Point®) | 9-3/16" | 0.70 (0.32) |

EXTENSIONS & SOCKETS

1/4" Drive



1/4" Drive Tools@Height™ Extensions & Accessories

| Stock No. | Description | Overall Length, inches | Weight lb (kg) |
|-----------|--|------------------------|----------------|
| THTA3 | 1/4" Female x 3/8" Male Adaptor | 15/16 | 0.05 (0.02) |
| THTMX1 | Extension | 1 | 0.03 (0.01) |
| THTMU8B | Universal Joint | 1-5/16 | 0.04 (0.02) |
| THTMXM114 | Adaptor, Magnetic, 1/4" Internal Drive | 1-17/32 | 0.04 (0.02) |
| THTMXM17 | Adaptor, Magnetic, 1/4" Internal Drive | 1-21/32 | 0.04 (0.02) |
| THTMXK2 | Knurled Extension | 2 | 0.06 (0.03) |
| THTMXK4 | Knurled Extension | 4 | 0.10 (0.05) |
| THTMXK60 | Knurled Extension | 6 | 0.14 (0.06) |
| THTMXK80 | Knurled Extension | 8 | 0.17 (0.08) |
| THTMXK110 | Knurled Extension | 11 | 0.25 (0.11) |
| THTMXK140 | Knurled Extension | 14 | 0.30 (0.14) |
| THTMX240 | Extension | 24 | 0.73 (0.33) |



THTMMD14

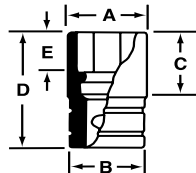

Shallow, mm

| mm | 12 | A | B | C | D | E | Weight lbs (kg) |
|-----|-----------|------|------|------|------|-----|-----------------|
| 5 | THTMMD5 | 7.7 | 12.1 | 13.3 | 22.2 | 4.3 | 0.023 (0.01) |
| 5.5 | THTMMD5.5 | 8.3 | 12.1 | 13.3 | 22.2 | 4.6 | 0.02 (0.01) |
| 6 | THTMMD6 | 9.3 | 12.1 | 13.3 | 22.2 | 5.6 | 0.02 (0.01) |
| 7 | THTMMD7 | 10.5 | 12.1 | 13.3 | 22.2 | 6.1 | 0.02 (0.01) |
| 8 | THTMMD8 | 11.5 | 12.1 | 13.3 | 22.2 | 7.4 | 0.02 (0.01) |
| 9 | THTMMD9 | 12.7 | 12.1 | 13.3 | 22.2 | 7.4 | 0.024 (0.01) |
| 10 | THTMMD10 | 13.2 | 13.2 | 13.3 | 22.2 | 7.4 | 0.05 (0.02) |
| 11 | THTMMD11 | 15.2 | 14.6 | 13.3 | 22.2 | 9.4 | 0.065 (0.03) |
| 12 | THTMMD12 | 16.5 | 15.6 | 13.3 | 22.2 | 9.4 | 0.04 (0.02) |
| 13 | THTMMD13 | 17.6 | 16.7 | 13.3 | 22.2 | 9.4 | 0.05 (0.02) |
| 14 | THTMMD14 | 18.8 | 17.8 | 14.1 | 22.2 | 9.7 | 0.05 (0.02) |

*Conventional hex



THTM16

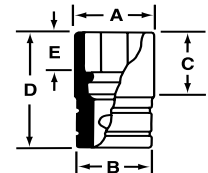

Shallow, inches

| 12 | 6 | 12 | A | B | C | D | E | Weight lbs (kg) |
|--------|--------|---------|-------|-------|------|-------|------|-----------------|
| 1/8 | THTM04 | — | 7/32 | 7/16 | 1/2 | 7/8 | 1/8 | 0.02 (0.01) |
| 5/32 | THTM05 | — | 9/32 | 15/32 | 1/2 | 7/8 | 5/32 | 0.021 (0.01) |
| 3/16 | THTM6* | THTMD6* | 9/32 | 15/32 | 1/2 | 7/8 | 5/32 | 0.022 (0.01) |
| 7/32 | THTM7* | THTMD7* | 11/32 | 15/32 | 1/2 | 7/8 | 3/16 | 0.02 (0.01) |
| 1/4 | THTM8 | THTMD8 | 3/8 | 15/32 | 1/2 | 7/8 | 7/32 | 0.02 (0.01) |
| 9/32 | THTM9 | THTMD9 | 13/32 | 15/32 | 1/2 | 7/8 | 1/4 | 0.02 (0.01) |
| 5/16 | THTM10 | THTMD10 | 15/32 | 15/32 | 1/2 | 7/8 | 9/32 | 0.03 (0.01) |
| 1-1/32 | THTM11 | THTMD11 | 1/2 | 15/32 | 5/16 | 7/8 | 9/32 | 0.025 (0.01) |
| 3/8" | THTM12 | THTMD12 | 17/32 | 1/2 | 1/2 | 7/8 | 9/32 | 0.03 (0.01) |
| 7/16" | THTM14 | THTMD14 | 19/32 | 9/16 | 1/2 | 7/8 | 3/8 | 0.03 (0.01) |
| 1/2" | THTM16 | THTMD16 | 11/16 | 21/32 | 1/2 | 7/8 | 3/8 | 0.05 (0.02) |
| 9/16" | THTM18 | THTMD18 | 25/32 | 23/32 | 1/2 | 29/32 | 3/8 | 0.06 (0.03) |

*Conventional hex



Competitor socket



Snap-on® socket



Snap-on® T@H sockets, extensions, and adaptors feature a locking hole on all four sides, not just one. T@H ratchets and drive tools feature a locking pin which mates with the side lock hole for positive retention. This reduces the risk of misaligning the socket that typical competitor's sockets with just one side hole create.

Release pin with THPRT – Pin Release Tool for Square Drive Tools
Do not use quick release tools with locking collars or push button release. These tools can be disengaged inadvertently.

WARNING



- Wear appropriate eye protection
- Be sure to use a lanyard that has more weight capacity than the tool you are attaching because drop forces are greater than actual tool weight.
- Any tool that weighs more than 5 pounds should be attached to an anchor point such as a work platform or utility bucket rather than the operator.
- Do not use "cheater bars" on handles
- Read safety precautions on pages W1 to W4



TOOLS@HEIGHT™ & SAFETY

SOCKETS

1/4" Drive



THTMMDS14

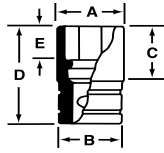

Semi Deep, mm

| mm | 12 | A | B | C | D | E | Weight, lb (kg) |
|-----|------------|------|------|------|------|-----|-----------------|
| 5 | THTMMDS5* | 7.7 | 12.1 | 22.9 | 31.8 | 5.1 | 0.03 (0.01) |
| 5.5 | THTMMDS5.5 | 8.3 | 12.1 | 22.9 | 31.8 | 5.3 | 0.03 (0.01) |
| 6 | THTMMDS6 | 9.3 | 12.1 | 22.9 | 31.8 | 5.8 | 0.03 (0.01) |
| 7 | THTMMDS7 | 10.5 | 12.1 | 22.9 | 31.8 | 6.1 | 0.05 (0.02) |
| 8 | THTMMDS8 | 11.5 | 12.1 | 18.4 | 31.8 | 6.9 | 0.40 (0.18) |
| 9 | THTMMDS9 | 12.7 | 12.1 | 18.4 | 31.8 | 7.4 | 0.045 (0.02) |
| 10 | THTMMDS10 | 14 | 13.2 | 18.4 | 31.8 | 7.4 | 0.05 (0.02) |
| 11 | THTMMDS11 | 15.4 | 14.6 | 18.4 | 31.8 | 9.4 | 0.06 (0.03) |
| 12 | THTMMDS12 | 16.5 | 15.6 | 18.4 | 31.8 | 9.4 | 0.06 (0.03) |
| 13 | THTMMDS13 | 17.6 | 16.7 | 18.4 | 31.8 | 9.4 | 0.08 (0.04) |
| 14 | THTMMDS14 | 18.8 | 17.8 | 18.4 | 31.8 | 9.7 | 0.08 (0.04) |
| 15 | THTMMDS15 | 20.4 | 19.4 | 18.4 | 31.8 | 9.7 | 0.10 (0.05) |

*Conventional hex



THSTMMD14

Deep, mm

| mm | 12 | A | B | C | D | E | Weight, lb (kg) |
|-----|------------|------|------|------|------|-----|-----------------|
| 5 | THSTMMD5* | 7.7 | 12.1 | 42.2 | 50.8 | 5.1 | 0.05 (0.02) |
| 5.5 | THSTMMD5.5 | 8.3 | 12.1 | 42.2 | 50.8 | 5.3 | 0.04 (0.02) |
| 6 | THSTMMD6 | 9.3 | 12.1 | 42.2 | 50.8 | 5.8 | 0.05 (0.02) |
| 7 | THSTMMD7 | 10.5 | 12.1 | 42.2 | 50.8 | 6.1 | 0.05 (0.02) |
| 8 | THSTMMD8 | 11.5 | 12.1 | 42.2 | 50.8 | 6.9 | 0.05 (0.02) |
| 9 | THSTMMD9 | 12.7 | 12.1 | 38.1 | 50.8 | 7.4 | 0.06 (0.03) |
| 10 | THSTMMD10 | 14 | 13.2 | 38.1 | 50.8 | 7.4 | 0.075 (0.03) |
| 11 | THSTMMD11 | 15.2 | 14.6 | 38.1 | 50.8 | 9.4 | 0.09 (0.04) |
| 12 | THSTMMD12 | 16.5 | 15.6 | 38.1 | 50.8 | 9.4 | 0.10 (0.05) |
| 13 | THSTMMD13 | 17.6 | 16.7 | 38.1 | 50.8 | 9.4 | 0.18 (0.08) |
| 14 | THSTMMD14 | 18.8 | 17.8 | 38.1 | 50.8 | 9.7 | 0.12 (0.05) |

*Conventional hex



THTMUM13A

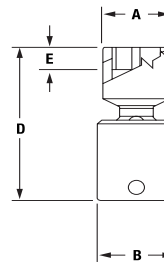

Shallow Universal, mm

| mm | 12 | A | B | D | E | Weight, lb (kg) |
|----|-----------|------|------|------|-----|-----------------|
| 5 | THTMUM5A | 8.1 | 12.7 | 29.2 | 3.3 | 0.05 (0.02) |
| 6 | THTMUM6A | 9.6 | 12.7 | 29.7 | 3.8 | 0.04 (0.02) |
| 7 | THTMUM7A | 10.7 | 12.7 | 30.5 | 4.3 | 0.04 (0.02) |
| 8 | THTMUM8A | 11.8 | 12.7 | 30.5 | 4.8 | 0.04 (0.02) |
| 9 | THTMUM9A | 12.7 | 12.7 | 31.2 | 4.8 | 0.10 (0.05) |
| 10 | THTMUM10A | 14 | 12.7 | 32.5 | 5.8 | 0.04 (0.02) |
| 12 | THTMUM12A | 16.5 | 12.7 | 34.5 | 6.9 | 0.05 (0.02) |
| 13 | THTMUM13A | 17.3 | 12.7 | 36.8 | 7.6 | 0.05 (0.02) |



THTMDS16

Semi Deep, inches

| 11 | 12 | A | B | C | D | E | Weight, lb (kg) |
|--------|----------|-------|-------|-------|-------|------|-----------------|
| 3/16 | THTMDS6* | 5/16 | 15/32 | 29/32 | 1 1/4 | 7/32 | 0.03 (0.01) |
| 7/32 | THTMDS7* | 11/32 | 15/32 | 29/32 | 1 1/4 | 7/32 | 0.03 (0.01) |
| 1/4 | THTMDS8 | 3/8 | 15/32 | 29/32 | 1 1/4 | 1/4 | 0.03 (0.01) |
| 9/32 | THTMDS9 | 13/32 | 15/32 | 23/32 | 1 1/4 | 1/4 | 0.03 (0.01) |
| 5/16 | THTMDS10 | 15/32 | 15/32 | 23/32 | 1 1/4 | 9/32 | 0.04 (0.02) |
| 1-1/32 | THTMDS11 | 1/2 | 15/32 | 23/32 | 1 1/4 | 5/16 | 0.04 (0.02) |
| 3/8" | THTMDS12 | 9/16 | 1/2 | 23/32 | 1 1/4 | 5/16 | 0.055 (0.02) |
| 7/16" | THTMDS14 | 5/8 | 19/32 | 23/32 | 1 1/4 | 3/8 | 0.05 (0.02) |
| 1/2" | THTMDS16 | 11/16 | 21/32 | 23/32 | 1 1/4 | 3/8 | 0.99 (0.45) |
| 9/16" | THTMDS18 | 3/4 | 23/32 | 23/32 | 1 1/4 | 3/8 | 0.085 (0.04) |

*Conventional hex



THSTMD16

Deep, inches

| 11 | 6 | 12 | A | B | C | D | E | Weight, lb (kg) |
|--------|---------|----------|-------|-------|---------|---|------|-----------------|
| 3/16 | THSTM6* | THSTMD6* | 5/16 | 15/32 | 1 21/32 | 2 | 3/16 | 0.04 (0.02) |
| 7/32 | THSTM7* | THSTMD7* | 11/32 | 15/32 | 1 21/32 | 2 | 7/32 | 0.04 (0.02) |
| 1/4 | THSTM8 | THSTMD8 | 3/8 | 15/32 | 1 21/32 | 2 | 7/32 | 0.04 (0.02) |
| 9/32 | THSTM9 | THSTMD9 | 13/32 | 15/32 | 1 21/32 | 2 | 1/4 | 0.05 (0.02) |
| 5/16 | THSTM10 | THSTMD10 | 15/32 | 15/32 | 1 21/32 | 2 | 7/32 | 0.06 (0.03) |
| 1-1/32 | THSTM11 | THSTMD11 | 1/2 | 15/32 | 1 21/32 | 2 | 9/32 | 0.05 (0.02) |
| 3/8" | THSTM12 | THSTMD12 | 17/32 | 9/16 | 1 21/32 | 2 | 9/32 | 0.10 (0.05) |
| 7/16" | THSTM14 | THSTMD14 | 5/8 | 9/16 | 1 21/32 | 2 | 3/8 | 0.10 (0.05) |
| 1/2" | THSTM16 | THSTMD16 | 11/16 | 21/32 | 1 21/32 | 2 | 3/8 | 0.12 (0.05) |
| 9/16" | THSTM18 | THSTMD18 | 3/4 | 23/32 | 1 21/32 | 2 | 3/8 | 0.13 (0.06) |

*Conventional hex



THTM412

Double Square

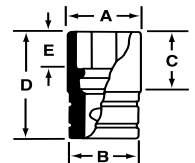

| 11 | Stock No. | A | B | C | D | E | Weight, lb (kg) |
|------|-----------|-------|-------|-------|-----|------|-----------------|
| 1/4 | THTM408 | 15/32 | 15/32 | 17/32 | 7/8 | 1/4 | 0.027 (0.01) |
| 5/16 | THTM410 | 9/16 | 17/32 | 17/32 | 7/8 | 9/32 | 0.04 (0.02) |
| 3/8" | THTM412 | 21/32 | 5/8 | 17/32 | 7/8 | 5/16 | 0.05 (0.02) |

Shallow Universal, inches

| 11 | 12 | A | B | D | E | Weight, lb (kg) |
|-------|-----------|-------|-----|---------|-------|-----------------|
| 1/4 | THTMU81B | 3/8 | 1/2 | 1 17/64 | 1/4 | 0.37 (0.17) |
| 5/16 | THTMU101A | 15/32 | 1/2 | 1 11/32 | 9/32 | 0.04 (0.02) |
| 3/8" | THTMU121A | 17/32 | 1/2 | 1 27/64 | 9/32 | 0.05 (0.02) |
| 7/16" | THTMU141A | 19/32 | 1/2 | 1 29/64 | 13/32 | 0.05 (0.02) |
| 1/2" | THTMU161A | 11/16 | 1/2 | 1 33/64 | 13/32 | 0.05 (0.02) |
| 9/16" | THTMU181A | 3/4 | 1/2 | 1 35/64 | 13/32 | 0.06 (0.03) |

SOCKETS

1/4" Drive



THTMA8E

Hex Bit, Standard Length, mm

| mm | | A | Weight, lb (kg) |
|-----|------------|------|-----------------|
| 2 | THTMAM2E | 47.8 | 0.03 (0.01) |
| 2.5 | THTMAM2.5E | 47.8 | 0.04 (0.02) |
| 3 | THTMAM3E | 47.8 | 0.04 (0.02) |
| 4 | THTMAM4E | 47.8 | 0.04 (0.02) |
| 5 | THTMAM5E | 47.8 | 0.04 (0.02) |
| 6 | THTMAM6E | 47.8 | 0.05 (0.02) |

Hex Bit, Standard Length, inches

| Hex | | A | B | Weight, lb (kg) |
|------|-----------|----------|-----------|-----------------|
| 5/64 | THTMA2.5E | 1-7/8" | TMA2.5E2A | 0.04 (0.02) |
| 1/16 | THTMA2E | 1-7/8" | TMA2E2 | 0.03 (0.01) |
| 3/32 | THTMA3E | 1-7/8" | TMA3E2A | 0.06 (0.03) |
| 7/64 | THTMA3.5E | 1-7/8" | TMA3.5E2A | 0.03 (0.01) |
| 1/8 | THTMA4E | 1-7/8" | TMA4E2 | 0.06 (0.03) |
| 9/64 | THTMA4.5E | 1-7/8" | TMA4.5E2 | 0.06 (0.03) |
| 5/32 | THTMA5E | 1-7/8" | FA5E2 | 0.06 (0.03) |
| 3/16 | THTMA6E | 1-15/16" | FA6E2 | 0.04 (0.02) |
| 7/32 | THTMA7E | 1-7/8" | FA7E2 | 0.04 (0.02) |
| 1/4 | THTMA8E | 1-7/8" | FA8E2 | 0.05 (0.02) |



THTMAB4E

Ball Hex Bit, Standard Length, inches

| Hex | | A | B | Weight, lb (kg) |
|------|------------|--------|-----------|-----------------|
| 1/8 | THTMAB4E | 1-7/8" | TMAB4E2 | 0.03 (0.02) |
| 9/64 | THTMAB4.5E | 1-7/8" | TMAB4.5E2 | 0.04 (0.04) |
| 5/32 | THTMAB5E | 1-7/8" | TMAB5E2 | 0.04 (0.02) |
| 3/16 | THTMAB6E | 1-7/8" | TMAB6E2 | 0.04 (0.02) |



THTMP22E

Philips® Screwdriver Bit

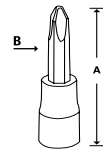

| Hex | Stock No. | A | B | Weight, lb (kg) |
|----------|-------------|--------|---------|-----------------|
| Standard | #1 THTMP12E | 1-7/8" | TMP12E2 | 0.04 (0.02) |
| | #2 THTMP22E | 1-7/8" | FP22E2 | 0.03 (0.01) |
| | #2 THTMP23E | 1-7/8" | TMP23E2 | 0.04 (0.02) |
| Short | #2 THTMP21E | 1-7/8" | TMP21E | 0.05 (0.02) |

Clutch Tip Screwdriver Bit, Standard Length



THTM30E

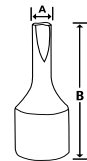

| Hex | Stock No. | A | B | Weight, lb (kg) |
|------|-----------|-------|--------|-----------------|
| 3/16 | THTM27E | 3/16" | 1-3/8" | 0.03 (0.01) |
| 1/4 | THTM30E | 1/4" | 1-3/8" | 0.05 (0.02) |
| 5/32 | THTM31E | 5/32" | 1-3/8" | 0.05 (0.02) |



THTMC16

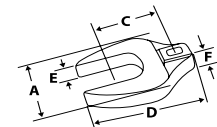

Crowfoot Wrenches, Open End

| Hex | Stock No. | A | C | E | F | D | Weight, lb (kg) |
|------|-----------|--------|-------|------|------|--------|-----------------|
| 1/4 | THTMC8 | 17/32 | 17/32 | 1/4 | 1/4 | 31/32 | 0.03 (0.01) |
| 5/16 | THTMC10 | 21/32 | 9/16 | 1/4 | 1/4 | 1 1/32 | 0.03 (0.01) |
| 3/8 | THTMC12 | 25/32 | 19/32 | 1/4 | 1/4 | 1 3/32 | 0.03 (0.01) |
| 7/16 | THTMC14 | 7/8 | 5/8 | 5/16 | 5/16 | 1 5/32 | 0.05 (0.02) |
| 1/2 | THTMC16 | 1 1/32 | 21/32 | 5/16 | 5/16 | 1 1/4 | 0.05 (0.02) |
| 9/16 | THTMC18 | 1 1/8 | 11/16 | 5/16 | 5/16 | 1 9/32 | 0.05 (0.02) |



THTMC105E



THTM83A

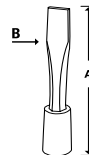

Flat Tip Screwdriver Bit

| Hex | Stock No. | A | B | Weight, lb (kg) |
|----------|-----------------------|----------|----------|-----------------|
| Standard | 3/16 x .032 THTMC104E | 2-7/8" | TMC104E2 | 0.07 (0.03) |
| | 1/4 x .032 THTMC105E | 2-15/16" | TMC105E2 | 0.05 (0.02) |
| | 3/8 x .042 THTMC106E | 2-7/8" | TMC106E2 | 0.06 (0.03) |
| Short | 1/4 x .036 THTM82 | 7/8" | TM82-2C | 0.02 (0.01) |
| | 3/8 x 1/32 THTM83A | 3/4" | - | 0.03 (0.01) |
| | 7/16 x 1/32 THTM84 | 3/4" | - | 0.03 (0.01) |

Ball Hex, Standard Length, mm

| mm | | A | Weight, lb (kg) |
|-----|------------|------|-----------------|
| 2 | THTMAM2E | 47.8 | 0.03 (0.01) |
| 2.5 | THTMAM2.5E | 47.8 | 0.04 (0.02) |
| 3 | THTMAM3E | 47.8 | 0.04 (0.02) |
| 4 | THTMAM4E | 47.8 | 0.04 (0.02) |



THTMAM4E



- Wear appropriate eye protection
- Be sure to use a lanyard that has more weight capacity than the tool you are attaching because drop forces are greater than actual tool weight.
- Any tool that weighs more than 5 pounds should be attached to an anchor point such as a work platform or utility bucket rather than the operator.
- Do not use "cheater bars" on handles
- Read safety precautions on pages W1 to W4



Distribué par :

RATCHETS, HANDLES AND EXTENSIONS

3/8" Drive

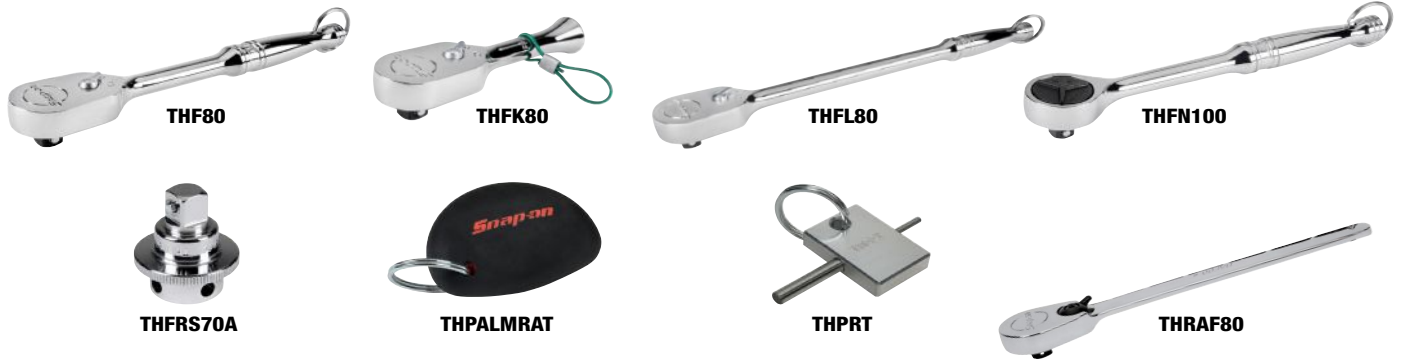

3/8" Drive Tools@Height™ Ratchets & Accessories

| Stock No. | Description | Overall Length, inches | Repair Kit | Weight lb (kg) |
|--------------|--|------------------------|------------|----------------|
| THF80 | 3/8" Drive, Standard Handle Ratchet | 7-7/16 | THRKRFB0LB | 0.66 (0.3) |
| THFK80 | 81 Tooth Stubby Handle Ratchet | 4-3/16 | THRKRFB0LB | 0.66 (0.30) |
| THFL80 | Long Handle Ratchet | 10-5/16 | THRKRFB0LB | 0.78 (0.35) |
| THFN100 | Round Head Ratchet, Standard Length | 7-7/16 | - | 0.60 (0.27) |
| THFRS70A | SPINNER | 1-5/16 | - | 0.13 (0.06) |
| THPALMRAT | Tethered Palm Ratchet | 2-3/4 | - | 0.75 (0.34) |
| THPRT | Pin Release Tool | - | - | - |
| THRAF80 | Ratchet, Low Profile, Dual80® Tech | 7 1/2 | THRKRFB0LB | 0.37 (0.17) |
| THRKRFB080LB | Drive gear and screws to retrofit existing 80 tooth ratchet models | - | - | - |
| THRKRFB0LB | Repair Kit | - | - | - |



3/8" Drive Handles

| Stock No. | Description | Overall Length, inches | Weight, lbs (kg) |
|------------|--|------------------------|------------------|
| THF10LA | Breaker Bar | 9-9/16 | 0.65 (0.29) |
| THF11TURBO | Turbo-T Seed Driver 3/8" Square Drive | - | 1.3 (0.59) |



3/8" Drive Tools@Height™ Extensions & Accessories

| Stock No. | Description | Overall Length, inches | Replacement Bits | Weight, lbs (kg) |
|-----------|---------------------------------|------------------------|------------------|------------------|
| THFX1 | Extension 3/8 in Drive | 1-1/2 | - | 0.11 (0.05) |
| THFXK3 | Extension 3/8 in Drive | 3 | - | 0.18 (0.08) |
| THFXK4 | Extension 3/8 in Drive | 4 | - | 0.21 (0.10) |
| THFXK6 | Extension 3/8 in Drive | 6 | - | 0.27 (0.12) |
| THFXK8 | Extension 3/8 in Drive | 8 | - | 0.35 (0.16) |
| THFXK11 | Extension 3/8 in Drive | 11 | - | 0.47 (0.21) |
| THFU8A | Universal Joint | 2-1/16 | - | 0.14 (0.06) |
| THA2A | 3/8" Drive Square Drive Adaptor | 1-5/16 | - | 0.10 (0.05) |
| THGFAT1E | ADAPTOR | 1-1/4 | THGFAT1E2 | 0.09 (0.04) |

3/8" Drive

Shallow, mm

| mm | 6 | 12 | A | B | C | D | E | Weight, lb (kg) |
|----|---------|--------|------|------|------|------|------|-----------------|
| 6 | THFSM61 | — | 9.1 | 17.2 | 11.1 | 23 | 5.6 | 0.05 (0.02) |
| 7 | THFSM71 | — | 10.4 | 17.2 | 11.1 | 23 | 5.6 | 0.60 (0.27) |
| 8 | — | THFM8 | 11.6 | 17.2 | 11.1 | 23 | 6.4 | 0.04 (0.02) |
| 9 | — | THFM9 | 13.1 | 17.2 | 11 | 23 | 7.1 | 0.04 (0.02) |
| 10 | — | THFM10 | 14.3 | 17.2 | 11 | 23 | 7.1 | 0.05 (0.02) |
| 11 | — | THFM11 | 15.4 | 17.2 | 11 | 23 | 7.1 | 0.04 (0.02) |
| 12 | — | THFM12 | 16.5 | 17.2 | 11.9 | 23.8 | 8.1 | 0.50 (0.23) |
| 13 | — | THFM13 | 18 | 17.2 | 12.6 | 24.6 | 8.1 | 0.05 (0.02) |
| 14 | — | THFM14 | 19.6 | 18.6 | 13.2 | 26.2 | 9.1 | 0.06 (0.03) |
| 15 | — | THFM15 | 20.3 | 19.4 | 13.7 | 27 | 9.1 | 0.07 (0.03) |
| 16 | — | THFM16 | 21.1 | 20.2 | 15 | 27.8 | 10.4 | 0.08 (0.04) |
| 17 | — | THFM17 | 22.7 | 21.8 | 15 | 28.6 | 10.4 | 0.10 (0.05) |
| 18 | — | THFM18 | 24.3 | 23.2 | 15.7 | 28.6 | 10.9 | 0.12 (0.05) |
| 19 | — | THFM19 | 25.1 | 24 | 16.3 | 30.2 | 11.9 | 0.13 (0.06) |



THFSM61



THFM14

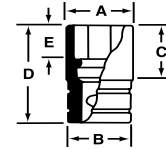

Shallow, inches

| 11 | 6 | 12 | A | B | C | D | E | Weight lbs (kg) |
|--------|--------|---------|--------|--------|-------|---------|-------|-----------------|
| 1/4 | THF081 | THFS081 | 13/32 | 11/16 | 7/16 | 29/32 | 7/32 | 0.05 (0.02) |
| 5/16 | THF101 | THFS101 | 15/32 | 11/16 | 7/16 | 29/32 | 1/4 | 0.04 (0.02) |
| 1-1/32 | THF111 | THFS111 | 1/2 | 11/16 | 7/16 | 29/32 | 9/32 | 0.04 (0.02) |
| 3/8" | THF121 | THFS121 | 9/16 | 11/16 | 7/16 | 29/32 | 9/32 | 0.05 (0.02) |
| 7/16" | THF141 | THFS141 | 5/8 | 11/16 | 7/16 | 29/32 | 9/32 | 0.05 (0.02) |
| 1/2" | THF161 | THFS161 | 23/32 | 11/16 | 1/2 | 15/16 | 5/16 | 0.05 (0.02) |
| 9/16" | THF181 | THFS181 | 25/32 | 3/4 | 1/2 | 1-1/32 | 3/8 | 0.07 (0.03) |
| 5/8" | THF201 | THFS201 | 27/32 | 25/32 | 19/32 | 1-3/32 | 1/2 | 0.08 (0.04) |
| 11/16" | THF221 | THFS221 | 15/16 | 7/8 | 5/8 | 1-1/8 | 17/32 | 0.11 (0.05) |
| 3/4" | THF241 | THFS241 | 1 | 15/16 | 11/16 | 1-3/16 | 15/32 | 0.13 (0.06) |
| 13/16" | THF261 | THFS261 | 1-1/16 | 1 | 11/16 | 1-7/32 | 1/2 | 0.15 (0.07) |
| 7/8" | THF281 | THFS281 | 1-5/32 | 1-1/32 | 23/32 | 1-9/32 | 9/16 | 0.20 (0.09) |
| 15/16 | THF301 | THFS301 | 1-3/16 | 1-3/16 | 25/32 | 1-11/32 | 9/16 | 0.25 (0.11) |
| 1 | THF321 | THFS321 | 1-5/16 | 1-1/4 | 13/16 | 1-3/8 | 19/32 | 0.30 (0.14) |



THF161



THFS161

Deep, mm

| mm | 12 | A | B | C | D | E | Weight lbs (kg) |
|----|---------|------|------|------|------|------|-----------------|
| 8 | THSFM8 | 11.4 | 17.7 | 42.0 | 54.0 | 7.1 | 0.08 (0.04) |
| 9 | THSFM9 | 12.8 | 17.2 | 42.0 | 54.0 | 7.1 | 0.08 (0.04) |
| 10 | THSFM10 | 14.3 | 17.2 | 42.0 | 54.0 | 7.9 | 0.10 (0.05) |
| 11 | THSFM11 | 15.7 | 17.2 | 42.0 | 54.0 | 9.7 | 0.11 (0.05) |
| 12 | THSFM12 | 16.5 | 17.2 | 42.0 | 54.0 | 9.9 | 0.12 (0.05) |
| 13 | THSFM13 | 18.0 | 17.2 | 42.0 | 54.0 | 10.7 | 0.12 (0.05) |
| 14 | THSFM14 | 19.6 | 18.6 | 43.3 | 60.3 | 10.7 | 0.16 (0.07) |
| 15 | THSFM15 | 20.3 | 19.4 | 43.3 | 60.3 | 10.7 | 0.17 (0.08) |
| 16 | THSFM16 | 21.1 | 20.0 | 43.3 | 60.3 | 10.7 | 0.18 (0.08) |
| 17 | THSFM17 | 22.7 | 21.8 | 43.6 | 66.7 | 11.2 | 0.22 (0.10) |
| 18 | THSFM18 | 24.3 | 23.2 | 49.0 | 66.7 | 11.2 | 0.30 (0.14) |
| 19 | THSFM19 | 25.1 | 25.1 | 49.0 | 66.7 | 15.5 | 0.27 (0.12) |



THSFM14



THSF161



THSFS161

Deep, inches

| 11 | 6 | 12 | A | B | C | D | E | Weight lbs (kg) |
|--------|---------|----------|--------|--------|---------|-------|-------|-----------------|
| 1/4 | THSF081 | THSFS081 | 15/32 | 11/16 | 1-11/16 | 2-1/8 | 1/4 | 0.06 (0.03) |
| 5/16 | THSF101 | THSFS101 | 15/32 | 11/16 | 1-11/16 | 2-1/8 | 7/32 | 0.80 (0.36) |
| 3/8" | THSF121 | THSFS121 | 9/16 | 11/16 | 1-11/16 | 2-1/8 | 5/16 | 0.10 (0.05) |
| 7/16" | THSF141 | THSFS141 | 5/8 | 11/16 | 1-11/16 | 2-1/8 | 3/8 | 0.10 (0.05) |
| 1/2" | THSF161 | THSFS161 | 23/32 | 11/16 | 1-11/16 | 2-1/8 | 7/16 | 0.10 (0.05) |
| 9/16" | THSF181 | THSFS181 | 25/32 | 23/32 | 1-29/32 | 2-3/8 | 7/17 | 0.15 (0.07) |
| 19/32 | THSF191 | — | 13/16 | 25/32 | 1-29/32 | 2-3/8 | 7/16 | 0.16 (0.07) |
| 5/8" | THSF201 | THSFS201 | 27/32 | 13/16 | 1-29/32 | 2-3/8 | 15/32 | 0.18 (0.08) |
| 11/16" | THSF221 | THSFS221 | 15/16 | 7/8 | 2-3/16 | 2-5/8 | 1/2 | 0.19 (0.09) |
| 3/4" | THSF241 | THSFS241 | 1 | 1 | 2-3/16 | 2-5/8 | 5/8 | 0.25 (0.11) |
| 13/16" | THSF261 | THSFS261 | 1-1/16 | 1 | 2-1/4 | 2-3/4 | 5/8 | 0.30 (0.14) |
| 7/8" | THSF281 | THSFS281 | 1-5/32 | 1-1/8 | 2-1/4 | 2-3/4 | 23/32 | 0.35 (0.16) |
| 15/16 | THSF301 | — | 1-1/4 | 1-3/16 | 2-1/4 | 2-3/4 | 23/32 | 0.41 (0.19) |
| 1 | THSF321 | — | 1-5/16 | 1-1/4 | 2-1/4 | 2-3/4 | 13/16 | 0.46 (0.21) |

Snap-on® T@H sockets, extensions, and adaptors feature a locking hole on all four sides, not just one. T@H ratchets and drive tools feature a locking pin which mates with the side lock hole for positive retention. This reduces the risk of misaligning the socket that typical competitor's sockets with just one side hole create.

Release pin with THPRT – Pin Release Tool for Square Drive Tools

Do not use quick release tools with locking collars or push button release. These tools can be disengaged inadvertently.



Competitor socket



Snap-on® socket



ASME®/ANSI® B107.1-2002



- Wear appropriate eye protection
- Be sure to use a lanyard that has more weight capacity than the tool you are attaching because drop forces are greater than actual tool weight.
- Any tool that weighs more than 5 pounds should be attached to an anchor point such as a work platform or utility bucket rather than the operator.
- Do not use "cheater bars" on handles
- Read safety precautions on pages W1 to W4



Distribué par :

SOCKETS

3/8" Drive

THFUM14A

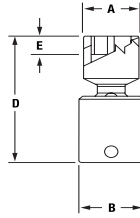

Shallow Universal, mm

| mm | 12 | A | B | D | E | Weight lb (kg) |
|----|----------|------|------|------|------|----------------|
| 10 | THFUM10A | 14.0 | 18.1 | 43.5 | 6.4 | 0.1 (0.05) |
| 12 | THFUM12A | 16.8 | 18.1 | 45.5 | 7.9 | 0.11 (0.05) |
| 13 | THFUM13A | 18.1 | 18.1 | 45.5 | 7.9 | 0.1 (0.05) |
| 14 | THFUM14A | 18.9 | 18.1 | 47.9 | 8.9 | 0.1 (0.05) |
| 15 | THFUM15A | 20.5 | 18.1 | 47.9 | 8.9 | 0.1 (0.05) |
| 16 | THFUM16A | 21.3 | 18.1 | 47.9 | 10.2 | 0.1 (0.05) |
| 17 | THFUM17A | 22.9 | 18.9 | 50.7 | 10.4 | 0.5 (0.23) |

THFAM12E



Hex/Standard, mm

| mm | Hexagon | A | B | Weight, lbs (kg) |
|----|----------|------|---------|------------------|
| 4 | THFAM4E | 52.3 | FAM4E2 | 0.07 (0.03) |
| 5 | THFAM5E | 52.6 | FAM5E2 | 0.07 (0.03) |
| 6 | THFAM6E | 52.6 | FAM6E2 | 0.09 (0.04) |
| 7 | THFAM7E | 52.6 | FAM7E2 | 0.09 (0.04) |
| 8 | THFAM8E | 52.6 | FAM8E2 | 0.103 (0.05) |
| 9 | THFAM9E | 52.6 | FAM9E2 | 0.21 (0.1) |
| 10 | THFAM10E | 52.6 | SAM10E2 | 0.04 (0.02) |
| 11 | THFAM11E | 69.9 | FAM11E2 | 0.15 (0.07) |
| 12 | THFAM12E | 69.9 | FAM12E2 | 0.22 (0.1) |
| 13 | THFAM13E | 69.9 | FAM13E2 | 0.24 (0.11) |
| 14 | THFAM14E | 69.9 | FAM14E2 | 0.31 (0.14) |

THFAB8E



Ball Hex/Standard, inches

| Hex Drive | Ball Hex | Square Drive, inches | Weight lb (kg) |
|-----------|----------|----------------------|----------------|
| 7/32 | THFAB7E | 3/8 | 0.08 (0.04) |
| 1/4 | THFAB8E | 3/8 | 0.09 (0.04) |
| 5/16 | THFAB10E | 3/8 | 0.1 (0.05) |
| 3/8" | THFAB12E | 3/8 | 0.13 (0.06) |
| 7/32" | FAB7E2 | 3/8 | 0.08 (0.04) |
| 1/4" | FAB8E2 | 3/8 | 0.09 (0.04) |
| 5/16" | FAB10E2 | 3/8 | 0.1 (0.05) |
| 3/8" | FAB12E2 | 3/8 | 0.13 (0.06) |

THPP410A



Pipe Plug Socket

| Stock No. | Size, inches | Weight lb (kg) |
|-----------|--------------|----------------|
| THPP410A | 5/16 | 0.05 (0.02) |

THFU16B



Shallow Universal, inches

| Hex Drive | 12 | A | B | D | E | Weight lb (kg) |
|-----------|---------|--------|-------|---------|-------|----------------|
| 5/16 | THFU10B | 15/32 | 11/16 | 1 5/8 | 1/4 | 0.4 (0.02) |
| 3/8" | THFU12B | 17/32 | 11/16 | 1 5/8 | 1/4 | 0.1 (0.05) |
| 7/16" | THFU14B | 5/8 | 11/16 | 1 5/8 | 9/32 | 0.09 (0.04) |
| 1/2" | THFU16B | 23/32 | 11/16 | 1 11/16 | 9/32 | 0.1 (0.05) |
| 9/16" | THFU18B | 25/32 | 11/16 | 1 23/32 | 11/32 | 0.1 (0.05) |
| 5/8" | THFU20B | 27/32 | 11/16 | 1 25/32 | 3/8 | 0.11 (0.05) |
| 11/16" | THFU22B | 15/16 | 3/4 | 2 | 3/8 | 0.15 (0.07) |
| 3/4" | THFU24B | 1 | 3/4 | 2 1/16 | 7/16 | 0.16 (0.07) |
| 13/16" | THFU26B | 1 3/32 | 3/4 | 2 3/32 | 15/32 | 0.15 (0.07) |
| 7/8" | THFU28B | 1 5/32 | 3/4 | 2 3/32 | 1/2 | 0.15 (0.07) |
| 15/16 | THFU30A | 1 1/4 | 3/4 | 2 9/32 | 9/16 | 0.21 (0.1) |
| 1 | THFU32A | 1 5/16 | 3/4 | 2 9/32 | 9/16 | 0.231 (0.1) |

THFA8E



Hex/Standard, inches

| Hex Drive | Hexagon | A | B | Weight |
|-----------|----------|--------|----------|--------------|
| 1/8 | THFA4E | 2 1/16 | TMA4E2 | 0.07 (0.03) |
| 9/64 | THFA4.5E | 2 1/16 | TMA4.5E2 | 0.05 (0.02) |
| 5/32 | THFA5E | 2 1/16 | FA5E2 | 0.07 (0.03) |
| 3/16 | THFA6E | 2 1/16 | FA6E2 | 0.07 (0.03) |
| 7/32 | THFA7E | 2 1/16 | FA7E2 | 0.08 (0.04) |
| 1/4 | THFA8E | 2 1/16 | FA8E2 | 0.09 (0.04) |
| 5/16 | THFA10E | 2 1/16 | FA10E2 | 0.1 (0.05) |
| 3/8" | THFA12E | 2 1/16 | FA12E2 | 0.125 (0.06) |

THFA8LE



Hex/Extra Long, inches

| Hex Drive | Hexagon | A | Fits These Cap Screws | Fits These Set Screws | B | Weight, lbs (kg) |
|-----------|----------|--------|-----------------------|-----------------------|---------|------------------|
| 5/32 | THFA5LE | 6 1/16 | #10 | 5/16" | FA5LE2 | 0.11 (0.05) |
| 3/16 | THFA6LE | 6 1/8 | 1/4" | 3/8" | FA6LE2 | 0.1 (0.05) |
| 7/32 | THFA7LE | 6 1/8 | — | 7/16" | FA7LE2 | 0.13 (0.06) |
| 1/4 | THFA8LE | 6 1/8 | 5/16" | 1/2" | FA8LE2 | 0.15 (0.07) |
| 5/16 | THFA10LE | 6 1/16 | 3/8" | 5/8" | FA10LE2 | 0.19 (0.09) |
| 3/8" | THFA12LE | 6 1/16 | 1/4" | 3/4" | FA12LE2 | 0.25 (0.11) |

3/8" Drive

Flank Drive® Flare Nut, inches, 6-Point (chrome)

|  | | A | B | C | D | E | Maximum Recommended Working Torque, inches -lb | Weight, lbs (kg) |
|---|-----------|--------|-------|-------|---------|------|--|------------------|
| 3/8" | THFRH120S | 13/32 | 1/4 | 9/16 | 1-11/32 | 3/8 | 150 | 0.07 (0.03) |
| 7/16" | THFRH140S | 29/32 | 5/16 | 9/16 | 1-13/32 | 3/8 | 200 | 0.07 (0.03) |
| 1/2" | THFRH160S | 1 | 11/32 | 9/16 | 1-7/16 | 3/8 | 250 | 0.08 (0.04) |
| 9/16" | THFRH180S | 1-1/8 | 3/8 | 3/4 | 1-5/8 | 7/16 | 300 | 0.12 (0.05) |
| 5/8" | THFRH200S | 1-1/8 | 7/16 | 3/4 | 1-5/8 | 7/16 | 375 | 0.10 (0.05) |
| 11/16" | THFRH220S | 1-5/16 | 1/2 | 13/16 | 1-25/32 | 1/2 | 450 | 0.15 (0.07) |
| 3/4" | THFRH240S | 1-5/16 | 9/16 | 13/16 | 1-25/32 | 1/2 | 525 | 0.13 (0.06) |

Open End, inches

|  | | A | C | E | F | D | Maximum Recommended Working Torque, inches -lb | Weight lb (kg) |
|---|--------|---------|---------|-------|-------|---------|--|----------------|
| 3/8 | THFC12 | 7/8 | 23/32 | 7/32 | 33/64 | 1 19/64 | 75 | 0.07 (0.03) |
| 7/16 | THFC14 | 7/8 | 41/64 | 7/32 | 33/64 | 1 17/64 | 250 | 0.06 (0.03) |
| 1/2 | THFC16 | 1 1/32 | 51/64 | 7/32 | 33/64 | 1 29/64 | 300 | 0.08 (0.04) |
| 9/16 | THFC18 | 1 1/4 | 59/64 | 7/32 | 33/64 | 1 5/8 | 400 | 0.08 (0.04) |
| 5/8 | THFC20 | 1 1/4 | 55/64 | 7/32 | 33/64 | 1 19/32 | 500 | 0.08 (0.04) |
| 11/16 | THFC22 | 1 9/16 | 1 3/32 | 7/32 | 33/64 | 1 59/64 | 650 | 0.14 (0.06) |
| 3/4 | THFC24 | 1 9/16 | 1 1/32 | 7/32 | 33/64 | 1 57/64 | 850 | 1.00 (0.45) |
| 13/16 | THFC26 | 1 23/32 | 1 3/32 | 9/32 | 19/32 | 2 | 1050 | 0.19 (0.09) |
| 7/8 | THFC28 | 1 23/32 | 1 1/32 | 9/32 | 19/32 | 1 31/32 | 1250 | 0.18 (0.08) |
| 15/16 | THFC30 | 2 | 1 5/32 | 11/32 | 21/32 | 2 1/8 | 1400 | 0.26 (0.12) |
| 1 | THFC32 | 2 | 1 5/64 | 11/32 | 21/32 | 2 3/32 | 1600 | 0.24 (0.11) |
| 1-1/16 | THFC34 | 1-23/32 | 1-3/64 | 3/8 | 39/64 | 1-15/32 | 1650 | 0.24 (0.11) |
| 1-1/8 | THFC36 | 1-29/32 | 1-5/32 | 3/8 | 39/64 | 2-1/16 | 1700 | 0.21 (0.1) |
| 1-3/16 | THFC38 | 1-29/32 | 1-13/64 | 3/8 | 39/64 | 2-1/16 | 1750 | 0.21 (0.1) |
| 1-1/4 | THFC40 | 2-5/32 | 1-15/64 | 3/8 | 41/64 | 2-7/32 | 1750 | 0.26 (0.12) |
| 1-5/16 | THFC42 | 2-5/32 | 1-17/64 | 3/8 | 41/64 | 2-7/32 | 1750 | 0.26 (0.12) |
| 1-3/8 | THFC44 | 2-3/8 | 1-19/64 | 3/8 | 41/64 | 2-3/8 | 1800 | 0.30 (0.14) |
| 1-7/16 | THFC46 | 2-3/8 | 1-11/32 | 3/8 | 41/64 | 2-3/8 | 1800 | 0.29 (0.13) |
| 1-1/2 | THFC48 | 2-17/32 | 1-3/8 | 3/8 | 41/64 | 2-1/2 | 1800 | 0.33 (0.15) |
| 1-9/16 | THFC50 | 2-17/32 | 1-13/32 | 3/8 | 41/64 | 2-1/2 | 1800 | 0.32 (0.15) |
| 1-5/8 | THFC52 | 2-21/32 | 1-29/64 | 3/8 | 41/64 | 2-19/32 | 1800 | 0.31 (0.14) |
| 1-11/16 | THFC54 | 2-21/32 | 1-31/64 | 3/8 | 41/64 | 2-19/32 | 1800 | 0.31 (0.14) |
| 1-3/4 | THFC56 | 2-7/8 | 1-33/64 | 3/8 | 41/64 | 2-3/4 | 1800 | 0.36 (0.16) |
| 1-13/16 | THFC58 | 2-7/8 | 1-35/64 | 3/8 | 41/64 | 2-3/4 | 1800 | 0.34 (0.15) |
| 1-7/8 | THFC60 | 3-5/32 | 1-19/32 | 3/8 | 41/64 | 2-55/64 | 1800 | 0.43 (0.2) |
| 1-15/16 | THFC62 | 3-5/32 | 1-5/8 | 3/8 | 41/64 | 2-55/64 | 1040 | 0.43 (0.2) |
| 2 | THFC64 | 3-13/32 | 1-23/32 | 1/2 | 45/64 | 3-1/8 | 1800 | 0.66 (0.3) |
| 2-1/16 | THFC66 | 3-13/32 | 1-3/4 | 1/2 | 45/64 | 3-1/8 | 1800 | 0.66 (0.3) |
| 2-1/8 | THFC68 | 3-19/32 | 1-25/32 | 1/2 | 45/64 | 3-1/4 | 1800 | 0.74 (0.34) |
| 2-3/16 | THFC70 | 3-19/32 | 1-53/64 | 1/2 | 45/64 | 3-1/4 | 1275 | 0.72 (0.33) |
| 2-1/4 | THFC72 | 3-27/32 | 1-15/16 | 1/2 | 45/64 | 3-1/2 | 1800 | 0.86 (0.39) |
| 2-5/16 | THFC74 | 3-27/32 | 1-15/16 | 1/2 | 45/64 | 3-1/2 | 1800 | 0.84 (0.38) |
| 2-3/8 | THFC76 | 4-3/32 | 2-1/16 | 1/2 | 45/64 | 3-3/4 | 1800 | 0.99 (0.45) |
| 2-7/16 | THFC78 | 4-3/32 | 2-1/4 | 1/2 | 45/64 | 3-3/4 | 1800 | 1.00 (0.45) |
| 2-1/2 | THFC80 | 4-9/32 | 2-11/64 | 1/2 | 45/64 | 3-57/64 | 1800 | 1.04 (0.47) |
| 2-9/16 | THFC82 | 4-9/32 | 2-11/64 | 1/2 | 45/64 | 3-57/64 | 1800 | 1.04 (0.47) |
| 2-5/8 | THFC84 | 4-17/32 | 2-21/64 | 1/2 | 45/64 | 4-1/8 | 1800 | 1.14 (0.52) |
| 2-11/16 | THFC86 | 4-17/32 | 2-3/8 | 1/2 | 45/64 | 4-1/8 | 1800 | 1.12 (0.51) |
| 2-3/4 | THFC88 | 4-23/32 | 2-7/16 | 1/2 | 45/64 | 4-19/64 | 1900 | 1.27 (0.58) |
| 2-13/16 | THFC90 | 4-23/32 | 2-17/32 | 1/2 | 45/64 | 4-19/64 | 2075 | 1.33 (0.6) |
| 2-7/8 | THFC92 | 5-3/32 | 2-41/64 | 1/2 | 45/64 | 4-43/64 | 2075 | 1.54 (0.7) |
| 2-15/16 | THFC94 | 5-3/32 | 2-43/64 | 1/2 | 45/64 | 4-5/8 | 2200 | 1.51 (0.68) |
| 3 | THFC96 | 5-3/32 | 2-23/32 | 1/2 | 45/64 | 4-5/8 | 2200 | 1.47 (0.67) |

3/8" Drive Flank Drive® Flare Nut-Deep, inches, 12-Point (chrome)

|  | | A | B | C | E | Maximum Recommended Working Torque, inches -lb | Weight lb (kg) |
|---|------------|---------|-------|--------|-------|--|----------------|
| 5/8" | THAN850810 | 15/16 | 1/2 | 23/32 | 23/32 | 250 | 0.07 (0.03) |
| 11/16" | THAN850811 | 1 1/32 | 17/32 | 25/32 | 23/32 | 310 | 0.08 (0.04) |
| 3/4" | THAN850812 | 1 1/8 | 9/16 | 13/16 | 3/4 | 450 | 0.11 (0.05) |
| 13/16" | THAN850813 | 1 7/32 | 5/8 | 7/8 | 3/4 | 450 | 0.10 (0.05) |
| 7/8" | THAN850814 | 1 5/16 | 25/32 | 15/16 | 25/32 | 625 | 0.15 (0.07) |
| 15/16" | THAN850815 | 1 3/8 | 3/4 | 31/32 | 25/32 | 625 | 0.15 (0.07) |
| 1 | THAN850816 | 1 7/16 | 3/4 | 1 | 13/16 | 625 | 0.15 (0.07) |
| 1-1/16" | THAN850817 | 1 17/32 | 25/32 | 1 1/32 | 13/16 | 625 | 0.15 (0.07) |

ASME®/ANSI® B107.100



- Wear appropriate eye protection
- Be sure to use a lanyard that has more weight capacity than the tool you are attaching because drop forces are greater than actual tool weight.
- Any tool that weighs more than 5 pounds should be attached to an anchor point such as a work platform or utility bucket rather than the operator.
- Read safety precautions on pages W1 to W4



THFRH160S

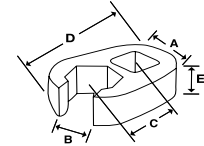

THFC12

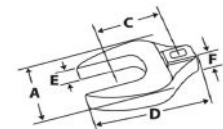

THAN850812

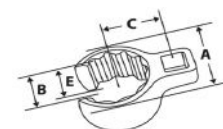

RATCHETS AND ACCESSORIES

1/2" Drive



1/2" Drive Tools@Height™ Ratchets & Accessories

| Stock No. | Description | Overall Length, inches | Repair Kit | Weight lb (kg) |
|--------------|--|------------------------|-------------|----------------|
| THS80A | 1/2" Drive Standard Handle Ratchet | 10-5/16 | THRKRS80ALB | 1.60 (0.73) |
| THSL80A | Long Handle Ratchet | 15 | THRKRS80ALB | 1.93 (0.88) |
| THSA936A | Scaffold Ratchet | 10 5/16 | — | 2.12 (0.96) |
| JHWBS-63B | Scaffold Ratchet | 14 | — | 2.74 (1.24) |
| JHWBS-62 | Scaffold Ratchet with Hammer Only | 11 | — | 2.55 (1.16) |
| THS77A | Ratchet Adaptor | 3 | — | 0.90 (0.41) |
| THGSP936 | Spud Ratchet | 15-5/8 | — | 2.44 (1.11) |
| THRKRS80A80L | Drive gear and screws to retrofit existing 80 tooth ratchet models | — | — | — |
| THPRT | Pin Release Tool | — | — | — |

1/2" Drive Handles

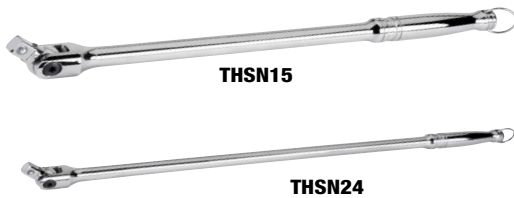

| Stock No. | Description | Drive Size, inches | Overall Length, inches | Weight, lbs (kg) |
|-----------|--|--------------------|------------------------|------------------|
| THSN15 | 1/2" Drive 15" Standard Handle Breaker Bar | 1/2 | 15 | 1.70 (0.77) |
| THSN18 | Breaker Bar | 1/2 | 18 | 3.00 (1.36) |
| THSN24 | Breaker Bar | 1/2 | 24 | 2.40 (1.09) |



1/2" Drive Extensions & Accessories

| Stock No. | Description | Overall Length, inches | Weight lb (kg) |
|-----------|---|------------------------|----------------|
| THSX2 | Extension | 2-1/8 | 0.25 (0.11) |
| THSXX3 | Knurled Extension | 3-1/2 | 0.40 (0.18) |
| THSXX5 | 1/2" Drive 5" Extension | 5 | 0.53 (0.24) |
| THSXX8 | Knurled Extension | 8 | 0.74 (0.34) |
| THSXX11 | 1/2" Drive 11" Extension | 11 | 1.04 (0.47) |
| THSX15 | Extension | 15 | 1.00 (0.45) |
| THS8 | 1/2" Drive 2-11/16" Friction Ball Universal Joint | 2-11/16 | 0.29 (0.13) |
| THGLA12B | 1/2" Female x 3/4" Male Adaptor | 1-7/16 | 0.36 (0.16) |
| THGSAF1F | 1/2" Drive Square Drive Adaptor | 1 3/16 | 0.20 (0.09) |
| THGLAS1F | 3/4" Female x 1/2" Male Adaptor | 2-7/16 | 0.50 (0.23) |
| THGLAS1F2 | Replacement Bit / THGLAS1F | — | — |

1/2" Drive

THSWM191

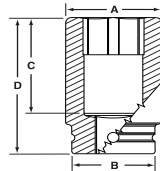

Shallow, mm

| mm | 12 | A | B | C | D | Weight lb (kg) |
|----|-----------|------|------|-------|------|----------------|
| 10 | THSWM101A | 15.0 | 23.2 | 22.22 | 38.1 | 0.13 (0.06) |
| 11 | THSWM111A | 16.6 | 23.2 | 22.22 | 38.1 | 0.133 (0.06) |
| 12 | THSWM121A | 18.2 | 23.2 | 22.22 | 38.1 | 0.14 (0.06) |
| 13 | THSWM131A | 19.0 | 23.2 | 22.22 | 38.1 | 0.14 (0.06) |
| 14 | THSWM141A | 20.6 | 23.2 | 22.22 | 38.1 | 0.142 (0.06) |
| 15 | THSWM151A | 22.0 | 22.2 | 22.22 | 38.1 | 0.15 (0.07) |
| 16 | THSWM161 | 23.8 | 22.2 | 22.22 | 38.1 | 0.14 (0.06) |
| 17 | THSWM171 | 24.6 | 23.2 | 22.22 | 38.1 | 0.17 (0.08) |
| 18 | THSWM181 | 25.4 | 23.8 | 21.4 | 38.1 | 0.15 (0.07) |
| 19 | THSWM191 | 26.3 | 24.8 | 21.3 | 38.1 | 0.17 (0.08) |
| 20 | THSWM201 | 26.7 | 26.1 | 21.2 | 38.1 | 0.18 (0.08) |
| 21 | THSWM211 | 28.3 | 27.5 | 21.1 | 38.1 | 0.21 (0.01) |
| 22 | THSWM221 | 29.9 | 28.6 | 20.9 | 38.1 | 0.23 (0.01) |
| 23 | THSWM231 | 31.2 | 29.9 | 20.8 | 38.1 | 0.265 (0.012) |
| 24 | THSWM241 | 32.5 | 30.9 | 22.2 | 38.8 | 0.28 (0.013) |
| 25 | THSWM251 | 33.3 | 31.7 | 22.2 | 38.8 | 0.4 (0.18) |
| 26 | THSWM261 | 34.9 | 33.3 | 23.8 | 41.2 | 0.55 (0.25) |
| 27 | THSWM271 | 36.5 | 34.9 | 25.4 | 42.8 | 0.6 (0.27) |
| 28 | THSWM281 | 38.1 | 36.5 | 26.9 | 44.4 | 0.30 (0.14) |
| 29 | THSWM291 | 39.3 | 38.0 | 26.1 | 44.5 | 0.35 (0.16) |
| 30 | THSWM301 | 41.0 | 39.6 | 26.1 | 44.5 | 0.4 (0.18) |
| 31 | THSWM311 | 42.5 | 41.2 | 29.1 | 47.6 | 0.52 (0.24) |
| 32 | THSWM321 | 42.5 | 41.2 | 28.9 | 47.6 | 0.64 (0.29) |

THSW241



Shallow, inches

| TI | 12 | A | B | C | D | E | Weight, lbs (kg) |
|---------|----------|---------|---------|---------|---------|--------|------------------|
| 3/8" | THSW121A | 19/32 | 29/32 | 7/8 | 1-1/2 | 5/16 | 0.13 (0.06) |
| 7/16" | THSW141A | 11/16 | 29/32 | 7/8 | 1-1/2 | 11/32 | 0.13 (0.06) |
| 1/2" | THSW161A | 3/4 | 29/32 | 7/8 | 1-1/2 | 13/32 | 0.14 (0.06) |
| 9/16" | THSW181A | 13/16 | 29/32 | 7/8 | 1-1/2 | 13/32 | 0.14 (0.06) |
| 5/8" | THSW201 | 15/16 | 7/8 | 7/8 | 1-1/2 | 15/32 | 0.14 (0.06) |
| 11/16" | THSW221 | 31/32 | 29/32 | 7/8 | 1-1/2 | 1/2 | 0.15 (0.07) |
| 3/4" | THSW241 | 1-31/32 | 31/32 | 7/8 | 1-1/2 | 9/16 | 0.17 (0.08) |
| 13/16" | THSW261 | 1-1/8 | 1-1/16 | 7/8 | 1-1/2 | 9/16 | 0.20 (0.09) |
| 7/8" | THSW281 | 1-23/16 | 1-1/8 | 7/8 | 1-1/2 | 25/32 | 0.20 (0.09) |
| 15/16" | THSW301 | 1-9/32 | 1-7/32 | 27/32 | 1-17/32 | 3/4 | 0.28 (0.10) |
| 1 | THSW321 | 1-11/32 | 1-9/32 | 7/8 | 1-9/16 | 3/4 | 0.30 (0.14) |
| 1-1/16" | THSW341 | 1-7/16 | 1-3/8 | 1-31/32 | 1-11/16 | 3/4 | 1.8 (0.82) |
| 1-1/8" | THSW361 | 1-1/2 | 1-7/16 | 1-31/32 | 1-3/4 | 1-3/16 | 0.44 (0.20) |
| 1-3/16" | THSW381 | 1-5/8 | 1-9/16 | 1-1/8 | 1-3/4 | 3/4 | 0.53 (0.27) |
| 1-1/4" | THSW401 | 1-11/16 | 1-5/8 | 1-1/4 | 1-7/8 | 3/4 | 0.60 (0.27) |
| 1-5/16" | THSW421 | 1-3/4 | 1-11/16 | 1-1/4 | 1-7/8 | 1 | 0.65 (0.29) |
| 1-1/2" | THSW481 | 2 | 1-15/16 | 1-5/8 | 2-1/2 | 1 | 1 (0.45) |

THSM19



Deep 1/2" Drive, mm

| TI | 6 | 12 | A | B | C | D | E | Weight, lb (kg) |
|----|---------|---------|------|------|------|------|------|-----------------|
| 10 | — | THSM10A | 15.0 | 23.2 | 66.7 | 82.6 | 7.9 | 0.2 (0.09) |
| 11 | — | THSM11A | 16.6 | 23.2 | 66.7 | 82.6 | 8.7 | 0.23 (0.1) |
| 12 | — | THSM12B | 18.2 | 23.2 | 66.7 | 82.6 | 9.5 | 0.25 (0.11) |
| 13 | — | THSM13A | 19.0 | 23.2 | 66.7 | 82.6 | 10.3 | 0.25 (0.11) |
| 14 | — | THSM14A | 20.6 | 23.2 | 66.7 | 82.6 | 10.3 | 0.31 (0.14) |
| 15 | — | THSM15A | 22.2 | 23.2 | 66.7 | 82.6 | 10.3 | 0.35 (0.16) |
| 16 | — | THSM16 | 23.8 | 22.2 | 51.0 | 82.6 | 11.9 | 0.3 (0.14) |
| 17 | — | THSM17 | 24.6 | 22.2 | 51.0 | 82.6 | 12.7 | 0.35 (0.16) |
| 18 | — | THSM18 | 25.4 | 23.2 | 51.0 | 82.6 | 14.3 | 0.355 (0.16) |
| 19 | — | THSM19 | 26.3 | 23.8 | 52.5 | 82.6 | 14.2 | 0.4 (0.18) |
| 20 | — | THSM20 | 26.7 | 24.6 | 58.5 | 82.6 | 14.0 | 0.4 (0.18) |
| 21 | — | THSM21 | 28.3 | 27.5 | 58.5 | 82.6 | 14.0 | 0.45 (0.2) |
| 22 | THTSM22 | THSM22 | 29.9 | 28.6 | 58.5 | 82.6 | 14.2 | 0.5 (0.23) |
| 23 | THTSM23 | THSM23 | 31.2 | 29.9 | 58.0 | 82.6 | 14.5 | 0.55 (0.25) |
| 24 | THTSM24 | THSM24 | 32.5 | 30.9 | 50.0 | 82.6 | 15.8 | 0.6 (0.27) |
| 25 | THTSM25 | THSM25 | 33.3 | 31.7 | 50.0 | 82.6 | 15.8 | 0.51 (0.23) |
| 26 | THTSM26 | THSM26 | 34.9 | 33.3 | 50.0 | 82.6 | 15.8 | 0.60 (0.27) |
| 27 | THTSM27 | THSM27 | 36.2 | 34.9 | 50.0 | 82.6 | 17.5 | 0.60 (0.27) |
| 28 | THTSM28 | THSM28 | 37.8 | 36.5 | 50.0 | 82.6 | 17.5 | 0.62 (0.28) |
| 29 | THTSM29 | THSM29 | 39.3 | 38.0 | 64.3 | 82.6 | 17.8 | 0.69 (0.31) |
| 30 | THTSM30 | THSM30 | 41 | 39.6 | 64.0 | 82.6 | 18.5 | 0.77 (0.35) |
| 31 | THTSM31 | THSM31 | 42.5 | 41.2 | 64.0 | 82.6 | 19.1 | 0.85 (0.39) |
| 32 | THTSM32 | THSM32 | 42.5 | 41.2 | 63.8 | 82.6 | 19.8 | 0.97 (0.44) |

THS241



Deep, inches

| TI | 12 | A | B | C | Weight lb (kg) |
|---------|---------|---------|---------|---------|----------------|
| 3/8" | THS121A | 19/32 | 29/32 | 2 5/8 | 0.2 (0.09) |
| 7/16" | THS141A | 3/4 | 29/32 | 2 5/8 | 0.25 (0.11) |
| 1/2" | THS161A | 3/4 | 29/32 | 2 5/8 | 0.26 (0.12) |
| 9/16" | THS181A | 13/16 | 29/32 | 2 5/8 | 0.3 (0.14) |
| 5/8" | THS201 | 15/16 | 7/8 | 1 31/32 | 0.29 (0.13) |
| 11/16" | THS221 | 31/32 | 29/32 | 1 31/32 | 0.35 (0.16) |
| 3/4" | THS241 | 1 1/32 | 31/32 | 2 5/8 | 0.4 (0.18) |
| 13/16" | THS261 | 1 1/8 | 1 1/16 | 2 5/8 | 0.45 (0.2) |
| 7/8" | THS281 | 1 3/16 | 1 1/8 | 2 5/8 | 0.501 (0.23) |
| 15/16" | THS301 | 1 9/32 | 1 7/32 | 1 31/32 | 0.6 (0.27) |
| 1 | THS321 | 1 11/32 | 1 9/32 | 1 31/32 | 0.65 (0.29) |
| 1-1/16" | THS341 | 1 7/16 | 1 3/8 | 1 31/32 | 0.75 (0.34) |
| 1-1/8" | THS361 | 1 1/2 | 1 7/16 | 1 31/32 | 0.85 (0.39) |
| 1-3/16" | THS381 | 1-5/8 | 1-9/16 | 2-5/8 | 1.02 (0.46) |
| 1-1/4" | THS401 | 1-11/16 | 1-5/8 | 2-5/8 | 1.09 (0.49) |
| 1-5/16" | THS421 | 1-3/4 | 1-11/16 | 2-9/16 | 1.14 (0.52) |
| 1-3/8" | THS441 | 1-13/16 | 1-3/4 | 2-9/16 | 1.22 (0.55) |
| 1 7/16" | THS461 | 1 15/16 | 1 7/8 | 2 9/16 | 1.31 (0.59) |
| 1 1/2" | THS481 | 2 | 1 15/16 | 2 9/16 | 1.39 (0.63) |

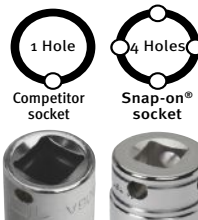

Snap-on® T@H sockets, extensions, and adaptors feature a locking hole on all four sides, not just one. T@H ratchets and drive tools feature a locking pin which mates with the side lock hole for positive retention. This reduces the risk of misaligning the socket that typical competitor's sockets with just one side hole create.

Release pin with THPRT – Pin Release Tool for Square Drive Tools

Do not use quick release tools with locking collars or push button release. These tools can be disengaged inadvertently.



THS241



- Wear appropriate eye protection
- Be sure to use a lanyard that has more weight capacity than the tool you are attaching because drop forces are greater than actual tool weight.
- Any tool that weighs more than 5 pounds should be attached to an anchor point such as a work platform or utility bucket rather than the operator.
- Do not use "cheater bars" on handles
- Read safety precautions on pages W1 to W4



SOCKETS

1/2" Drive



THSU24

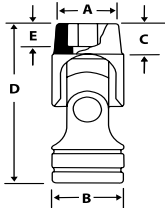

Universal, inches

| Size | Part # | A | B | D | E | Weight, lbs (kg) |
|--------|--------|--------|--------|---------|-------|------------------|
| 9/16" | THSU18 | 27/32 | 15/16 | 2-7/16 | 11/32 | .25 (0.11) |
| 5/8" | THSU20 | 15/16 | 15/16 | 2-15/32 | 3/8 | .25 (.11) |
| 11/16" | THSU22 | 1-1/16 | 1-1/16 | 2-9/16 | 7/16 | .35 (.16) |
| 3/4" | THSU24 | 1-1/8 | 1-1/8 | 2-7/8 | 1/2 | .43 (.2) |
| 13/16" | THSU26 | 1-3/16 | 1-1/8 | 2-15/16 | 9/16 | .45 (.21) |
| 7/8" | THSU28 | 1-1/4 | 1-1/8 | 2-15/16 | 9/16 | .46 (.21) |
| 15/16" | THSU30 | 1-5/16 | 1-1/8 | 3 | 9/16 | .49 (.22) |

ASME®/ANSI® B107.1-1993



THSAM12E

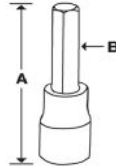

THSA16E

Hex/Standard, mm

| mm | Part # | A | B | Weight, lbs (kg) |
|----|----------|-------|---------|------------------|
| 6 | THSAM6E | 60.5 | FAM6E2 | 0.18 (0.08) |
| 8 | THSAM8E | 62 | FAM8E2 | 0.20 (0.09) |
| 10 | THSAM10E | 62.8 | SAM10E2 | 0.23 (0.1) |
| 12 | THSAM12E | 81 | SAM12E2 | 0.32 (0.15) |
| 14 | THSAM14E | 81 | SAM14E2 | 0.45 (0.2) |
| 17 | THSAM17E | 93.7 | SAM17E2 | 0.73 (0.33) |
| 19 | THSAM19E | 103.1 | SAM19E2 | 1.05 (0.48) |

Hex/Standard, inches

| Size | Part # | A | B | Weight, lbs (kg) |
|-------|---------|---------|----------|------------------|
| 5/16" | THSA10E | 2-3/8 | FA10E2 | 21 (0.1) |
| 3/8" | THSA12E | 2-1/2 | SA12E2 | 0.25 (0.11) |
| 7/16" | THSA14E | 2-7/8 | SA14E2 | 0.30 (0.14) |
| 1/2" | THSA16E | 3-1/16 | SA16E2 | 0.35 (0.16) |
| 9/16" | THSA18E | 3-3/16 | SA18E2 | 0.45 (0.2) |
| 5/8" | THSA20E | 3-11/32 | LAW120E2 | 0.68 (0.31) |
| 3/4" | THSA24E | 4-1/16 | LAW124E2 | 1.04 (0.47) |

Open End, inches



THSC48

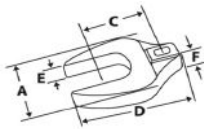

| Size | Part # | A | C | E | F | Maximum Recommended Working Torque, in-lb | Weight, lbs (kg) |
|----------|--------|---------|---------|-------|-----|---|------------------|
| 1-1/16" | THSC34 | 2-3/32 | 1-3/4 | 3/8 | 5/8 | 2,000 | 0.30 (0.14) |
| 1-1/8" | THSC36 | 2-7/32 | 1-3/4 | 3/8 | 5/8 | 2,100 | 0.37 (0.17) |
| 1-3/16" | THSC38 | 2-11/32 | 1-3/4 | 13/32 | 5/8 | 2,200 | 0.42 (0.19) |
| 1-1/4" | THSC40 | 2-15/32 | 2 | 13/32 | 5/8 | 2,300 | 0.42 (0.19) |
| 1-5/16" | THSC42 | 2-19/32 | 2 | 7/16 | 5/8 | 2,400 | 0.46 (0.21) |
| 1-3/8" | THSC44 | 2-23/32 | 2 | 7/16 | 5/8 | 2,500 | 0.54 (0.24) |
| 1-7/16" | THSC46 | 2-27/32 | 2 | 7/16 | 5/8 | 2,600 | 0.59 (0.27) |
| 1-1/2" | THSC48 | 2-31/32 | 2 | 15/32 | 5/8 | 2,900 | .64 (0.29) |
| 1-5/8" | THSC52 | 3-7/32 | 1-31/32 | 1/2 | 5/8 | 3,400 | 0.70 (0.32) |
| 1-11/16" | THSC54 | 3-11/32 | 2-3/16 | 1/2 | 5/8 | 3,700 | 1.00 (0.45) |
| 1-3/4" | THSC56 | 3-15/32 | 2-3/16 | 17/32 | 5/8 | 3,900 | 0.85 (0.39) |
| 1-13/16" | THSC58 | 3-19/32 | 2-3/16 | 17/32 | 5/8 | 4,100 | 0.86 (0.39) |
| 1-7/8" | THSC60 | 3-23/32 | 2-3/16 | 9/16 | 5/8 | 4,300 | 1.00 (0.45) |
| 2" | THSC64 | 3-31/32 | 2-31/32 | 9/16 | 5/8 | 5,000 | 1.15 (0.52) |

Flare Nut-Deep, inches, 12-Point



THAN850824

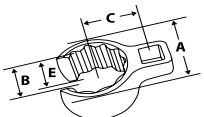

| Size | Part # | A | B | C | E | Maximum Recommended Working Torque, in-lb | Weight, lbs (kg) |
|----------|------------|---------|---------|---------|--------|---|------------------|
| 1-1/8" | THAN850818 | 1-5/8 | 27/32 | 1-5/32 | 7/8 | 825 | 0.20 (0.09) |
| 1-3/16" | THAN850819 | 1-11/16 | 29/32 | 1-3/16 | 7/8 | 825 | 0.24 (0.11) |
| 1-1/4" | THAN850820 | 1-25/32 | 15/16 | 1-7/32 | 7/8 | 825 | 0.25 (0.11) |
| 1-5/16" | THAN850821 | 1-27/32 | 31/32 | 1-1/4 | 7/8 | 900 | 0.25 (0.11) |
| 1-3/8" | THAN850822 | 1-15/16 | 1-1/16 | 1-5/16 | 15/16 | 900 | 0.30 (0.14) |
| 1-7/16" | THAN850823 | 2 | 1-1/16 | 1-11/32 | 15/16 | 900 | 0.30 (0.14) |
| 1-1/2" | THAN850824 | 2-3/32 | 1-1/8 | 1-3/8 | 15/16 | 900 | 0.30 (0.14) |
| 1-9/16" | THAN850825 | 2-5/32 | 1-5/32 | 1-13/32 | 15/16 | 900 | 0.33 (0.15) |
| 1-5/8" | THAN850826 | 2-7/32 | 1-7/32 | 1-7/16 | 15/16 | 1,100 | 0.35 (0.16) |
| 1-11/16" | THAN850827 | 2-5/16 | 1-5/16 | 1-1/2 | 1-1/32 | 1,100 | 0.40 (0.18) |
| 1-3/4" | THAN850828 | 2-3/8 | 1/5/16 | 1-9/16 | 1-1/32 | 1,150 | 0.45 (0.2) |
| 1-13/16" | THAN850829 | 2-15/32 | 1-11/32 | 1-19/32 | 1-1/32 | 1,200 | 0.44 (0.2) |
| 1-7/8" | THAN850830 | 2-9/16 | 1-3/8 | 1-21/32 | 1-1/16 | 1,200 | 0.45 (0.2) |
| 1-15/16" | THAN850831 | 2-5/8 | 1-7/16 | 1-11/16 | 1-1/16 | 1,200 | 0.50 (0.23) |
| 2" | THAN850832 | 2-23/32 | 1-9/16 | 1-23/32 | 1-1/16 | 1,400 | 0.87 (0.39) |

ASME®/ANSI® B107.100

3/4" Drive



THLDH382

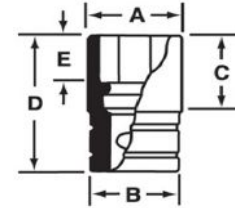

3/4" Drive Ratchet and Drive Tools

| Stock No. | Description | Overall Length inches | Weight lbs (kg) |
|-----------|--|-----------------------|-----------------|
| THL872H | Sliding T-Handle Head with 19" Handle | 19-1/4 | 3.68 (1.67) |
| THL872RJ | Sealed Ratchet with Knurled 19" Handle | 19-1/4 | 4.15 (1.88) |
| THL872RM | Sealed Ratchet with Knurled 36" Handle | 26 | 7.16 (3.25) |
| THL32 | Extension with Locking Button | 3 | 0.80 (0.36) |
| THL42 | Extension with Locking Button | 5 | 1.17 (0.53) |
| THL62 | Extension with Locking Button | 8 | 1.71 (0.78) |
| THL122 | Extension with Locking Button | 16 | 3.31 (1.5) |

ASME®/ANSI® B107.1-1993



THLDHM302

3/4" Drive, Shallow, SAE®

| 11 | 12 | A | B | C | D | E | Weight, lb (kg) |
|---------|-----------|---------|--------|---------|--------|--------|-----------------|
| 3/4 | THLDH242 | 1-1/8 | 1-7/16 | 1-1/4 | 2 | 16/32 | 0.48 (0.22) |
| 13/16 | THLDH262 | 1-7/32 | 1-7/16 | 1-1/4 | 2 | 11/16 | 0.50 (0.23) |
| 7/8 | THLDH282 | 1-5/16 | 1-7/16 | 1-1/4 | 2 | 11/16 | 0.52 (0.24) |
| 15/16 | THLDH302 | 1-3/8 | 1-7/16 | 1-1/4 | 2 | 23/32 | 0.60 (0.27) |
| 31/32 | THLDH312 | 1-13/32 | 1-7/16 | 1-1/4 | 2 | 23/32 | 0.51 (0.23) |
| 1 | THLDH322 | 1-15/32 | 1-1/2 | 1-5/16 | 2-1/16 | 3/4 | 0.57 (0.26) |
| 1-1/16 | THLDH342 | 1-9/16 | 1-1/2 | 1-3/8 | 2-1/8 | 3/4 | 0.59 (0.27) |
| 1-1/8 | THLDH362 | 1-5/8 | 1-1/2 | 1-7/16 | 2-3/16 | 13/16 | 0.63 (0.29) |
| 1-3/16 | THLDH382 | 1-11/16 | 1-1/2 | 1-1/2 | 2-1/4 | 7/8 | 0.68 (0.31) |
| 1-1/4 | THLDH402 | 1-3/4 | 1-1/2 | 1-1/2 | 2-1/4 | 15/16 | 0.72 (0.33) |
| 1-5/16 | THLDH422A | 1-7/8 | 1-3/4 | 1-9/16 | 2-1/2 | 7/8 | 0.95 (0.43) |
| 1-3/8 | THLDH442 | 1-15/16 | 1-3/4 | 1-9/16 | 2-1/2 | 7/8 | 0.98 (0.44) |
| 1-7/16 | THLDH462 | 2 | 1-3/4 | 1-5/8 | 2-1/2 | 15/16 | 1.01 (0.46) |
| 1-1/2 | THLDH482 | 2-1/8 | 1-3/4 | 1-11/16 | 2-1/2 | 1-1/16 | 1.23 (0.56) |
| 1-9/16 | THLDH502 | 2-3/16 | 1-3/4 | 1-7/8 | 2-5/8 | 1-5/32 | 1.19 (0.54) |
| 1-5/8 | THLDH522 | 2-1/4 | 1-3/4 | 1-7/8 | 2-5/8 | 1-5/32 | 1.30 (0.59) |
| 1-11/16 | THLDH542 | 2-3/8 | 1-3/4 | 2 | 2-3/4 | 1-3/16 | 1.59 (0.72) |
| 1-3/4 | THLDH562 | 2-7/16 | 1-3/4 | 2 | 2-3/4 | 1-3/16 | 1.63 (0.74) |
| 1-13/16 | THLDH582 | 2-1/2 | 1-3/4 | 2-1/8 | 2-7/8 | 1-1/4 | 1.65 (0.75) |
| 1-7/8 | THLDH602 | 2-9/16 | 1-3/4 | 2-1/4 | 3 | 1-5/8 | 1.87 (0.85) |
| 2 | THLDH642 | 2-3/4 | 1-3/4 | 2-3/8 | 3-1/8 | 1-3/8 | 2.17 (0.98) |
| 2-1/16 | THLDH662 | 2-15/16 | 1-3/4 | 2-3/8 | 3-1/8 | 1-3/8 | 2.06 (0.93) |
| 2-1/8 | THLDH682 | 2-15/16 | 1-3/4 | 2-1/2 | 3-1/4 | 1-7/16 | 2.65 (1.2) |
| 2-3/16 | THLDH702 | 2-15/16 | 1-3/4 | 2-1/2 | 3-1/4 | 1-1/2 | 2.46 (1.12) |
| 2-1/4 | THLDH722 | 3-1/8 | 1-3/4 | 2-5/8 | 3-3/8 | 1-1/2 | 3.23 (1.47) |
| 2-3/8 | THLDH762 | 3-1/4 | 1-3/4 | 2-7/8 | 3-3/8 | 1-3/4 | 3.60 (1.63) |

ASME®/ANSI® B107.100

3/4" Drive, Shallow, mm

| mm | 12 | A | B | C | D | E | Weight, lb (kg) |
|----|-----------|-------|-------|-------|-------|-------|-----------------|
| 22 | THLDHM222 | 31.10 | 34.60 | 30.20 | 50.80 | 17.10 | 0.48 (0.22) |
| 24 | THLDHM242 | 33.40 | 34.60 | 31.80 | 50.80 | 17.90 | 0.52 (0.24) |
| 27 | THLDHM272 | 37.30 | 39.50 | 31.80 | 54.00 | 19.90 | 0.56 (0.25) |
| 30 | THLDHM302 | 41.00 | 39.80 | 34.00 | 57.20 | 21.80 | 0.61 (0.28) |
| 36 | THLDHM362 | 49.3 | 41.2 | 35.1 | 58.7 | 22.1 | 0.94 (0.43) |
| 41 | THLDHM412 | 55.1 | 44.5 | 42.9 | 66.5 | 26.7 | 1.25 (0.57) |

ASME®/ANSI® B107.1-1993



- Wear appropriate eye protection
- Be sure to use a lanyard that has more weight capacity than the tool you are attaching because drop forces are greater than actual tool weight.
- Any tool that weighs more than 5 pounds should be attached to an anchor point such as a work platform or utility bucket rather than the operator.
- Do not use "cheater bars" on handles
- Read safety precautions on pages W1 to W4



REVERSIBLE RATCHETING COMBINATION / (BLUE POINT®)



THBOERM19

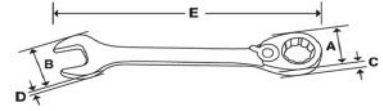

Standard Handle, 15° Offset, mm

| mm | Stock No. | A | B | C | D | E | Weight, lb (kg) |
|----|-----------|-------|------|------|------|-------|-----------------|
| 6 | THBOERM6 | 16.30 | 16.3 | 6.6 | 3.6 | 114.3 | 0.06 (0.03) |
| 7 | THBOERM7 | 16.50 | 16.4 | 6.6 | 3.9 | 125 | 0.07 (0.03) |
| 8 | THBOERM8 | 17.80 | 17.7 | 6.5 | 4 | 135 | 0.08 (0.04) |
| 9 | THBOERM9 | 19.50 | 20 | 7.4 | 4 | 150 | 0.09 (0.04) |
| 10 | THBOERM10 | 21.50 | 21.9 | 8 | 5 | 160 | 0.14 (0.06) |
| 11 | THBOERM11 | 22.00 | 23.9 | 8.5 | 5.5 | 170 | 0.15 (0.07) |
| 12 | THBOERM12 | 23.50 | 25 | 9 | 5.5 | 175 | 0.19 (0.09) |
| 13 | THBOERM13 | 25.00 | 25.9 | 10 | 6.3 | 180 | 0.23 (0.1) |
| 14 | THBOERM14 | 27.00 | 29.9 | 10 | 6.5 | 190 | 0.29 (0.13) |
| 15 | THBOERM15 | 28.50 | 31.1 | 11 | 7 | 200 | 0.31 (0.14) |
| 16 | THBOERM16 | 30.50 | 33.6 | 11 | 7 | 210 | 0.36 (0.16) |
| 17 | THBOERM17 | 32.00 | 36.5 | 12 | 7 | 230 | 0.45 (0.2) |
| 18 | THBOERM18 | 34.50 | 38.5 | 12 | 8 | 240 | 0.50 (0.23) |
| 19 | THBOERM19 | 36.50 | 38.7 | 12.9 | 8.7 | 250 | 0.58 (0.26) |
| 21 | THBOERM21 | 39.40 | 43.2 | 13.7 | 9.4 | 266.7 | 0.78 (0.35) |
| 22 | THBOERM22 | 41.70 | 45.7 | 14.5 | 9.4 | 285.8 | 0.90 (0.41) |
| 24 | THBOERM24 | 46.50 | 49.5 | 15.5 | 11.2 | 304.8 | 1.17 (0.53) |
| 25 | THBOERM25 | 47.20 | 52.8 | 15.5 | 11.2 | 327.2 | 1.26 (0.57) |



THBOER28

Standard Handle, 15° Offset, inches

| in | Stock No. | A | B | C | D | E | Weight, lb (kg) |
|-------|-----------|---------|---------|-------|-------|---------|-----------------|
| 1/4 | THBOER8 | 21/32 | 21/32 | 1/4 | 5/32 | 4-1/2 | 0.06 (0.03) |
| 5/16 | THBOER10 | 11/16 | 11/16 | 1/4 | 5/32 | 5-5/16 | 0.08 (0.04) |
| 3/8 | THBOER12 | 27/32 | 7/8 | 5/16 | 3/16 | 6-5/16 | 0.14 (0.06) |
| 7/16 | THBOER14 | 7/8 | 15/16 | 11/32 | 7/32 | 6-11/16 | 0.16 (0.07) |
| 1/2 | THBOER16 | 31/32 | 1-1/32 | 13/32 | 13/32 | 7-1/16 | 0.22 (0.1) |
| 9/16 | THBOER18 | 1-1/16 | 1-3/16 | 13/32 | 13/32 | 7-1/2 | 0.28 (0.13) |
| 5/8 | THBOER20 | 1-3/16 | 1-5/16 | 7/16 | 7/16 | 8-1/4 | 0.36 (0.16) |
| 11/16 | THBOER22 | 1-1/4 | 1-7/16 | 15/32 | 15/32 | 9-1/16 | 0.44 (0.2) |
| 3/4 | THBOER24 | 1-7/16 | 1-17/32 | 1/2 | 1/2 | 9-13/16 | 0.59 (0.27) |
| 13/16 | THBOER26 | 1-9/16 | 1-23/32 | 17/32 | 17/32 | 10-1/2 | 0.75 (0.34) |
| 7/8 | THBOER28 | 1-21/32 | 1-27/32 | 9/16 | 9/16 | 11-1/4 | 0.89 (0.4) |
| 15/16 | THBOER30 | 1-27/32 | 1-31/32 | 5/8 | 5/8 | 12 | 1.11 (0.5) |
| 1 | THBOER32 | 1-7/8 | 2-3/32 | 5/8 | 5/8 | 12-7/8 | 1.26 (0.57) |



THOEXM190B



THOEX24B

Standard Length, mm, Combination

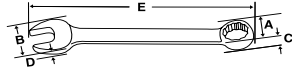

| mm | 12 | A | B | C | D | E | Weight lbs (kg) |
|----|------------|----|----|----|----|----|-----------------|
| 8 | THOEXM80B | 13 | 17 | 6 | 4 | 4 | 0.07 (0.03) |
| 9 | THOEXM90B | 14 | 19 | 6 | 5 | 5 | 0.09 (0.04) |
| 10 | THOEXM100B | 15 | 21 | 7 | 5 | 5 | 0.105 (0.05) |
| 11 | THOEXM110B | 17 | 23 | 8 | 6 | 6 | 0.15 (0.07) |
| 12 | THOEXM120B | 18 | 25 | 8 | 6 | 6 | 0.155 (0.07) |
| 13 | THOEXM130B | 20 | 27 | 9 | 6 | 6 | 0.21 (0.1) |
| 14 | THOEXM140B | 21 | 29 | 9 | 7 | 7 | 0.25 (0.11) |
| 15 | THOEXM150B | 22 | 31 | 10 | 7 | 7 | 0.29 (0.13) |
| 16 | THOEXM160B | 24 | 33 | 10 | 7 | 7 | 0.335 (0.15) |
| 17 | THOEXM170B | 25 | 35 | 11 | 8 | 8 | 0.38 (0.17) |
| 18 | THOEXM180B | 27 | 37 | 12 | 8 | 8 | 0.44 (0.2) |
| 19 | THOEXM190B | 28 | 39 | 12 | 9 | 9 | 0.51 (0.23) |
| 20 | THOEXM200B | 30 | 41 | 13 | 9 | 9 | 0.555 (0.25) |
| 21 | THOEXM210B | 31 | 43 | 13 | 9 | 9 | 0.65 (0.29) |
| 22 | THOEXM220B | 33 | 46 | 14 | 10 | 10 | 0.77 (0.35) |
| 23 | THOEXM230B | 34 | 47 | 14 | 10 | 10 | 0.82 (0.37) |
| 24 | THOEXM240B | 35 | 49 | 15 | 11 | 11 | 0.9 (0.41) |
| 25 | THOEXM250B | 37 | 52 | 16 | 11 | 11 | 1.12 (0.51) |
| 26 | THOEXM260B | 38 | 53 | 16 | 11 | 11 | 1.13 (0.51) |
| 27 | THOEXM270B | 39 | 55 | 17 | 12 | 12 | 1.3 (0.59) |
| 29 | THOEXM290B | 42 | 58 | 18 | 12 | 12 | 1.43 (0.65) |
| 30 | THOEXM300B | 44 | 61 | 19 | 13 | 13 | 1.6 (0.73) |
| 32 | THOEXM320B | 46 | 65 | 19 | 14 | 14 | 1.93 (0.88) |
| 34 | THOEXM340B | 48 | 68 | 19 | 14 | 14 | 2.1 (0.95) |
| 36 | THOEXM360B | 53 | 74 | 22 | 15 | 15 | 2.655 (1.2) |

Standard Length, inches, Combination

| 11 | 12 | A | B | C | D | E | Weight lbs (kg) |
|--------|----------|---------|---------|-------|-------|----------|-----------------|
| 1/4 | THOEX8B | 13/32 | 17/32 | 3/16 | 5/32 | 5 | 0.05 (0.02) |
| 5/16 | THOEX10B | 1/2 | 21/32 | 7/32 | 5/32 | 5-3/4 | 0.075 (0.03) |
| 11/32 | THOEX11B | 17/32 | 3/4 | 1/4 | 3/16 | 6-1/8 | 0.085 (0.04) |
| 3/8 | THOEX12B | 19/32 | 13/16 | 5/16 | 3/16 | 6-1/2 | 0.115 (0.05) |
| 7/16 | THOEX14B | 21/32 | 29/32 | 5/16 | 7/32 | 7-1/4 | 0.16 (0.07) |
| 1/2 | THOEX16B | 3/4 | 1-1/16 | 11/32 | 1/4 | 8 | 0.19 (0.09) |
| 9/16 | THOEX18B | 27/32 | 1-3/16 | 3/8 | 9/32 | 8-3/4 | 0.275 (0.12) |
| 5/8 | THOEX20B | 15/16 | 1-5/16 | 13/32 | 9/32 | 9-1/2 | 0.32 (0.15) |
| 11/16 | THOEX22B | 1-1/32 | 1-13/32 | 7/16 | 5/16 | 10-1/4 | 0.39 (0.18) |
| 3/4 | THOEX24B | 1-1/8 | 1-9/16 | 15/32 | 11/32 | 11 | 0.52 (0.24) |
| 13/16 | THOEX26B | 1-3/16 | 1-21/32 | 17/32 | 3/8 | 11-3/4 | 0.595 (0.27) |
| 7/8 | THOEX28B | 1-9/32 | 1-13/16 | 9/16 | 3/8 | 12-1/2 | 0.755 (0.34) |
| 15/16 | THOEX30B | 1-3/8 | 1-29/32 | 19/32 | 13/32 | 13-1/4 | 0.87 (0.39) |
| 1 | THOEX32B | 1-15/32 | 2-1/32 | 21/32 | 7/16 | 14 | 1.105 (0.5) |
| 1-1/16 | THOEX34B | 1-9/16 | 2-3/16 | 11/16 | 15/32 | 14-3/4 | 1.285 (0.58) |
| 1-1/8 | THOEX36B | 1-5/8 | 2-5/16 | 11/16 | 17/32 | 15-7/16 | 1.405 (0.64) |
| 1-3/16 | THOEX38B | 1-3/4 | 2-7/16 | 3/4 | 1/2 | 16-5/16 | 1.5 (0.68) |
| 1-1/4 | THOEX40B | 1-13/16 | 2-9/16 | 3/4 | 17/32 | 17-1/8 | 1.905 (0.86) |
| 1-5/16 | THOEX42B | 1-29/32 | 2-21/32 | 3/4 | 9/16 | 14-13/16 | 2.105 (0.95) |
| 1-3/8 | THOEX44B | 2 | 2-13/16 | 3/4 | 19/32 | 18-9/16 | 2.385 (1.08) |
| 1-7/16 | THOEX46B | 2-1/16 | 2-29/32 | 7/8 | 19/32 | 19-1/32 | 2.635 (1.2) |
| 1-1/2 | THOEX48B | 2-5/32 | 3-1/16 | 7/8 | 5/8 | 20-1/16 | 3.305 (1.5) |
| 1-9/16 | THOEX50B | 2-1/4 | 3-3/16 | 7/8 | 22/32 | 20-13/16 | 3.265 (1.48) |
| 1-5/8 | THOEX52B | 2-11/32 | 3-11/32 | 7/8 | 11/16 | 21-9/16 | 3.69 (1.67) |



THXBM1719A



THXB2426A

Double Box, Standard Length, 10° Offset, mm

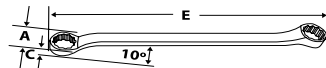

| mm | 12 | A | C | E | Weight lbs (kg) |
|-------|------------|-----------|-----------|-----|-----------------|
| 8-10 | THXBM810A | 12.3-15 | 6.7-7.7 | 185 | 0.14 (0.06) |
| 11-13 | THXBM1113A | 16.4-19.1 | 8.3-9.3 | 219 | 0.23 (0.1) |
| 12-14 | THXBM1214A | 17.7-20.4 | 8.8-9.7 | 230 | 0.25 (0.11) |
| 13-15 | THXBM1315A | 19.1-21.8 | 9.3-10.2 | 241 | 0.32 (0.15) |
| 14-17 | THXBM1417A | 20.4-25.4 | 9.8-11.4 | 248 | 0.35 (0.16) |
| 16-18 | THXBM1618A | 23.1-25.9 | 10.9-11.9 | 275 | 0.48 (0.22) |
| 17-19 | THXBM1719A | 24.5-27.2 | 11.4-12.3 | 286 | 0.48 (0.22) |
| 18-21 | THXBM1821A | 25.9-29.9 | 11.9-13.3 | 303 | 0.58 (0.26) |
| 22-24 | THXBM2224A | 31.3-34 | 13.7-14.7 | 342 | 0.88 (0.4) |
| 27-30 | THXBM2730A | 38.1-42.2 | 16-17.3 | 404 | 1.45 (0.66) |

Double Box, Standard Length, 10° Offset, inches

| 11 | 12 | A | C | E | Weight lbs (kg) |
|--------------|-----------|---------------|-------------|----------|-----------------|
| 3/8-7/16 | THXB1214A | 9/13-21/32 | 5/16-11/32 | 7-19/32 | 0.17 (0.08) |
| 1/2-9/16 | THXB1618A | 3/4-13/16 | 11/32-13/16 | 8-11/16 | 0.305 (0.14) |
| 5/8-11/16 | THXB2022A | 29/32-1 | 7/16-15/32 | 10-5/32 | 0.44 (0.2) |
| 3/4-13/16 | THXB2426A | 1-1/16-5/32 | 1/2-17/32 | 11-21/32 | 0.665 (0.3) |
| 7/8-15/16 | THXB2830A | 1-1/4-11/32 | 17/32-9/16 | 13-1/8 | 0.935 (0.42) |
| 1-1-1/16 | THXB3234A | 1-13/32-1/2 | 19/32-5/8 | 14-19/32 | 1.28 (0.58) |
| 1-1/4-1-5/16 | THXB4042A | 1-3/4-1-27/32 | 22/32-3/4 | 17-19/32 | 2.055 (0.93) |



Wrench with Safety Coil –
Secure lanyard attachments need to withstand tough site use, including low temperature, so structural integrity is critical

- Superior Design - No welds to fail
- High Performance - Made from polished stainless steel, they have superior flexibility and shock-absorbing qualities over welded attachments
- Seven sizes available to support wrenches up to 1 1/2" or 55mm
- Slides out of the way along the wrenches handle to provide full use of the handle and achieve greatest leverage



- Wear appropriate eye protection
- Be sure to use a lanyard that has more weight capacity than the tool you are attaching because drop forces are greater than actual tool weight.
- Any tool that weighs more than 5 pounds should be attached to an anchor point such as a work platform or utility bucket rather than the operator.
- Do not use "cheater bars" on handles
- Read safety precautions on pages W1 to W4



WRENCHES



THXSM67A

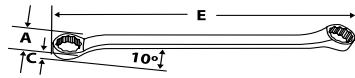

Short Handle, 10° Offset, mm

| mm | 12 | A | C | E | Weight, lbs (kg) |
|-----|----------|------------|-----------|----|------------------|
| 6-7 | THXSM67A | 9.6 - 10.9 | 5.7 - 6.2 | 86 | 0.04 (0.02) |



THXID1618A

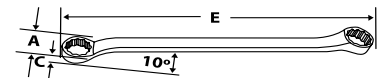

Midget, 10° Offset, inches

| 11 | 12 | A | C | E | Weight, lbs (kg) |
|------------|------------|--------------|-------------|---------|------------------|
| 1/4-9/32 | THXID1618A | 13/32 - 7/16 | 5/32 - 3/16 | 3-13/32 | 0.045 (0.02) |
| 5/16-11/32 | THXID2022A | 15/32 - 1/2 | 3/16 - 7/32 | 3-31/32 | 0.07 (0.03) |



THRXFMS1314B

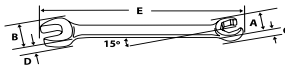

Flare Nut Double End, mm

| mm | 6 | A | C | E | Weight lbs (kg) |
|-------|--------------|---------|---------|-----|-----------------|
| 9-11 | THRXFMS911B | 18 - 21 | 7 - 8 | 145 | 0.14 (0.06) |
| 10-12 | THRXFMS1012B | 20 - 22 | 8 - 9 | 153 | 0.15 (0.07) |
| 13-14 | THRXFMS1314B | 24 - 25 | 9 - 10 | 173 | 0.25 (0.11) |
| 15-17 | THRXFMS1517B | 26 - 29 | 10 - 11 | 193 | 0.36 (0.16) |
| 16-18 | THRXFMS1618B | 28 - 30 | 11 - 12 | 200 | 0.395 (0.18) |
| 19-21 | THRXFMS1921B | 32 - 34 | 12 - 13 | 223 | 0.555 (0.25) |



THFRDH181

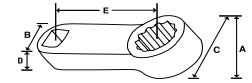

3/8" Drive Torque Adaptors, Non-Spline

| Stock No. | Size | A | B | C | D | E | Weight lbs (kg) |
|-----------|-------|------|------|-------|------|---|-----------------|
| THFRDH101 | 5/16" | .475 | .750 | 1/4 | 7/16 | 2 | 0.07 (0.03) |
| THFRDH121 | 3/8" | .570 | .750 | 5/16 | 7/16 | 2 | 0.084 (0.04) |
| THFRDH141 | 7/16" | .655 | .750 | 11/32 | 7/16 | 2 | 0.09 (0.04) |
| THFRDH161 | 1/2" | .740 | .750 | 11/32 | 7/16 | 2 | 0.1 (0.05) |
| THFRDH181 | 9/16" | .825 | .750 | 3/8 | 7/16 | 2 | 0.1 (0.05) |



THPW14C



THPWA14A

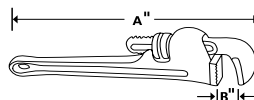

External Pipe Wrenches

| Cast Iron Handle Stock No. | Cast Iron Weight, lbs (kg) | Aluminum Handle Stock No. | Aluminum Weight, lbs (kg) | A | B Max Opening |
|----------------------------|----------------------------|---------------------------|---------------------------|----|---------------|
| THPW6C | 0.45 (0.2) | — | — | 6 | 3/4 |
| THPW8C | 0.82 (0.37) | — | — | 8 | 1 |
| THPW10C | 1.70 (0.77) | THPWA10A | 1.11 (0.5) | 10 | 1-1/2 |
| THPW12C | 2.58 (1.17) | — | — | 12 | 2 |
| THPW14C | 3.65 (1.66) | THPWA14A | 2.20 (1) | 14 | 2 |
| THPW18C | 6.5 (2.94) | THPWA18A | 3.58 (1.62) | 18 | 2-1/2 |



THPW36C

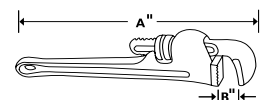

Pipe Wrenches Over 5lbs

| Cast Iron Handle Stock No. | Cast Iron Weight, lbs (kg) | Aluminum Handle Stock No. | Aluminum Weight, lbs (kg) | A | B Max Opening |
|----------------------------|----------------------------|---------------------------|---------------------------|----|---------------|
| THPW24C | 10.5 (4.76) | THPWA24AA | 6.5 (2.95) | 24 | 3 |
| THPW36C | 20 (9.07) | THPWA36A | 12.5 (5.67) | 36 | 5 |

* Tools@Height™ Tools Over 5 lbs. with Engineered Attachment Point. Three-foot-long web strap/carabiner system designed for use with "master ring" systems.





THBXORM1617



THBXOR1820



Ratcheting Box - Standard Handle - 25° Offset, MM, Blue-Point®

| mm | 12 | A | B | E | Weight, lb (kg) |
|-------|-------------|-----------|-----------|-------|-----------------|
| 8-9 | THBXORM89 | 18-19.3 | 6.4-7.6 | 184.2 | 0.12 (0.05) |
| 10-11 | THBXORM1011 | 21.8-22.1 | 8.1-8.6 | 203.2 | 0.20 (0.09) |
| 12-13 | THBXORM1213 | 23.6-26.6 | 8.9-10.2 | 222.3 | 0.26 (0.12) |
| 14-15 | THBXORM1415 | 27.2-28.7 | 10.2-10.9 | 241.3 | 0.39 (0.18) |
| 16-17 | THBXORM1617 | 31-32 | 10.9-11.9 | 260.4 | 0.51 (0.23) |
| 18-19 | THBXORM1819 | 34.5-36.8 | 12.2-13.2 | 279.4 | 0.55 (0.25) |

Ratcheting Box - Standard Length - 25° Offset, Inches, Blue-Point®

| II | 12 | A | C | E | Weight, lbs (kg) |
|-----------|------------|-------------|-------------|-------|------------------|
| 5/16-3/8 | THBXOR1012 | 23/32-7/8 | 1/4-5/16 | 7-1/2 | 0.15 (0.07) |
| 7/16-1/2 | THBXOR1416 | 7/8-31/32 | 11/32-13/32 | 8-3/4 | 0.27 (0.12) |
| 9/16-5/8 | THBXOR1820 | 1-1/16-7/32 | 13/32-7/16 | 9-3/4 | 0.41 (0.19) |
| 11/16-3/4 | THBXOR2224 | 1-9/32-7/16 | 15/32-1/2 | 11 | 0.64 (0.29) |

Four-Way Angle Head, mm



| mm | Stock No. | B | D | E | Weight, lb (kg) |
|----|------------|----|---|-----|-----------------|
| 10 | THVSM5210B | 20 | 6 | 127 | 0.09 (0.04) |
| 11 | THVSM5211B | 22 | 6 | 137 | 0.09 (0.04) |
| 12 | THVSM5212B | 24 | 6 | 145 | 0.12 (0.05) |
| 13 | THVSM5213B | 26 | 6 | 154 | 0.16 (0.07) |
| 14 | THVSM5214B | 28 | 6 | 164 | 0.18 (0.08) |
| 15 | THVSM5215B | 30 | 7 | 173 | 0.19 (0.09) |
| 16 | THVSM5216B | 31 | 7 | 181 | 0.23 (0.1) |
| 17 | THVSM5217B | 34 | 7 | 191 | 0.27 (0.12) |
| 18 | THVSM5218B | 36 | 7 | 200 | 0.30 (0.14) |
| 19 | THVSM5219B | 37 | 7 | 210 | 0.33 (0.15) |
| 21 | THVSM5221B | 41 | 8 | 228 | 0.46 (0.21) |
| 22 | THVSM5222B | 44 | 8 | 239 | 0.53 (0.24) |
| 24 | THVSM5224B | 47 | 8 | 254 | 0.60 (0.27) |
| 27 | THVSM5227B | 53 | 9 | 283 | 0.86 (0.39) |



THVSM5219B

Four-Way Angle Head, inches

| II | Stock No. | B | D | E | Weight, lb (kg) |
|-------|-----------|---------|-------|---------|-----------------|
| 1/4 | THVS8B | 17/32 | 3/16 | 3-11/16 | 0.04 (0.02) |
| 5/16 | THVS10B | 21/32 | 3/16 | 4-1/4 | 0.05 (0.02) |
| 11/32 | THVS11B | 23/32 | 7/32 | 4-17/32 | 0.07 (0.03) |
| 3/8 | THVS12B | 25/32 | 7/32 | 4-27/32 | 0.08 (0.04) |
| 7/17 | THVS14B | 7/8 | 7/32 | 5-13/32 | 0.10 (0.05) |
| 1/2 | THVS16B | 1 | 1/4 | 5-31/32 | 0.13 (0.06) |
| 9/16 | THVS18B | 1-1/8 | 1/4 | 6-9/16 | 0.16 (0.07) |
| 5/8 | THVS20B | 1-1/4 | 9/32 | 7-1/8 | 0.22 (0.1) |
| 11/16 | THVS22B | 1-3/8 | 9/32 | 7-11/16 | 0.28 (0.13) |
| 3/4 | THVS24B | 1-15/32 | 9/32 | 8-9/32 | 0.34 (0.15) |
| 13/16 | THVS26B | 1-19/32 | 5/16 | 8-27/32 | 0.42 (0.19) |
| 7/8 | THVS28B | 1-23/32 | 5/16 | 9-13/32 | 0.52 (0.24) |
| 15/16 | THVS30B | 1-27/32 | 11/32 | 10 | 0.60 (0.27) |
| 1 | THVS32B | 1-31/32 | 11/32 | 10-9/16 | 0.75 (0.34) |



THVS24B



- Wear appropriate eye protection
- Be sure to use a lanyard that has more weight capacity than the tool you are attaching because drop forces are greater than actual tool weight.
- Any tool that weighs more than 5 pounds should be attached to an anchor point such as a work platform or utility bucket rather than the operator.
- Do not use "cheater bars" on handles
- Read safety precautions on pages W1 to W4



WRENCHES

Combination T and L-Shape Wrenches

- Ergonomic, soft-grip handle provides comfort during repetitive tasks
- Allows maximum pressure to be applied when loosening troublesome fasteners with both “T” and “L” applications
- Blades constructed from high strength steel and hardened for durability
- Blade tips are black oxide coated to prevent chipping and to help maintain a secure fastener engagement



THAWSGM6



THAWSG14



THGAJ15A

Screw is staked to prevent accidental loosening



THGAJ24A

- Short blade provides maximum torque for tight quarters
- Long blade promotes quick fastener turning in difficult access situations
- Hole in handle for hanging or tethering
- Color-coded handles identify metric and inch sizes at a glance
- Supplied with **THRET1CLIPSA** that can be used with optional **THUNIRET1A** Retractable Lanyard

Hex, mm Tethered Wrench

| mm | Blue Handle | T-Length, mm | Length, mm | Weight, lb (kg) |
|-----|-------------|--------------|------------|-----------------|
| 2 | THAWSGM2 | 95 | 152 | 0.07 (0.03) |
| 2.5 | THAWSGM2.5 | 95 | 152 | 0.08 (0.04) |
| 3 | THAWSGM3 | 98 | 152 | 0.09 (0.04) |
| 4 | THAWSGM4 | 98 | 187 | 0.11 (0.05) |
| 5 | THAWSGM5 | 117 | 187 | 0.20 (0.09) |
| 6 | THAWSGM6 | 117 | 246 | 0.28 (0.13) |
| 8 | THAWSGM8 | 117 | 246 | 0.40 (0.18) |
| 10 | THAWSGM10 | 124 | 248 | 0.53 (0.24) |

Hex, SAE® Tethered Wrench

| SAE® | Red Handle | T-Length, inches | Length, inches | Weight, lb (kg) |
|------|------------|------------------|----------------|-----------------|
| 3/32 | THAWSG06 | 3-7/8 | 6 | 0.08 (0.04) |
| 6/64 | THAWSG07 | 3-7/8 | 6 | 0.08 (0.04) |
| 1/8 | THAWSG08 | 3-7/8 | 6 | 0.08 (0.04) |
| 9/64 | THAWSG09 | 3-7/8 | 6 | 0.10 (0.05) |
| 5/32 | THAWSG10 | 3-7/8 | 7-3/8 | 0.11 (0.05) |
| 3/16 | THAWSG12 | 4-3/4 | 7-3/4 | 0.20 (0.09) |
| 7/32 | THAWSG14 | 4-3/4 | 7-3/4 | 0.23 (0.1) |
| 1/4 | THAWSG16 | 4-3/4 | 9-5/8 | 0.28 (0.13) |
| 5/16 | THAWSG20 | 4-3/4 | 9-5/8 | 0.39 (0.18) |
| 3/8 | THAWSG24 | 4-3/4 | 9-5/8 | 0.51 (0.23) |

Adjustable Wrenches

| Stock No. | A, inches (mm) | Length, inches (mm) | Weight, lb (kg) |
|-----------|----------------|---------------------|-----------------|
| THGAJ4A | 4 (108) | 1/2 (13) | 0.14 (0.06) |
| THGAJ6A | 6 (160) | 1 (25.4) | 0.34 (0.15) |
| THGAJ8A | 8 (210) | 1-1/8 (29) | 0.67 (0.3) |
| THGAJ10A | 10 (260) | 1-9/32 (33) | 1.04 (0.47) |
| THGAJ12A | 12 (310) | 1-1/2 (38) | 1.69 (0.77) |
| THGAJ15A | 15 (385) | 1-19/32 (43) | 2.78 (1.26) |
| THGAJ18A | 18 (450) | 2-1/16 (52) | 4.01 (1.82) |
| THGAJ24A | 24 (610) | 2-7/16 (62) | 8 (3.62) |
| THGAJS30A | 30 (778) | 3-11/32 (85) | 15 (6.8) |

* Tools@Height™ Tools Over 5 lbs. with Engineered Attachment Point. Three-foot-long web strap/carabiner system designed for use with “master ring” systems.

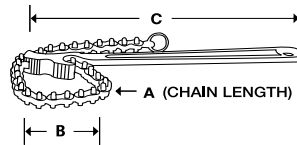

Chain Wrenches

| Stock No. | A | B | C | Weight, lb (kg) |
|-----------|----|---|----|-----------------|
| THCW12A | 16 | 4 | 12 | 1.85 (0.84) |
| THCW15A | 19 | 5 | 15 | 2.65 (1.2) |
| THCW24A | 23 | 6 | 24 | 4.10 (1.86) |



THCW24A

Adjustable Hook Spanners

- Services collars, rings, and bearings
- Single jaw and roll pin construction with an industrial finish
- Make sure jaw hook is properly positioned when in use

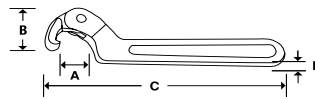

| Stock No. | A | B | C | D | Weight, lb (kg) |
|-----------|-------------|------|--------|-------|-----------------|
| THAHS300B | 3/4-2 | 1/8 | 6-3/8 | 11/32 | 0.29 (0.13) |
| THAHS301B | 1-1/4-3 | 5/32 | 8-1/8 | 13/32 | 0.49 (0.22) |
| THAHS304B | 2-4-3/4 | 3/16 | 11-3/8 | 15/32 | 0.98 (0.44) |
| THAHS307B | 4-1/2-6-1/2 | 1/4 | 12-1/8 | 15/32 | 1.06 (0.48) |



THAHS304B

Adjustable Pin Spanners

- Removes rings, collars, and lock nuts
- Make sure jaw hook is positioned correctly when in use

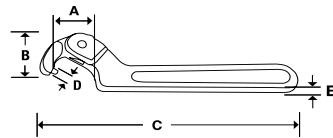

| Stock No. | A | B | C | D | E | Weight, lb (kg) |
|-----------|-------------|------|--------|------|-------|-----------------|
| THAPS351B | 3/4-2 | 1/8 | 6-3/8 | 1/8 | 11/32 | 0.28 (0.13) |
| THAPS357B | 1-1/4-3 | 3/16 | 8-1/8 | 3/16 | 11/32 | 0.48 (0.22) |
| THAPS363B | 2-4-3/4 | 1/4 | 11-3/8 | 1/4 | 15/32 | 0.91 (0.41) |
| THAPS366B | 4-1/2-6-1/2 | 1/4 | 12-1/8 | 3/8 | 15/32 | 1.08 (0.49) |



THAPS363B

Adjustable Face Pin Spanners

- For servicing seal and packing nuts on hydraulic cylinders.

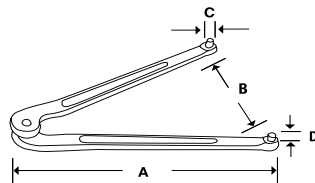

| Stock No. | A | B | C | D | Weight, lb (kg) |
|-----------|--------|---|------|------|-----------------|
| THAFS482B | 6-3/8 | 2 | 3/16 | 5/32 | 0.32 (0.15) |
| THAFS483B | 8-1/4 | 3 | 1/4 | 3/16 | 0.61 (0.28) |
| THAFS484B | 10-3/8 | 4 | 5/16 | 1/4 | 0.99 (0.45) |



THAFS484B



- Wear appropriate eye protection
- Be sure to use a lanyard that has more weight capacity than the tool you are attaching because drop forces are greater than actual tool weight.
- Any tool that weighs more than 5 pounds should be attached to an anchor point such as a work platform or utility bucket rather than the operator.
- Do not use "cheater bars" on handles
- Read safety precautions on pages W1 to W4



TORQUE WRENCHES

ControlTech™ Industrial Electronic Torque Wrenches

- Torque accuracy: +/- 2% CW, +/- 3% CCW from 20 to 100% F.S.; +/- 4% CW, +/- 6% CCW from 5 to 19% F.S.
- New lock button square drive and battery cap with integral attachment point for use in dropped object prevention applications
- Fully programmable for reliable, repeatable torque application
- Three feedback methods work for both torque and angle: visual (LCD and LED); audible (beep); and tactile (vibration)
- Dual 80® technology on all 72 and 80 tooth
- Torque and angle presets can be selected and torque jobs can be created with presets
- Steel construction and rugged gyroscope provide extreme drop protection
- Real-time clock to indicate when calibration is required

Battery cap with integral attachment point and lock button square drive



Lanyard Sold Separately

THCTEC1FR240

- 50 memory presets, sequence programming and job mode
- USB plug and play technology for easy data download to PC
- High storage capacity for 1,500 readings
- Industry-leading 2 year warranty

| Square Drive | Stock No. | Head Type | Gear Action | Gear Teeth | Range N•m | Range ft-lb | Range in-lb | Ratchet Service Kit | Head Depth, inches | Head Width, inches | Length, inches | Weight lbs |
|--------------|--------------|---------------|-------------|------------|------------|-------------|-------------|---------------------|--------------------|--------------------|----------------|------------|
| 1/4" | THCTEC1FR240 | Flex Ratchet | 5° | 72 | 1.4–27.2 | 1–20 | 12–240 | THRKR72LB | 7/16 | 7/8 | 14.1 | 2 |
| 3/8" | THCTEC2FR100 | Flex Ratchet | 4.5° | 80 | 6.8–135.6 | 5–100 | 60–1,200 | THRKR80LB | 1-3/16 | 9/16 | 17.2 | 2.7 |
| 1/2" | THCTEC3FR250 | Flex Ratchet | 4.5° | 80 | 16.9–339 | 12.5–250 | 150–3,000 | THRKR80A | 3/4 | 1-5/8 | 26.7 | 4.5 |
| 3/4" | THCTEC4R600* | Fixed Ratchet | 11° | 32 | 40.7–813.5 | 30–600 | 360–7,200 | RKRQC4 | 1-1/2 | 3-1/8 | 48.6 | 10.5 |
| 1/4" | THCTEL1R240* | Fixed Ratchet | 5° | 72 | 1.4–27.2 | 1–20 | 12–240 | THRKR72LB | 7/16 | 7/8 | 14.1 | 1.2 |

* Storage Case Included
Complies with ISO®-6789-2003 and ASME® 8107.300 (8107.28) standards for electronic torque instruments.

Techwrench®

- Torque accuracy TECH1, 2 and 3 ratchet head models: 1% CW, 1.5% CCW 2% CW, 3% CCW from 10 to 19% F.S. 4% CW, 8% CCW from 5 to 9% F.S. (TECH2 only)
- Manual peak store, recall, clear and print functions
- Memory capacity: 1000 peak readings
- TechLog™ download software CD included
- Excel® Download Template with basic statistics
- Date/time Excel® download template (wrench connected to PC)
- Serial RS232, with selectable 1200 to 19.2K baud rate
- Serial cable: 6' with 9 pin PC interconnect included
- Dual 80® technology on all 72 and 80 tooth



THTECH2R100

Applications:

- Automotive service: printout provides assurance that lug nuts, head bolts, etc. have been tightened to specification
- Assembly operations: gather data to manage quality
- Manufacturing ISO and SPC®: generate statistics for technical files and process auditing
- Military: document compliance with maintenance schedules and inspections
- Aviation: include torque data in maintenance reports

| Square Drive | Stock No. | Head Type | Gear Teeth | Swing Arc | Range N•m | Range, ft-lb | Range, in-lb | Head Depth, inches | Head Width, inches | Length, inches | Weight, lbs (kg) |
|--------------|-------------|----------------------|------------|-----------|-----------|--------------|--------------|--------------------|--------------------|----------------|------------------|
| 3/8" | THTECH2R100 | Sealed Fixed Ratchet | 80 | 4.5° | 6.7–135 | 5–100 | 60–1,200 | 5/8 | 1-5/32 | 17-1/4 | 3.20 (1.45) |
| 1/2" | THTECH3R250 | Sealed Fixed Ratchet | 80 | 4.5° | 34–339 | 25–250 | 300–3,000 | 3/4 | 1-5/8 | 26-1/4 | 5.12 (2.32) |

Adjustable Click-Type Torque Wrenches

- Certificate of Calibration. A Certificate of Calibration is packed with every QD series torque instrument. Actual certification readings and individual instrument serial numbers are included. Each torque instrument, as calibrated at the factory, is certified to meet the accuracy specified in ASME® and was calibrated on a torque standard traceable to the National Institute of Standards Technology (NIST®)
- Accuracy. All QD series torque instruments are accurate to ±4% clockwise and ±6% counterclockwise from 20% of full scale to full scale



THQD3R250A

- Long Life Ratchet Head. QD series torque instruments feature the Snap-On® high strength sealed ratchet head. Sealed ratchet heads keep out dirt and moisture while being virtually maintenance-free. Applies to all QD series ratchet head models. (U.S. Patent 6,125,722) applies to 1/4, 3/8 and 1/2" drive ratchet head models only
- Long Term Protection. Each instrument includes a storage case

| Square Drive inches | Stock No. | Head Style | Gear Teeth | Swing Arc | Range, Minimum | Range, Maximum | Increments | Length, inches | Head Width, inches | Head Depth, inches | Weight, lb (kg) |
|---|-------------|---------------|------------|-----------|----------------|----------------|------------|----------------|--------------------|--------------------|-----------------|
| U.S. Torque Instruments (ft lb) | | | | | | | | | | | |
| 3/8 | THQD2FR75 | Flex Ratchet | 36 | 10° | 5 ft-lb | 75 ft-lb | .5 ft-lb | 15.75 | 1-5/32 | 9/16 | 3.28 (1.49) |
| 3/8 | THQD2R100A | Fixed Ratchet | 36 | 10° | 20 ft lb | 100 ft lb | .5 ft lb | 15-9/16 | 1-5/32 | 9/16 | 3.30 (1.5) |
| 1/2 | THQD3R250A | Fixed Ratchet | 36 | 10° | 50 ft lb | 250 ft lb | 1 ft lb | 24-3/16 | 1-5/8 | 3/4 | 4.80 (2.18) |
| Newton Meter Torque Wrenches/+4% Accuracy | | | | | | | | | | | |
| 3/8 | THQD2RN50A | Fixed Ratchet | 36 | 10° | 10 N•m | 50 N•m | .5 N•m | 15-9/16 | 1-5/32 | 9/16 | 3.28 (1.49) |
| 3/8 | THQD2RN100A | Fixed Ratchet | 36 | 10° | 20 N•m | 100 N•m | .5 N•m | 15-9/16 | 1-5/32 | 9/16 | 3.27 (1.48) |
| 1/2 | THQD3RN350 | Fixed Ratchet | 36 | 10° | 70 N•m | 350 N•m | 2 N•m | 24-3/16 | 1-5/8 | 3/4 | 4.87 (2.21) |

SCREWDRIVERS / HAMMERS



THSHD2AR

Hard Handle Instinct® Screwdrivers

| Tip | Stock No. | A | B | C | D | Weight, lb (kg) |
|-----------|--------------|------|------|---------|----------|-----------------|
| Flat Tip | THSHD2AR | .035 | 7/32 | 2-13/16 | 6-15/16 | 0.25 |
| Flat Tip | THSHD6AR | .050 | 5/16 | 5-5/16 | 10-27/32 | 0.52 |
| Flat Tip | THSHD8AR | .055 | 3/8 | 7-29/32 | 13-13/32 | 0.8 |
| Phillips® | THSHDP31AIRR | #1 | 3/16 | 2-31/32 | 7-1/8 | 0.2 |
| Phillips® | THSHDP42AIRR | #2 | 1/4 | 3-31/32 | 8-7/8 | 0.52 |
| Phillips® | THSHDP63AIRR | #3 | 5/16 | 5-29/32 | 10-13/16 | 0.25 |
| Phillips® | THSHDP64AIRR | #4 | 3/8 | 6 | 11-1/2 | 0.5 |



THFSNE3-22SM

Scaffold Hammer

- Cushion grip handle provides greater comfort and safety
- Durable one piece design for a long lasting hammer

| Stock No. | Grip Length, inches | Overall Length, inches | Weight, lb (kg) |
|--------------|---------------------|------------------------|-----------------|
| THFSNE3-22SM | 7-1/4 | 16 | 2.13 (.97) |



THHBBD24

HBBD Series Dead Blow Hammers

- Free-flowing steel canister shot design to improve dead blow action while reducing rebound
- Soft grip handle with ribbed, textured elastomer grip prevents hand slippage
- Composite handle shank improves balance while defusing shock and dampening vibration

| Stock No. | Nominal Weight, oz | Head Length, inches | Face Diameter, inches | Length, inches | Weight, lb (kg) |
|-----------|--------------------|---------------------|-----------------------|----------------|-----------------|
| THHBBD8 | 8 | 4 | 1 | 11-5/8 | 1.03 (0.47) |
| THHBBD16 | 16 | 4-3/8 | 1-1/4 | 12-1/4 | 1.42 (0.64) |
| THHBBD24 | 24 | 4-3/4 | 1-3/8 | 12-3/4 | 1.97 (0.89) |
| THHBBD32 | 32 | 5-3/4 | 1-3/4 | 13-5/8 | 2.80 (1.27) |
| THHBBD40 | 40 | 5-3/4 | 1-3/4 | 15-1/8 | 2.90 (1.32) |



THBC114B



THBD10ESGA

Heavy Duty Sledge Hammers

| Stock No. | Description | Nominal Weight (lbs) | Overall Length, inches | Face Diameter, inches | Weight, lbs (kg) |
|------------|---|----------------------|------------------------|-----------------------|------------------|
| THBC110BA | Dead Blow 8 lb Sledge Hammer | 8 | 30 | 2-3/4" | 8.94 (4.06) |
| THBC114B | Dead Blow Sledge Hammer | 12 | 36" | 3-1/4" | 11.5 (5.22) |
| THBD6ESGA | Heavy-Duty 6 lb Sledge Fiberglass Hammer | 6 | 18" | 1-5/8" | 6.86 (3.11) |
| THBD10ESGA | Heavy-Duty 10 lb Sledge Fiberglass Hammer | 10 | 32" | 2 | 12.20 (5.53) |



THSGDE225ESD



THSGDP200ESD

Electronic Miniature Screwdrivers

- Feature rotating handles making them ideal for precise detail work

| Tip | Stock No. | A | B | C | D | Weight, lb (kg) |
|-----------|--------------|-----|------|----|-------|-----------------|
| Flat Tip | THSGDE215ESD | 1.5 | 3/32 | 22 | 5-3/4 | 0.04 |
| | THSGDE220ESD | 2.0 | 3/32 | 22 | 5-3/4 | 0.04 |
| | THSGDE225ESD | 2.5 | 3/32 | 22 | 5-3/4 | 0.04 |
| | THSGDE230ESD | 3.0 | 1/8 | 22 | 5-3/4 | 0.04 |
| Phillips® | THSGDEP20ESD | #00 | 1/8 | 22 | 5-3/4 | 0.04 |
| | THSGDP200ESD | #0 | 1/8 | 22 | 5-3/4 | 0.04 |



THHBE48

HBFE Series Dead Blow Hammers

- Free-flowing shot design to improve dead blow action while reducing rebound
- Compact head has larger surface striking area and heavier caps to improve delivered force by as much as 40%

| Stock No. | Nominal Weight, oz | Head Length, inches | Face Diameter, inches | Length, inches | Weight, lb (kg) |
|-----------|--------------------|---------------------|-----------------------|----------------|-----------------|
| THHBE16 | 16 | 3-1/4 | 1-9/16 | 12 | 1.19 (0.54) |
| THHBE24 | 24 | 3-3/4 | 1-3/4 | 12-3/4 | 1.43 (0.65) |
| THHBE32 | 32 | 4-1/4 | 2 | 13-1/2 | 2.00 (0.91) |
| THHBE48 | 48 | 4-3/4 | 2-1/4 | 15 | 2.99 (1.36) |
| THHBE56 | 56 | 5-7/16 | 2-3/4 | 15-3/4 | 3.69 (1.67) |



THHBR15

Brass (Fiberglass Handle)

- Non-sparking/non-marring surface for many applications
- Brass head absorbs blow and reduces rebound
- Flat surface for even distribution of blow
- Comfortable, nonslip handle grip

| Stock No. | Nominal Weight, oz | Length, inches | Tethered Weight, lb (kg) |
|-----------|--------------------|----------------|--------------------------|
| THHBR15 | 1-1/2 | 12 | 1.95 (0.88) |
| THHBR25 | 2-1/2 | 12 | 2.75 (1.25) |
| THHBR4 | 4 | 12 | 4.25 (1.93) |



THBPN32B



THBC4SG

Heavy Duty Fiberglass Handle Hammers

- Dampens vibration and provides strength and safety
- Handle is resistant to dry rot, warp, and splintering
- Fiberglass handle dampens vibration and provides extra strength and security
- Handle is epoxy welded to hammerhead and will withstand 8,000 lbs of separation force
- Comfortable, non-slip handle grip
- Materials will resist most shop chemicals

| Stock No. | Description | Nominal Weight, lbs | Striking Face Diameter, inches | Handle Length, inches | Overall Length, inches | Tethered Weight, lbs (kg) |
|-----------|--------------------------------------|---------------------|--------------------------------|-----------------------|------------------------|---------------------------|
| THBPN32B | Ball Peen 32-Ounce Fiberglass Hammer | 2 | - | - | 16 | 2.55 (1.16) |
| THBC4SG | Cross Peen | 4 | 1-1/2 | 12 | 14 | 4.68 (2.12) |
| THBD4SG | Engineer | 4 | 1-1/2 | 12 | 14 | 4.70 (2.13) |
| THHD4SG | Hand Drilling | 4 | 1-1/2 | 8-3/4 | 10-3/4 | 4.20 (1.91) |

- Wear appropriate eye protection
- Be sure to use a lanyard that has more weight capacity than the tool you are attaching because drop forces are greater than actual tool weight.
- Any tool that weighs more than 5 pounds should be attached to an anchor point such as a work platform or utility bucket rather than the operator.
- Do not strike another hammer or hardened object
- Do not use chipped or mushroomed hammers
- Read safety precautions on pages W1 to W4



MISCELLANEOUS TOOLS



TH86ACF

Diagonal Cutter

| Stock No. | Overall Length inches | Jaw Length inches | Weight, lbs (kg) |
|-----------|-----------------------|-------------------|------------------|
| TH85ACF | 5 | 9/16 | 0.20 (0.09) |
| TH86ACF | 7-3/8 | 13/16 | 0.43 (0.2) |
| TH87ACF | 6-5/16 | 3/4 | 0.64 (0.29) |
| TH388ACF | 8-5/16 | 1-1/16 | 0.76 (0.34) |



TH95BCP

Needle Nose Pliers

| Stock No. | Overall Length inches | Jaw Length, inches | Weight, lb (kg) |
|-----------|-----------------------|--------------------|-----------------|
| TH95BCP | 6 | 1-11/16 | 0.26 (0.12) |
| TH196ACF | 8 | 2-1/4 | 0.49 (0.22) |
| TH96CF | 8 | 2-1/4 | 0.51 (0.23) |
| TH97ACF | 8 | 3-3/16 | 0.49 (0.22) |



TH137ACF



THHL138ACP

Combination Slip Joint Pliers

| Stock No. | Description | Overall Length inches | Jaw Length inches | Weight, lbs (kg) |
|------------|--|-----------------------|-------------------|------------------|
| TH137ACF | Heavy-Duty Combination Slip Joint Pliers | 8-3/16 | 27/64 | 0.73 (0.33) |
| THHL138ACP | High-Leverage Combination | 7-7/8 | 1-1/16 | 0.66 (0.3) |



TH59AHL

Linesman's Pliers

| Stock No. | Jaw Width | Overall Length inches | Weight, lbs (kg) |
|-----------|-----------|-----------------------|------------------|
| TH59AHL | 1/2 | 9-1/2 | .066 (.30) |



THAWP120

Tongue and Groove

| Stock No. | Description | Overall Length, inches | Jaw Opening/Capacity | Jaw Positions | Weight, lbs (kg) |
|-----------|--------------------------------------|------------------------|----------------------|---------------|------------------|
| THAWP45 | Straight Serrated | 4-3/4 | 1/2 | 3 | 0.15 (0.07) |
| THAWP65 | Straight Serrated | 7 | 7/8 | 5 | 0.40 (0.18) |
| THAWP120 | Adjustable Joint Pliers, 12-3/4 Long | 12-3/4 | 2-3/16 | 7 | 1.57 (0.71) |
| THAWP160 | Straight Serrated | 16-3/4 | 3-3/16 | 8 | 3.03 (1.37) |



THLP7WR



THLP6LN



THLP10WR

Locking Pliers

| Stock No. | Description | Overall Length, inches | Jaw Opening/Capacity | Weight, lbs (kg) |
|-----------|---------------------------------------|------------------------|----------------------|------------------|
| THLP5WR | Locking Pliers - Curved Jaw w/cutter | 5 | 1-5/32 | 0.39 (0.18) |
| THLP7WR | Locking Pliers - Curved Jaw w/cutter | 7 | 1-5/8 | 0.84 (0.38) |
| THLP6LN | Locking Pliers - Long Nose | 6 | 2-1/8 | 0.44 (0.2) |
| THLP10WR | Curved Jaw with Cutter Locking Pliers | 10 | 2-7/16 | 1.41 (0.64) |

MISCELLANEOUS TOOLS



THPRH57A



TH29ACF

Interchangeable Tip/Convertible Pliers

| Stock No. | Overall Length inches | Ring Size Range, inches | Weight, lb (kg) |
|-----------|-----------------------|--------------------------------------|-----------------|
| THPRH56A | 6-3/8 | Internal 1/4-1; External 1/8-1 | 0.34 (0.15) |
| THPRH57A† | 8 | Internal 3/8-2; External 1/4-2 | 0.56 (0.25) |
| THPRC65A | 10 | Internal 1-13/64-4; External 1-1/3-4 | 1.22 (0.55) |

Terminal Crimping Pliers with Cutter

- Cold-formed heat treated rivet for smooth action and long life
- Precision machined joint and cutting edges, hardened wire cutter with “Knife to Anvil” design, never needs sharpening

| Stock No. | Description | Overall Length inches | Crimps | Weight, lbs (kg) |
|-----------|--------------------------------------|-----------------------|--|------------------|
| TH29ACF | Terminal Crimping Pliers with Cutter | 9-3/8 | 10, 12, 14, 16, 18, 20, 22 AWG Insulated and Non-Insulated | 0.80 (0.36) |



THPWC22B



THWTR1A



THPWC9CF

Wire Twister/Stripper

| Stock No. | Description | Overall Length, inches | Jaw Opening/Capacity | Weight, lbs (kg) |
|-----------|-------------------------|------------------------|----------------------|------------------|
| THWTR1A | Reversible Wire Twister | 8-3/4 | 0.041 | 0.61 (0.28) |

Wire Stripper

| Stock No. | Description | Overall Length inches | Strips AWG Sizes | Application | Weight, lbs (kg) |
|-----------|--|-----------------------|---|----------------------------|------------------|
| THPWC22B | Automatic Wire Stripper with Cutter | 7-1/4 | 12, 14, 16, 18, 20 | Strips PVC, THHN, and THWN | 0.26 (0.12) |
| THPWC9CF | Wire Stripper/Cutter/Crimper/Bolt Cutter | 8-3/4 | Stranded Wire: 8, 10 Solid Wire: 20, 16 | - | 1.00 (0.45) |



THPWC80A

Cable Cutter

| Stock No. | Description | Overall Length inches | Weight, lb (kg) |
|-----------|---|-----------------------|-----------------|
| THPWC80A | For cutting battery cables and other soft metal cables. Vinyl covered Handles | 7-1/2 | 0.57 (0.26) |



- Wear appropriate eye protection
- Be sure to use a lanyard that has more weight capacity than the tool you are attaching because drop forces are greater than actual tool weight.
- Any tool that weighs more than 5 pounds should be attached to an anchor point such as a work platform or utility bucket rather than the operator.
- Plastic coated handles on these pliers and cutters do not protect against electric shock
- †These products can expose you to chemicals which are known to the state of California to cause cancer and reproductive harm. See pages 906-907 for details.
- Read safety precautions on pages W1 to W4



MISCELLANEOUS TOOLS



THPBMP16A

Pry Bars - Multiposition

- Each pry bar features 17 incremental angles of 15° to provide great flexibility
- High leverage design with smooth radius head provides maximum leverage when lifting
- Manufactured from special alloy steel, precision-forged and heat-treated for strength and durability
- The industrial finish helps protect against corrosion

| Stock No. | Tip Width, inches | Length, inches | Weight, lb (kg) |
|-----------|-------------------|----------------|-----------------|
| THPBMP8A | 1/2 | 8 | 0.44 (0.2) |
| THPBMP12A | 5/8 | 12 | 1.07 (0.49) |
| THPBMP16A | 5/8 | 16 | 1.32 (0.6) |
| THPBMP24A | 1 | 24 | 3.56 (1.61) |
| THPBMP36A | 1 | 36 | 4.86 (2.2) |



THNPB124B

Miscellaneous Tethered Tools

- Slotted claw on “gooseneck” end and a chisel configuration

| Stock No. | Overall Length, inches | Sq. Stock, inches | Weight, lbs (kg) |
|-----------|------------------------|-------------------|------------------|
| THNPB124B | 24 | 3/4 | 3.35 (1.52) |



THSGF8R

Bastard Cut Individual Files

| Stock No. | Type | Cut | Length, inches | Weight, lbs (kg) |
|-----------|-------------------|-------|----------------|------------------|
| THSGF8R | Round Files | — | 8 | 0.26 (0.12) |
| THSGF8MA | Mill Files | — | 8 | 0.30 (0.14) |
| THSGF10MA | Mill Files | — | 10 | 0.55 (0.25) |
| THSGF6T | Three Square File | 5-1/2 | 6 | 0.22 (0.10) |



THHS50



THHS5A



THHSG319

Saws

| Stock No. | Description | Length, inches | Blade size | Weight, lb (kg) |
|-----------|---|----------------|------------|-----------------|
| THHS50 | Quick Cutter hand Saw – Includes 3 blades | — | — | 0.50 (0.23) |
| THHS5A | Mini-Hacksaw Frame | 8-1/4 | 10 (250) | 0.28 (0.13) |
| THHSG319 | Bi Mold Soft Grip Handle Hacksaw | 14-3/4 | 12 (305) | 1.25 (0.57) |

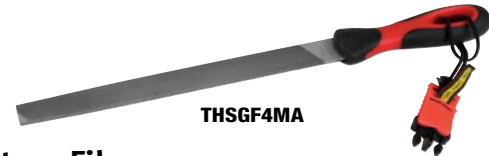

THSGF4MA

Miniature Files

| Stock No. | Description | Weight, lb (kg) |
|-----------|------------------------|-----------------|
| THSGF4MA | Hand | 0.14 (0.06) |
| THSGF4W | Warding | 0.10 (0.05) |
| THSGF4HR | Half Round | 0.10 (0.05) |
| THSGF4SQ | Square | 0.10 (0.05) |
| THSGF4R | Round | 0.10 (0.05) |
| THSGF4T | Triangular, Slim Taper | 0.10 (0.05) |



THCSA8C



THCSA12C

Scraper

| Stock No. | Description | Overall Length, inches | Blade Width, inches | Weight, lbs (kg) |
|-----------|-------------------------------------|------------------------|---------------------|------------------|
| THCSA8C | Rigid Carbon Scraper | 7-5/8 | 7/8 | 0.34 (0.15) |
| THCSA12C | 12-7/8" Rigid Carbon Scraper, Black | 12-7/8 | 1 | 0.495 (0.22) |



THPK53A



THPKB50A

Putty Knife/Scraper

- Full-length steel blades for strength and durability
- Soft molded rubber handles maximize handgrip, are easy to clean and resistant to most solvents
- Broad hilt design helps protect against hand slipping when scraping

| Stock No. | Blade Length, inches | Blade Width, inches | Blade Style | Weight, lb (kg) |
|-----------|----------------------|---------------------|--------------|-----------------|
| THPK53A | 3-19/32 | 1-1/4 | Stiff Chisel | 0.23 (0.1) |

Brass Putty Knives/Scrapers

- Spring tempered, solid brass blades are nonmarring, nonsparking, nonmagnetic and noncorrosive
- Soft molded rubber handles maximize hand grip, are easy to clean and are resistant to most solvents
- Broad hilt design helps protect against hand slipping when scraping
- Stiff blade style

| Stock No. | Handle Length, inches | Blade Length, inches | Blade Width, inches | Weight, lbs (kg) |
|-----------|-----------------------|----------------------|---------------------|------------------|
| THPKB50A | 4-7/8 | 3-1/2 | 2 | 0.26 (0.12) |
| THPKB52A | 4-7/8 | 3-19/32 | 1-1/4 | 0.23 (0.1) |
| THPKB53A | 4-7/8 | 3-19/32 | 1-1/4 | 0.25 (0.11) |



THFSN25100



THGA52B



THPCD2010247



THPPC5A



THTPMA25EM



THUTK100

Miscellaneous

| Stock No. | Description | Overall Length, inches | Weight, lbs (kg) |
|--------------|--|------------------------|------------------|
| THFSN25100 | Stabila 10" Torpedo Level | 10" | 1 (0.45) |
| THGA52B | Tools/Height Inspection Mirror, 1-3/16" x 1-1/2" | 10" | 0.2 (0.09) |
| THPCD2010247 | Tools/Height Flashlight Class 1 Division | 7-1/2" | 0.65 (0.29) |
| THPPC5A | 6-15/16" Punch/ Chisel Holder | 6-15/16 | 0.6 (0.27) |
| THTPMA25EM | Tape Measure | - | 1.45 (0.66) |
| THUTK100 | Retractable Knife | 7-1/4" | 0.513 (0.23) |
| THYA728A | Grease Gun, 6000 PSI Lever Type W/18" Hose | 9-3/16" | 4.14 (1.88) |



THYA728A



- Wear appropriate eye protection
- Be sure to use a lanyard that has more weight capacity than the tool you are attaching because drop forces are greater than actual tool weight.
- Any tool that weighs more than 5 pounds should be attached to an anchor point such as a work platform or utility bucket rather than the operator.
- Read safety precautions on pages W1 to W4



1000V TOOLS

Snap-on® Industrial Tools@Height™ POWER-SAFE tools comply with EN60900. They are tested to 10,000V and marked with the 1000V symbol. A sample of each type of tool from every production run is dropped tested, stripped-down, inspected and certified.

Strong, durable and high quality, Snap-on® POWER-SAFE pliers and cutters feature an isolated lanyard attachment point integrated with the handle.



THOEM17KV

Single Open-End Wrenches, Standard Handle, mm

| Stock No. | Description | Open End Width | Open End Depth | Length, inches | Weight, lbs |
|-----------|----------------------------------|----------------|----------------|----------------|-------------|
| THOEM6KV | 1000V Insulated Wrench 6mm, O/E | 5/8 | 7/32 | 5-9/16 | 0.1 |
| THOEM7KV | 1000V Insulated Wrench 7mm, O/E | 5/8 | 7/32 | 5-9/16 | 0.1 |
| THOEM8KV | 1000V Insulated Wrench 8mm, O/E | 13/16 | 5/16 | 6 | 0.1 |
| THOEM9KV | 1000V Insulated Wrench 9mm, O/E | 15/16 | 5/16 | 6-3/8 | 0.15 |
| THOEM10KV | 1000V Insulated Wrench 10mm, O/E | 1 | 5/16 | 6-3/4 | 0.15 |
| THOEM11KV | 1000V Insulated Wrench 11mm, O/E | 1-1/16 | 5/16 | 6-3/4 | 0.15 |
| THOEM12KV | 1000V Insulated Wrench 12mm, O/E | 1-1/8 | 5/16 | 7 | 0.2 |
| THOEM13KV | 1000V Insulated Wrench 13mm, O/E | 1-1/4 | 5/16 | 7 | 0.2 |
| THOEM14KV | 1000V Insulated Wrench 14mm, O/E | 1-3/8 | 5/16 | 7-3/8 | 0.2 |
| THOEM15KV | 1000V Insulated Wrench 15mm, O/E | 1-3/8 | 5/16 | 7-9/16 | 0.2 |
| THOEM16KV | 1000V Insulated Wrench 16mm, O/E | 1-1/2 | 3/8 | 7-7/8 | 0.3 |
| THOEM17KV | 1000V Insulated Wrench 17mm, O/E | 1-5/8 | 3/8 | 8-9/16 | 0.35 |
| THOEM18KV | 1000V Insulated Wrench 18mm, O/E | 1-5/8 | 3/8 | 8-9/16 | 0.35 |
| THOEM19KV | 1000V Insulated Wrench 19mm, O/E | 1-3/4 | 3/8 | 8-7/8 | 0.35 |



THXOM17KV

Single Box-End Wrenches, Standard Handle, mm

| Stock No. | Description | Open End Width | Open End Depth | Length, inches | Weight, lbs |
|-----------|-----------------------------|----------------|----------------|----------------|-------------|
| THXOM6KV | 1000V Insulated Wrench 6mm | 1/2 | 1/4 | 7-3/4 | 0.2 |
| THXOM7KV | 1000V Insulated Wrench 7mm | 9/16 | 3/8 | 8 | 0.2 |
| THXOM8KV | 1000V Insulated Wrench 8mm | 5/8 | 3/8 | 8-1/4 | 0.2 |
| THXOM9KV | 1000V Insulated Wrench 9mm | 11/16 | 3/8 | 8-1/4 | 0.2 |
| THXOM10KV | 1000V Insulated Wrench 10mm | 3/4 | 3/8 | 8-1/2 | 0.25 |
| THXOM11KV | 1000V Insulated Wrench 11mm | 13/16 | 3/8 | 8-1/2 | 0.25 |
| THXOM12KV | 1000V Insulated Wrench 12mm | 13/16 | 3/8 | 8-1/2 | 0.25 |
| THXOM13KV | 1000V Insulated Wrench 13mm | 15/16 | 13/32 | 8-1/2 | 0.3 |
| THXOM14KV | 1000V Insulated Wrench 14mm | 1 | 13/32 | 8-1/2 | 0.3 |
| THXOM15KV | 1000V Insulated Wrench 15mm | 1-1/16 | 15/32 | 9-1/2 | 0.35 |
| THXOM16KV | 1000V Insulated Wrench 16mm | 1-1/8 | 15/32 | 10 | 0.4 |
| THXOM17KV | 1000V Insulated Wrench 17mm | 1-3/16 | 1/2 | 10 | 0.45 |
| THXOM18KV | 1000V Insulated Wrench 18mm | 1-1/4 | 1/2 | 10-1/2 | 0.5 |
| THXOM19KV | 1000V Insulated Wrench 19mm | 1-5/16 | 9/16 | 10-1/2 | 0.55 |



THAWMCG8KV

T-Handle Hex Wrenches, mm

| Stock No. | Description | Length, inches | T-Handle Length, inches | Weight, lbs |
|-------------|---|----------------|-------------------------|-------------|
| THAWMCG3KV | 1000V Insulated T-Handle Hex Wrench, 3mm | 6 | 4-1/2 | 0.25 |
| THAWMCG4KV | 1000V Insulated T-Handle Hex Wrench, 4mm | 6 | 4-1/2 | 0.3 |
| THAWMCG5KV | 1000V Insulated T-Handle Hex Wrench, 5mm | 6 | 5-1/2 | 0.45 |
| THAWMCG6KV | 1000V Insulated T-Handle Hex Wrench, 6mm | 6 | 5-1/2 | 0.45 |
| THAWMCG8KV | 1000V Insulated T-Handle Hex Wrench, 8mm | 6 | 6-1/2 | 0.75 |
| THAWMCG10KV | 1000V Insulated T-Handle Hex Wrench, 10mm | 6 | 6-1/2 | 0.8 |



THAD12AKV

Adjustable Wrenches

| Stock No. | Description | Length, inches | Max Opening, inches | Weight, lbs |
|-----------|----------------------------|----------------|---------------------|-------------|
| THAD12AKV | 1000V 12" Adjustable Wire | 13-7/16 | 1-11/32 | 1.85 |
| THAD6AKV | 1000V 6" Adjustable Wrench | 7-1/2 | 25/32 | 0.4 |



TH862KV

Saws

| Stock No. | Description | OAL, inches | Weight, lbs |
|-----------|--------------------------------|-------------|-------------|
| TH862KV | 1000V Insulated Hacksaw | 20 | 1.75 |
| TH863KV | 1000V Insulated Junior Hacksaw | 11-1/2 | 0.4 |



TH863KV



THSD872kV



THSDP877kV

Screwdrivers

| Stock No. | Description | Tip Size inches | Shank Diameter | Blade Length inches | OAL inches | Weight lbs |
|------------|----------------------------------|-----------------|----------------|---------------------|------------|------------|
| THSD869kV | 1000V S/Driver 0.5 x 3.5 x 100mm | .020 x 1/8 | 3/16 | 3-3/4 | 6-3/4 | 0.5 |
| THSD870kV | 1000V S/Driver 0.8 x 4 x 75mm | .032 x 5/32 | 1/4 | 3-1/4 | 7-1/4 | 0.15 |
| THSD871kV | 1000V S/Driver 1.0 x 5 x 75mm | .040 x 3/16 | 1/4 | 3-1/4 | 7-1/2 | 0.15 |
| THSD872kV | 1000V S/Driver 1.2 x 6.5 x 125mm | .047 x 1/4 | 5/16 | 6 | 10 | 0.25 |
| THSD873kV | 1000V S/Driver 1.2 x 8 x 150mm | .047 x 5/16 | 5/16 | 6 | 10-1/2 | 0.35 |
| THSD874kV | 1000V S/Driver 1.6 x 10 x 200mm | .063 x 3/8 | 3/8 | 8-1/2 | 13-1/4 | 0.6 |
| THSDP875kV | 1000V S/Driver PH1 X 75mm | P1 | 1/4 | 3-1/4 | 7-1/4 | 0.15 |
| THSDP876kV | 1000V S/Driver PH2 x 100mm | P2 | 5/16 | 5 | 9 | 0.25 |
| THSDP877kV | 1000V S/Driver PH3 x 150mm | P3 | 3/8 | 6-1/2 | 10-3/4 | 0.35 |
| THSDZ878kV | 1000V S/Driver PZ1 X 75mm | PZ1 | 1/4 | 3-1/4 | 7-1/4 | 0.15 |
| THSDZ879kV | 1000V S/Driver PZ2 x 100mm | PZ2 | 5/16 | 5 | 9 | 0.25 |
| THSDZ880kV | 1000V S/Driver PZ3 x 150mm | PZ3 | 3/8 | 6-1/2 | 10-3/4 | 0.35 |



TH2619KV



TH497CFKV



TH57AHLPKV



TH59AHLPKV



TH807KV



TH84CFKV



THPWC14KV



THPWC80KV

Pliers

| Stock No. | Description | Number of Jaw Positions | Jaw Thickness, inches | Jaw Length, inches | Jaw Capacity, inches | OAL, inches | Weight, lbs |
|------------|------------------------------------|-------------------------|-----------------------|--------------------|----------------------|-------------|-------------|
| TH2619KV | 1000V 9"/250mm Waterpump | 7 | - | - | 2-1/2 | 11 | 0.9 |
| TH497CFKV | 1000V 90° Bent Nose Pliers | - | - | - | 2-5/8 | 8 | 0.65 |
| TH57AHLPKV | 1000V Lineman Pliers 7"/190mm | - | 1/2 | - | - | 9 | 0.85 |
| TH59AHLPKV | 1000V Linesman Pliers 9"/235mm | - | 1/2 | - | - | 10-3/4 | 1.35 |
| TH807KV | 1000V Wire Stripping Pliers | - | - | - | 10-22 AWG | 7-1/2 | 0.4 |
| TH84CFKV | 1000V Diagonal Cutters 7"/190mm | - | - | 3/8 | - | 5-5/8 | 0.3 |
| TH91ACPKV | 1000V Adjustable Pliers 9"/235mm | 5 | - | - | 1-3/8 | 10-3/4 | 1 |
| TH95CFKV | 1000V 5"/150mm Needle Nose Pliers | - | - | 1-11/16 | - | 7-1/2 | 0.4 |
| THPWC14KV | 1000V Wire Stripper/Cutter/Crimper | - | - | - | 8-22 AWG | 10 | 0.55 |
| THPWC80KV | 1000V Cable Cutters, 7"/190mm | - | - | - | - | 9 | 0.75 |

1000V Insulated Hammer

| Stock No. | Description | Length, inches | Tip Size, inches | Weight, lbs |
|------------|-------------------------------|----------------|------------------|-------------|
| THHBPT16KV | 1000V Insulated Hammer, 24 oz | 12-7/8 | 1-1/16 | 1.7 |



THHBPT16KV



- Wear appropriate eye protection
- Be sure to use a lanyard that has more weight capacity than the tool you are attaching because drop forces are greater than actual tool weight.
- Any tool that weighs more than 5 pounds should be attached to an anchor point such as a work platform or utility bucket rather than the operator.
- Do not use damaged 1000V tools
- Read safety precautions on pages W1 to W4





[Nous contacter :](#)

