

# Outils de rivetage – Bouterolles - Accessoires



AIRFRAME TOOLING FOR PRODUCTION & MAINTENANCE

RIVET TYPE CHART								
AN435 Button	AN430 Round	AN455 Brazier	AN456 Mod. Brazier	AN470 Universal	AN442 Flat	BACR 15FT Boeing Reduced Head	AN426 Countersunk	AN450 Semi-Tubular

Bouterolles							
SERIE	RIVET	SERIE	RIVET	SERIE	RIVET	SERIE	RIVET
ATI100A	AN470	ATI100A	BACR15FT	ATI104AF	FLUSH	ATI119	FLUSH
ATI101A	AN470	112MBC	BACR15FT	ATI105A	AN470	ATIST1111	FLUSH
ATI100AF	FLUSH	ST112MBC	BACR15FT	ATI105AF	FLUSH	ST1111	FLUSH
ATI101AF	FLUSH	ATI101A	BACR15FT	ATI106	FLUSH	ATI118	HUCK
ATI101B	AN470	1112MBR	BACR15FT	ATI107	FLUSH	ATI130	HI-SHEAR
ATI101B	FLUSH	ST1112MBR	BACR15FT	ATI110	FLUSH	ATI131	HI-SHEAR
ATI100A	AN430	JAT100A	JIFFY	ATI112	FLUSH		
ATI100A	AN435	JAT101A	JIFFY	ATI113	FLUSH		
ATI100A	AN455	ATI104A	AN470	ATI121	FLUSH		

Accessoires et Marteaux de rivetage			
ATI1206	STANDARD	ATI114C	RESSORT
ATI2165	HUCK	ATI115	RESSORT
ATI140	HI-SHEAR	ATI117	PROTECTION
ATI141	STANDARD	ATI124	EXTENSION
ATI595	ADAPTATEUR 90°	1111BV	ADAPTATEUR
ATI1757	AN470	ATI124	ADAPTATEUR
ATI1758	FLUSH	ATI269	JAUGE
ATI134	EXTENSION	ATI2612	JAUGE
ATIU	RIVET HAMMER	ATI590	SET
ATI17	JIFFY TYPE	ATI501	RIVET CUTTER

C de rivetage - Bouterolles pour C	
ATI108	AN470
ATI109	FLUSH
ATI108	BACR15FT
ATI108A33PC	SET
ATI108A16PC	SET
ATI501	ALLIGATOR
ATI502	C-YOKE
ATIU114	C PNEUMATIQUE

## RIVETING TOOLS AND ACCESSORIES

### RIVET SET CUPPING STANDARD FOR AN & MS RIVETS



Rivet set cups are machined to a larger radius than the maximum rivet head radius and are shallower in cup depth than the minimum thickness:

- (1) To allow for a slight upsetting of the head in forming the upset end.
- (2) To allow for a slight misalignment in holding the set on the rivet head without touching the riveted surface.

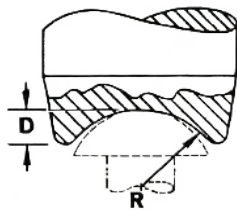

AN 430  
AN 435

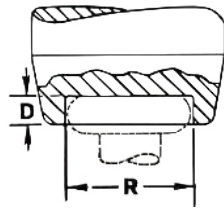

AN 442

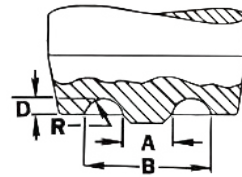

AN 450 MS 20450

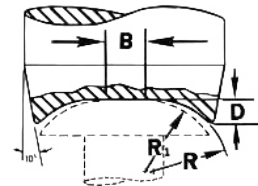

AN 470 MS 20470

Rivet Number	Rivet Type	DIM	RIVET SIZE							
			1/16"	3/32"	1/8"	5/32"	3/16"	1/4"	5/16"	3/8"
AN430	ROUND HEAD	R	.075	.112	.161	.184	.222	.298	.369	.445
		D	.031	.049	.068	.086	.104	.139	.162	.195
AN435 MS20435	BUTTON HEAD	R	.061	.095	.128	.160	.192	.256	.321	.382
		D	.040	.063	.084	.105	.126	.168	.206	.243
AN442	FLAT HEAD	R	.141	.204	.267	.333	.399	.530	.661	.792
		D	.014	.022	.032	.042	.052	.072	.092	.110
AN456	BRAZIER HEAD	R	-	.142	.213	.284	.354	.415	.567	.709
		D	-	.018	.030	.047	.057	.069	.094	.116
AN470 MS20470 MS20613 MS20615	UNIVERSAL HEAD	B	.041	.056	.072	.088	.103	.135	.166	.200
		D	.019	.027	.040	.049	.057	.077	.100	.122
		R	.070	.098	.124	.152	.180	.233	.288	.345
		R <sub>1</sub>	.054	.082	.108	.135	.164	.217	.272	.328
AN450 MS20450	THOMPSON HEAD (TUBULAR)		1/16"	3/32"	#40	1/8"	9/64"	3/16"	1/4"	
		A	.033	.055	.069	.082	.094	.130	.170	
		B	.110	.158	.160	.205	.258	.294	.366	
		R	.019	.026	.023	.031	.041	.041	.049	
		D	.014	.021	.023	.031	.041	.041	.045	



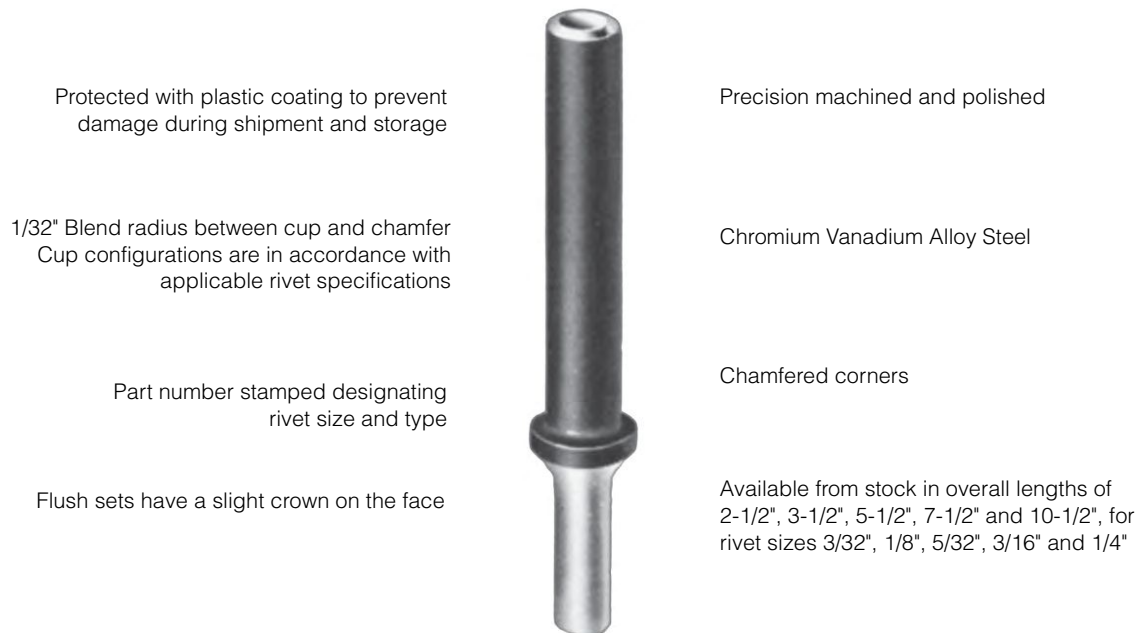



## COMPARE THE DIFFERENCE

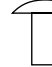

CAUTION: Power tools can cause flying particles.  
WEAR SAFETY GOGGLES (users and bystanders).  
WEAR HEARING PROTECTION. Power tools generate noise.

Beginning with a sound basic design, ATI rivet sets incorporate the ultimate in proper distribution of mass, with correct grain structure, made possible by the cold heading process. These factors along with correct heat-treating procedures eliminate breakage and provide for a structurally sound driven rivet.

Highly polished precision cups are held to exact tolerances, and shanks are CNC- machined and chamfered. Identifying symbols stamped on all sets show rivet size, type and tool number. The working surface of each unit is coated with clear plastic to prevent damage during shipment.

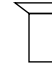
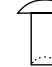
RIVET TYPE CHART								
								
AN435 Button	AN430 Round	AN455 Brazier	AN456 Mod. Brazier	AN470 Universal	AN442 Flat	BACR 15FT Boeing Reduced Head	AN426 Countersunk	AN450 Semi-Tubular

## RIVETING TOOLS AND ACCESSORIES

### STRAIGHT AND OFFSET RIVET SETS

\*Special rivet sets may be ordered by providing rivet size, type, length, and shank diameter.

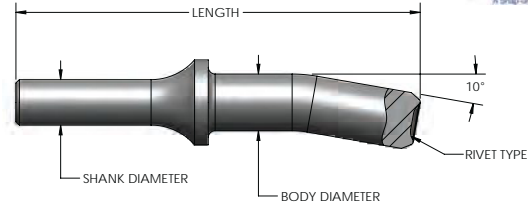
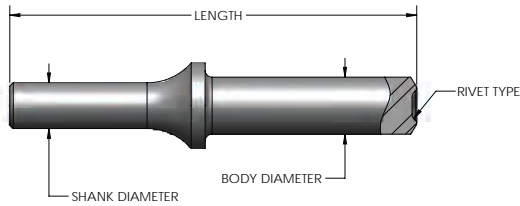

Rivet Size	Length	AN470 RIVET, .401 SHANK		
		Straight Drive Part Number	Offset Drive Part Number	Body Diameter
1/16"	3-1/2"	ATI100A31/16	ATI101A31/16	1/2"
3/32"	2-1/2"	ATI100A2-332	-	1/2"
	3-1/2"	ATI100A33/32	ATI101A33/32	1/2"
	5-1/2"	ATI100A53/32	ATI101A53/32	1/2"
	7-1/2"	ATI100A73/32	ATI101A73/32	1/2"
	10-1/2"	ATI100A8332	ATI101A8332	1/2"
	13-1/2"	ATI100A93/32	-	1/2"
1/8"	2-1/2"	ATI100A218	-	1/2"
	3-1/2"	ATI100A3-1/8	ATI101A3-1/8	1/2"
	5-1/2"	ATI100A51/8	ATI101A51/8	1/2"
	7-1/2"	ATI100A71/8	ATI101A71/8	1/2"
	10-1/2"	ATI100A818	ATI101A818	1/2"
	13-1/2"	ATI100A91/8	ATI101A91/8	1/2"
5/32"	2-1/2"	ATI100A2532	-	1/2"
	3-1/2"	ATI100A35/32	ATI101A35/32	1/2"
	5-1/2"	ATI100A55/32	ATI101A5-532	1/2"
	7-1/2"	ATI100A75/32	ATI101A75/32	1/2"
	10-1/2"	ATI100A8532	ATI101A8532	1/2"
	13-1/2"	ATI100A95/32	ATI101A95/32	1/2"
3/16"	2-1/2"	ATI100A2316	-	1/2"
	3-1/2"	ATI100A33/16	ATI101A3316	1/2"
	5-1/2"	ATI100A53/16	ATI101A53/16	1/2"
	7-1/2"	ATI100A73/16	ATI101A73/16	1/2"
	10-1/2"	ATI100A8316	ATI101A8316	1/2"
	13-1/2"	ATI100A93/16	ATI101A93/16	1/2"
7/32"	2-1/2"	ATI100A2732	-	1/2"
	3-1/2"	ATI100A37/32	ATI101A3732	1/2"
	5-1/2"	ATI100A57/32	ATI101A57/32	1/2"
	7-1/2"	ATI100A77/32	ATI101A77/32	1/2"
	10-1/2"	ATI100A8732	-	1/2"
1/4"	2-1/2"	ATI100A214	-	5/8"
	3-1/2"	ATI100A3-1/4	ATI101A3-1/4	5/8"
	5-1/2"	ATI100A514	ATI101A514	5/8"
	7-1/2"	ATI100A7-1/4	ATI101A7-1/4	5/8"
	10-1/2"	ATI100A814	-	5/8"
	13-1/2"	ATI100A9-1/4	ATI101A9-1/4	5/8"
FLUSH	2-1/2"	ATI100AF-2A	ATI101AF-2A	1/2"
	2-1/2"	ATI100AF-2B	ATI101AF-2B	5/8"
	3-1/2"	ATI100AF-3A	ATI101AF-3A	1/2"
	3-1/2"	ATI100AF-3B	ATI101AF-3B	5/8"
	5-1/2"	ATI100AF-5A	ATI101AF-5A	1/2"
	5-1/2"	ATI100AF-5B	ATI101AF-5B	5/8"
	7-1/2"	ATI100AF-7A	ATI101AF-7A	1/2"
	10-1/2"	ATI100AF8A	ATI101AF8A	1/2"
	13-1/2"	ATI100AF-9A	ATI101AF-9A	1/2"

Rivet Size	Length	AN470 RIVET, .498 SHANK	
		Straight Drive Part Number	Body Diameter
5/32"	3-1/2"	ATI100B35/32	5/8"
	5-1/2"	ATI100B55/32	5/8"
	7-1/2"	ATI100B75/32	5/8"
	10-1/2"	ATI100B8532	5/8"
	13-1/2"	ATI100B95/32	5/8"
3/16"	3-1/2"	ATI100B33/16	5/8"
	5-1/2"	ATI100B53/16	5/8"
	7-1/2"	ATI100B73/16	5/8"
	10-1/2"	ATI100B8316	5/8"
	13-1/2"	ATI100B93/16	5/8"
7/32"	3-1/2"	ATI100B37/32	5/8"
	5-1/2"	ATI100B57/32	5/8"
	7-1/2"	ATI100B77/32	5/8"
1/4"	10-1/2"	ATI100B8732	5/8"
	3-1/2"	ATI100B3-1/4	5/8"
	5-1/2"	ATI100B514	5/8"
	7-1/2"	ATI100B7-1/4	5/8"
	10-1/2"	ATI100B814	5/8"
FLUSH	13-1/2"	ATI100B9-1/4	5/8"
	3-1/2"	ATI100BF-3B	5/8"
	5-1/2"	ATI100BF-5B	5/8"
	7-1/2"	ATI100BF-7B	5/8"

Rivet Size	Length	AN470 RIVET, .498 SHANK	
		Offset Drive Part Number	Body Diameter
1/4"	3-1/2"	ATI101B3-1/4	5/8"
	5-1/2"	ATI101B514	5/8"

Rivet Size	Length	AN430 RIVET, .401 SHANK		AN435 RIVET, .401 SHANK		AN455 RIVET, .401 SHANK	
		Part Number	Body Dia.	Part Number	Body Dia.	Part Number	Body Dia.
3/32"	3-1/2"	ATI100A3332A	1/2"	ATI100A3332B	1/2"	ATI100A3332E	1/2"
1/8"		ATI100A31/8A	1/2"	ATI100A31/8B	1/2"	ATI100A31/8E	1/2"
5/32"		ATI100A3532A	1/2"	ATI100A3532B	1/2"	ATI100A3532E	1/2"
3/16"		ATI100A3316A	1/2"	ATI100A3316B	1/2"	ATI100A3316E	1/2"
1/4"		ATI100A31/4A	5/8"	ATI100A31/4B	5/8"		
	7-1/2"	ATI100A71/4A	5/8"				



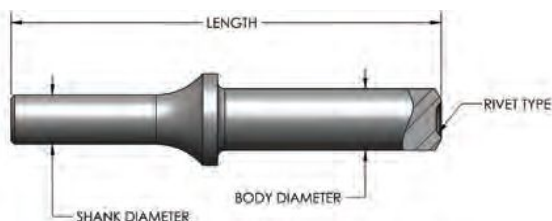

### STRAIGHT RIVET SETS FOR MODIFIED UNIVERSAL HEAD RIVETS, .401 SHANK

Rivet Size	Length	BACR15FT RIVET	
		Part Number	Body Diameter
3/32"	3-1/2"	ATI100A3332F	1/2"
	5-1/2"	ATI100A5332F	1/2"
1/8"	2-1/2"	ATI100A21/8F	1/2"
	3-1/2"	ATI100A31/8F	1/2"
5/32"	2-1/2"	ATI100A2532F	1/2"
	3-1/2"	ATI100A3532F	1/2"
3/16"	2-1/2"	ATI100A2316F	1/2"
	3-1/2"	ATI100A3316F	1/2"
7/32"	2-1/2"	ATI100A2732F	1/2"
	3-1/2"	ATI100A3732F	1/2"
1/4"	2-1/2"	ATI100A21/4F	5/8"
	3-1/2"	ATI100A31/4F	5/8"

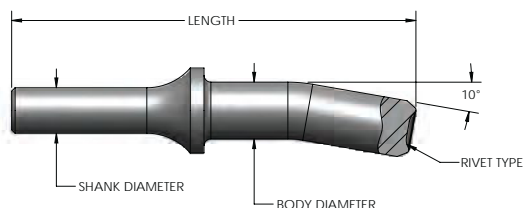

### OFFSET RIVET SETS FOR MODIFIED UNIVERSAL HEAD RIVETS, .401 SHANK

Rivet Size	Length	BACR15FT RIVET	
		Part Number	Body Diameter
1/8"	3-1/2"	ATI101A31/8F	1/2"
	5-1/2"	ATI101A518F	1/2"
5/32"	3-1/2"	ATI101A3532F	1/2"
	5-1/2"	ATI101A5532F	1/2"
3/16"	3-1/2"	ATI101A3316F	1/2"
	5-1/2"	ATI101A5316F	1/2"
7/32"	3-1/2"	ATI101A3732F	1/2"
	5-1/2"	ATI101A5732F	1/2"
1/4"	3-1/2"	ATI101A31/4F	5/8"
	5-1/2"	ATI101A514F	5/8"

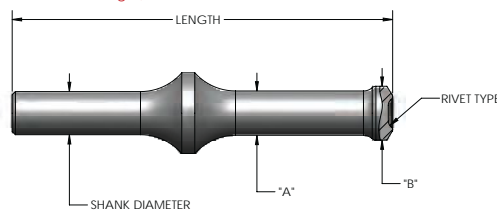

### STRAIGHT RIVET SETS FOR MODIFIED UNIVERSAL HEAD RIVETS, .401 SHANK

Manufactured from H13 material and magnetic particle tested

Rivet Size	Part Number	BACR15FT RIVET			
		Reference	Dimension "A"	Dimension "B"	Length
1/8"	1112MBC4014	ST1112MB-C401-4	.280	.280	3.31"
	ST1112BC453	ST1112B-C401-4-53	.281	.437	3.31"
5/32"	1112MBC4015	ST1112MB-C401-5	.310	.350	3.31"
	1112MBC401A5	ST1112MB-C401A-5	.310	.310	3.31"
3/16"	1112MBC4016	ST1112MB-C401-6	.340	.410	3.31"
	1112MBC401A6	ST1112MB-C401A-6	.340	.368	3.31"
7/32"	1112MBC4017	ST1112MB-C401-7	.380	.480	3.31"
	1112MBC401A7	ST1112MB-C401A-7	.380	.406	3.31"
1/4"	1112MBC4018	ST1112MB-C401-8	.410	.540	3.31"
	1112MBC401A8	ST1112MB-C401A-8	.410	.482	3.31"
9/32"	1112MBC4019	ST1112MB-C401-9	.440	.610	3.31"

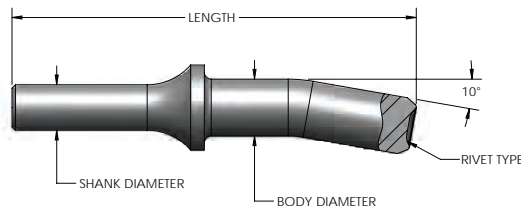

### OFFSET RIVET SETS FOR MODIFIED UNIVERSAL HEAD RIVETS, .401 SHANK

Manufactured from H13 material and magnetic particle tested

Rivet Size	Length	Part Number	BACR15FT RIVET	
			Reference	Body Diameter
1/8"	3-1/2"	1112MBR40143	ST1112MB-R401-4-3	.375
5/32"	3-1/2"	1112MBR40153	ST1112MB-R401-5-3	.410
	5-1/2"	1112MBR40155	ST1112MB-R401-5-5	.410
3/16"	3-1/2"	ST1112MBR63	ST1112MB-R401-6-3	.480
	5-1/2"	*ST1112MBR611	ST1112MB-R401C-611	.560
7/32"	3-1/2"	1112MBR40173	ST1112MB-R401-7-3	.560
	5-1/2"	1112MBR40175	ST1112MB-R401-7-5	.560
1/4"	3-1/2"	1112MBR40183	ST1112MB-R401-8-3	.610

\*ST1112MBR611 has 20° offset

## RIVETING TOOLS AND ACCESSORIES

### JIFFY TYPE RIVET SETS , GOOSENECKS, AND DOUBLE OFFSETS

\*Special Jiffy sets may be ordered by providing rivet size, type, length, and shank diameter.

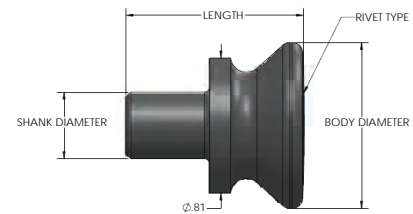
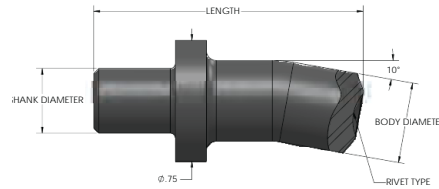
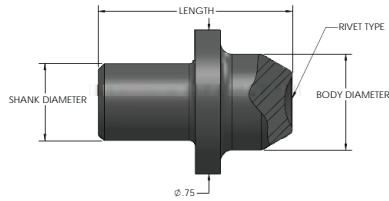

#### STRAIGHT JIFFY SETS

Part Number	Rivet Size	Rivet Type	Length	Body Diameter	Shank Diameter
JAT100AF-1A	FLUSH	FLUSH	1"	1/2"	.401
JAT119A-2B	FLUSH	FLUSH	2-1/8"	1" FACE	.401
JAT100A1332	3/32"	AN470	1"	1/2"	.401
JAT100A118	1/8"	AN470	1"	1/2"	.401
JAT100A1532	5/32"	AN470	1"	1/2"	.401
JAT100A1316	3/16"	AN470	1"	1/2"	.401

#### OFFSET JIFFY SETS

Part Number	Rivet Size	Rivet Type	Length	Body Diameter	Shank Diameter
JAT101A1332	3/32"	AN470	1-5/8"	1/2"	.401
JAT101A118	1/8"	AN470	1-5/8"	1/2"	.401
JAT101A1532	5/32"	AN470	1-5/8"	1/2"	.401
JAT101A1316	3/16"	AN470	1-5/8"	1/2"	.401

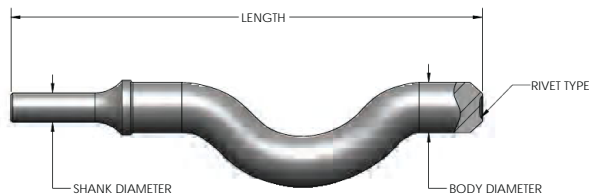

#### GOOSENECK RIVET SETS

Part Number	Rivet Size	Rivet Type	Length	Body Diameter	Shank Diameter
ATI104AF	FLUSH	FLUSH	6-5/8"	.69	.401
ATI104A-1/16	1/16"	AN470	6-5/8"	.69	.401
ATI104A-3/32	3/32"	AN470	6-5/8"	.69	.401
ATI104A-1/8	1/8"	AN470	6-5/8"	.69	.401
ATI104A-5/32	5/32"	AN470	6-5/8"	.69	.401
ATI104A-3/16	3/16"	AN470	6-5/8"	.69	.401
ATI104A-7/32	7/32"	AN470	6-5/8"	.69	.401
ATI104A-1/4	1/4"	AN470	6-5/8"	.69	.401

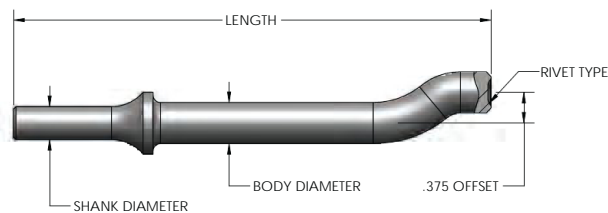

#### DOUBLE OFFSET RIVET SETS

Part Number	Rivet Size	Rivet Type	Length	Body Diameter	Shank Diameter
ATI105AF	FLUSH	FLUSH	5-3/4"	1/2"	.401
ATI105A-1/16	1/16"	AN470	5-3/4"	1/2"	.401
ATI105A-3/32	3/32"	AN470	5-3/4"	1/2"	.401
ATI105A-1/8	1/8"	AN470	5-3/4"	1/2"	.401
ATI105A-5/32	5/32"	AN470	5-3/4"	1/2"	.401
ATI105A-3/16	3/16"	AN470	5-3/4"	1/2"	.401
ATI105A-7/32	7/32"	AN470	5-3/4"	1/2"	.401
ATI105A-1/4	1/4"	AN470	5-3/4"	1/2"	.401
ATI105A-9/32	9/32"	AN470	5-3/4"	1/2"	.401





### FLUSH RIVET SET, SWIVEL-TYPE

Performs high-speed flush riveting on flat or curved surfaces and is designed for ease of handling, with a swivel action to produce quick alignment. The highly polished rivet set head is enclosed in a rubber sleeve.

Part Number	Face Diameter	Length	Shank Diameter
ATI106A	1-1/4"	3-1/2"	.401
ATI106B	1-1/4"	3-1/2"	.498

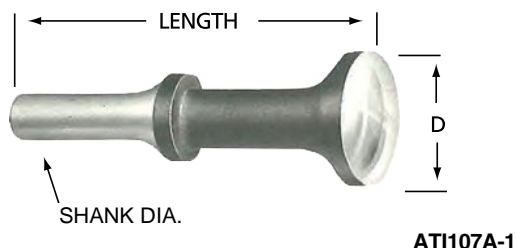

### FLUSH RIVET SET

Large radii at critical points enable this rivet set to withstand continuous rugged use. Where a smooth skin surface is essential, this rivet set, with its slightly crowned and highly polished face, will perform rapid flush riveting.

Part Number	Face Diameter	Length	Shank Diameter
ATI107A-1	1"	2-3/4"	.401
ATI107A-2	1-1/4"	2-3/4"	.401
ATI107A-3	1-1/4"	3-1/2"	.401
ATI107A-4	1"	5-1/2"	.401
ATI107A-6	1"	7-1/2"	.401
ATI107A-7	1-1/4"	7-1/2"	.401
ATI107B-1	1"	3"	.498
ATI107B-2	1-1/4"	3"	.498
ATI107B3	1-1/4"	3-1/2"	.498
ATI107B-4	1"	5-1/2"	.498
ATI107B-5	1-1/4"	5-1/2"	.498
ATI107B-6	1"	7-1/2"	.498
ATI107B-7	1-1/4"	7-1/2"	.498

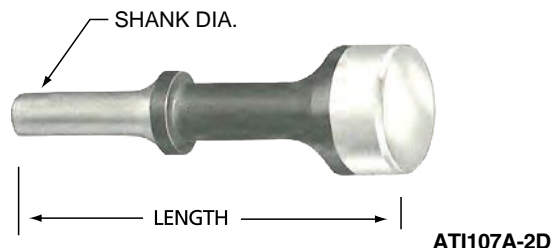

### PEENING TOOL WITH ALUMINUM, BRASS, OR NYLON INSERT

This peening tool is designed for the straightening of aluminum sheet after forming.

Part Number	Head Material	Face Diameter	Length	Shank Diameter
ATI107A-2D	Aluminum	1"	3-1/8"	.401
ATI107A2DB	Brass	1"	3-1/8"	.401
ATI107A2DN	Nylon	1"	3-1/8"	.401
ATI107B-2D	Aluminum	1"	3-1/8"	.498

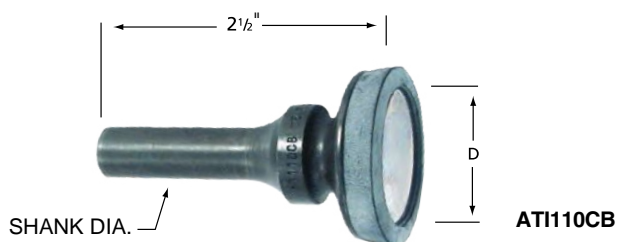

### FLUSH RIVET SET WITH RUBBER GUARD

A rubber guard added to this flush rivet set helps prevent slippage and damage to skin surface.

Part Number	Face Diameter	Length	Shank Diameter
ATI110CA	3/4"	2-1/2"	.401
ATI110CB	1"	2-1/2"	.401
ATI110CC	1-1/4"	2-1/2"	.401



### FLUSH RIVET SET, MUSHROOM TYPE

This convex crowned, flush rivet set is particularly adapted to riveting thin sections without danger of denting or dishing skin surface.

Part Number	Face Diameter	Length	Shank Diameter
ATI112A	1-7/8"	3"	.401
ATI112B	1-7/8"	3"	.498



## RIVETING TOOLS AND ACCESSORIES

### FLUSH RIVET SETS

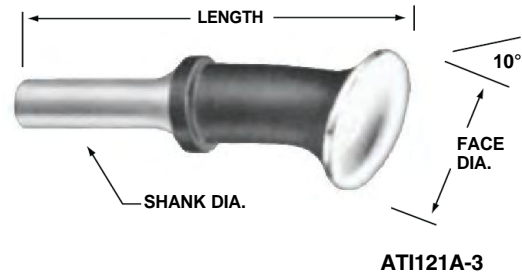

#### FLUSH RIVET SET, EXTRA SHORT

The unique design of this extra-short flush set enables it to withstand extremely rugged use. A mirror-polished, crown-working surface prevents damage to the skin.

Part Number	Face Diameter	Length	Shank Diameter
AT1113A-1	3/4"	1-11/16"	.401
AT1113A-2	1"	1-13/16"	.401
AT1113A-3	1-1/4"	1-13/16"	.401
*AT1113A2SPCR	1"	1-13/16"	.401

\*Increased crown height



#### FLUSH RIVET SET, STUBBY TYPE

Part Number	Face Diameter	Length	Shank Diameter
AT1119A-1B	3/4"	2-1/8"	.401
AT1119A-2B	1"	2-1/8"	.401
AT1119A-3B	1-1/8"	2-1/8"	.401
AT1119A4B	1-1/4"	2-1/8"	.401
AT1119B-1B	3/4"	2-1/8"	.498
AT1119B-2B	1"	2-1/8"	.498
AT1119B-3B	1-1/8"	2-1/8"	.498
AT1119B-4B	1-1/4"	2-1/8"	.498

#### FLUSH SET FOR LIMITED ACCESS ST1111BP401K

Heat-treated and polished to a mirror finish. The perfect tool for those hard-to-reach riveting applications

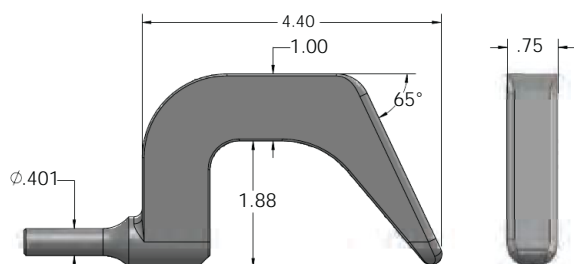

#### FLUSH RIVET SET, OFFSET

Part Number	Face Diameter	Length	Shank Diameter
AT1121A-3	1-1/4"	3-1/2"	.401
AT1121A-4	1"	5-1/2"	.401
AT1121A-5	1-1/4"	5-1/2"	.401
AT1121A-6	1"	7-1/2"	.401
AT1121A-7	1-1/4"	7-1/2"	.401
AT1121B-3	1-1/4"	3-1/2"	.498
AT1121B-4	1"	5-1/2"	.498
AT1121B-5	1-1/4"	5-1/2"	.498
AT1121B-6	1"	7-1/2"	.498
AT1121B-7	1-1/4"	7-1/2"	.498



AT1121A-3

#### FLUSH RIVET SET, POLYURETHANE RIM

Manufactured from H-13 material tool steel, this flush set is magnetic particle tested after heat treat, and shot-peened for stress relief prior to polish. The machine crown and polyurethane rim make this a preferred set ideal for skin work.

Part Number	Face Diameter	Length	Shank Diameter	Reference
AT1121B-3	1-1/4"	3-1/2"	.498	ST1111B-V401K-1
AT1121B-4	1"	5-1/2"	.498	ST1111B-V401K-2
AT1121B-5	1-1/4"	5-1/2"	.498	ST1111B-V401K-3
ST1111BV48E1	3/4"	2-1/2"	.498	ST1111B-V498E-1
ST1111BV48E2	1"	2-1/2"	.498	ST1111B-V498E-2
ST1111BV48E3	1-1/4"	2-1/2"	.498	ST1111B-V498E-3
ST1111BVR1	Rim, Replacement, Polyurethane			ST1111B-VR-1
ST1111BVR2	Rim, Replacement, Polyurethane			ST1111B-VR-2
ST1111BVR3	Rim, Replacement, Polyurethane			ST1111B-VR-3







### STRAIGHT DRIVE SETS FOR HUCK® LOCKBOLTS

Developed to drive Huck® lockbolt collars. The ATI118M Series tools are precision machined with close tolerance cavities.

Part Number	Lockbolt Size	Length	Shank Diameter
ATI118M3-L5	5/32"	3-1/2"	.401
ATI118M3-L6	3/16"	3-1/2"	.401
ATI118M3L8	1/4"	3-1/2"	.401
ATI118M-5-L5	5/32"	5-1/2"	.401



### OFFSET DRIVE SETS FOR HUCK® LOCKBOLTS

Developed to drive Huck® lockbolt collars. The ATI118D Series tools are precision machined with close tolerance cavities and 10° offset.

Part Number	Lockbolt Size	Length	Shank Diameter
ATI118D3-L4	1/8"	3-1/2"	.401
ATI118D3-L5	5/32"	3-1/2"	.401
ATI118D3-L6	3/16"	3-1/2"	.401
ATI118D3L8	1/4"	3-1/2"	.401

### SQUEEZER SET FOR HUCK® LOCKBOLTS

Held to an extremely close tolerance, with a mirror polished cavity, this squeezer set is ideal for fast, accurate swaging of Huck® lockbolt collars.

Part Number	Lockbolt Size	Length	"D"	Shank Diameter
ATI118AL5	5/32"	1/2"	1/2"	.187
ATI118AL6	3/16"	5/8"	9/16"	.187
ATI118AL8	1/4"	1"	5/8"	.187

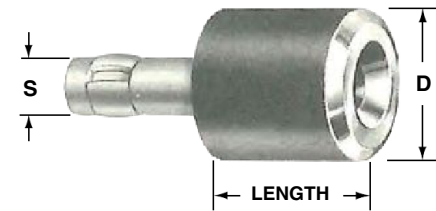

### STRAIGHT DRIVE SETS FOR HI-SHEAR® RIVETS, .401 SHANK

Engineered to drive Hi-Shear® rivet collars in open areas.

Rivet Size	Length	Part Number	Body Diameter
1/8"	3-1/2"	ATI130A318	1/2"
	5-1/2"	ATI130A51/8	1/2"
	7-1/2"	ATI130A71/8	1/2"
5/32"	3-1/2"	ATI130A3532	1/2"
	5-1/2"	ATI130A55/32	1/2"
	7-1/2"	ATI130A75/32	1/2"
3/16"	3-1/2"	ATI130A3316	1/2"
	5-1/2"	ATI130A53/16	1/2"
	7-1/2"	ATI130A73/16	1/2"
1/4"	3-1/2"	ATI130A3-1/4	5/8"
	5-1/2"	ATI130A51/4	5/8"



### OFFSET DRIVE SETS FOR HI-SHEAR® RIVETS, .401 SHANK

Engineered to drive Hi-Shear® rivet collars in open areas and when offset riveting is required.

Rivet Size	Length	Part Number	Body Diameter
1/8"	3-1/2"	ATI131A318	1/2"
	5-1/2"	ATI131A518	1/2"
5/32"	3-1/2"	ATI131A3532	1/2"
	5-1/2"	ATI131A5532	1/2"
3/16"	3-1/2"	ATI131A3316	1/2"
	5-1/2"	ATI131A5316	1/2"
1/4"	3-1/2"	ATI131A314	5/8"
	5-1/2"	ATI131A514	5/8"



**SAFETY PRECAUTION:** Read and follow all safety and operating instructions.  
**WARNING:** Face & eye protection must be worn while operating power tools, per ANSI B186.1

## RIVETING TOOLS AND ACCESSORIES

### CHISELS AND KNOCK-OUT PUNCHES



ATI1206-6



ATI2165-2

#### FLAT CHISEL, GUN TYPE

Part Number	Length	Shank Diameter
ATI1206-6	6-3/4"	.401
ATI1206-8	8"	.401
ATI1206-10	10"	.401
ATI1206-12	12"	.401

#### GUN TYPE CHISEL FOR HUCK® LOCKBOLTS

Part Number	Lockbolt Size	Length	Shank Diameter
ATI2165-2	5/32"	5-1/2"	.401
ATI2165-3	3/16"	5-1/2"	.401
ATI2165-4	1/4"	5-1/2"	.401
ATI2165-5	5/16"	5-1/2"	.401
ATI2165-6	3/8"	5-1/2"	.401



Hi-Shear® Knockout Punch



Standard Knockout Punch

#### KNOCK-OUT PUNCH, HI-SHEAR®

Part Number	Rivet Size	Length	Shank Diameter
ATI140A-3	3/32"	3-1/2"	.401
ATI140A341/4	3/32"	4-1/4"	.401
ATI140A-3MM	3MM	3-1/2"	.401
ATI140A-4	1/8"	3-1/2"	.401
ATI140A441/4	1/8"	4-1/4"	.401
ATI140A-5	5/32"	3-1/2"	.401
ATI140A541/4	5/32"	4-1/4"	.401
ATI140A-6	3/16"	3-1/2"	.401
ATI140A641/4	3/16"	4-1/4"	.401
ATI140A-5MM	5MM	3-1/2"	.401
ATI140A-6MM	6MM	3-1/2"	.401
ATI140A-8	1/4"	3-1/2"	.401
ATI140A841/4	1/4"	4-1/4"	.401
ATI140A-10	5/16"	3-1/2"	.401
ATI140A-12	3/8"	4-1/2"	.401
ATI140B-6	3/16"	3-1/2"	.498
ATI140B-8	1/4"	3-1/2"	.498
ATI140B-10	5/16"	3-1/2"	.498
ATI140B-12	3/8"	4-1/2"	.498

#### KNOCK-OUT PUNCH, STANDARD

Part Number	Rivet Size	Length	Shank Diameter
ATI141A33/32	3/32"	3-1/2"	.401
ATI141A31/8	1/8"	3-1/2"	.401
ATI141A35/32	5/32"	3-1/2"	.401
ATI141A33/16	3/16"	3-1/2"	.401
ATI141A37/32	7/32"	3-1/2"	.401
ATI141A31/4	1/4"	3-1/2"	.401
ATI141A35/16	5/16"	3-1/2"	.401
ATI141A33/8	3/8"	3-1/2"	.401
ATI141B33/16	3/16"	3-1/2"	.498
ATI141B31/4	1/4"	3-1/2"	.498
ATI141B35/16	5/16"	3-1/2"	.498
ATI141B33/8	3/8"	3-1/2"	.498



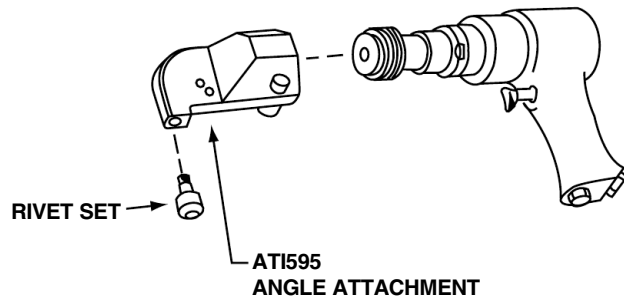

#### 90° RIVET HAMMER ANGLE ATTACHMENT ATI595 SERIES

A production aid for driving rivets in extremely hard-to-reach places. This 90° tool is a small, compact rivet gun attachment weighing only 16 oz. complete. It has 5/32" rivet capacity and uses ATI standard ATI1757 and ATI1758 Series rivet sets. Using the standard short set, this tool will reach into an opening 2-1/2" high.



Part Number	Shank Diameter	Thread Pitch (TPI)	For Use With:
ATI595B	.401	7	Ingersoll-Rand, Jiffy, Sioux
ATI595C	.401	8	ATI, Cleco, Chicago Pneumatic
ATI595BK	Angle attachment set includes ATI595B and 4 rivet sets in <b>blue</b> below		
ATI595CK	Angle attachment set includes ATI595C and 4 rivet sets in <b>blue</b> below		

#### RIVET SETS, CUPPED-TYPE ATI1757 SERIES

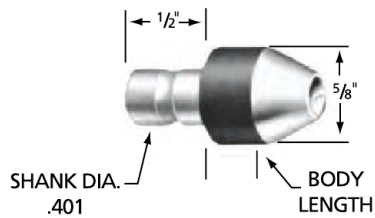

#### RIVET SETS, FLUSH-TYPE ATI1758 SERIES

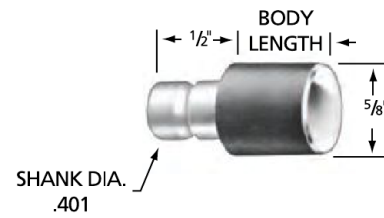

Part Number	Rivet Size	Rivet Type	Body Length	Shank Diameter
ATI1757AP332	3/32"	AN470	1/4"	.401
ATI1757AP1/8	1/8"	AN470	1/4"	.401
ATI1757AP532	5/32"	AN470	1/4"	.401
ATI1757AP316	3/16"	AN470	1/4"	.401
ATI1758AP	FLUSH	FLUSH	1/4"	.401
ATI1758AR	FLUSH	FLUSH	3/8"	.401
ATI1758AS	FLUSH	FLUSH	1/2"	.401

Included in ATI595BK and ATI595CK Sets

#### GOOSENECK-TYPE ADAPTER AND EXTENSION

##### ATI134GA

Originally designed for interchangeable inserts for Hi-Shear® collars, this unique adapter also accommodates Jiffy sets, ATI1757 & ATI1758 Series rivet sets, and standard .401 shank diameter rivet sets.



## RIVETING TOOLS AND ACCESSORIES

### RIVET HAMMERS



#### RIVET HAMMERS

- Aluminum offset pistol grip
- Teasing trigger for precise control
- Includes air flow valve, beehive spring, and quick-release retainer spring

Part Number	Aluminum Rivet Capacity	Steel Rivet Capacity	BPM	Length	Weight	Shank Diameter
ATIU-2X	5/32"	3/32"	2580	6-1/2"	2.25 lbs.	.401
ATIATC3X	3/16"	5/32"	2160	7-1/4"	2.25 lbs.	.401
ATIATC4X	1/4"	3/16"	1740	8-1/4"	2.75 lbs.	.401
ATIU5X	9/32"	3/16"	1560	8-1/4"	4.75 lbs.	.498
ATIU-7X	3/8"	5/16"	900	11-1/4"	6.00 lbs.	.498
ATIATU-9X	5/16"	1/4"	1140	9-1/4"	5.12 lbs.	.498



#### JIFFY TYPE RIVET HAMMERS

Use JAT100A and JAT101A Series Jiffy type rivet sets

Part Number	Aluminum Rivet Capacity	Steel Rivet Capacity	BPM	Length	Weight	Shank Diameter
ATI17-100B	5/32"	1/8"	2850	3-3/4"	2.25 lbs.	.401
ATI17-200B	3/16"	5/32"	2700	4-1/4"	2.62 lbs.	.401



## RETAINER SPRINGS

#### ATI114C-3 QUICK RELEASE

- Fast thumb release to quickly change rivet sets
- Works with any 3x or 4x rivet hammer
- Accommodates 1/2" or 9/16" body diameter rivet sets



#### ATI115 BEEHIVE TYPE

Fixed type retainer spring for maximum safety.

ATI115A	For 1/2" body diameter rivet sets
ATI115B	For 5/8" body diameter rivet sets



The two types of rivet shields illustrated have been designed to provide additional skin protection when flush riveting. Both units are manufactured with heat-treated and polished faces.

Part Number	Shield Diameter
ATI117R	2"
ATI117RB-3	2" with 1/2" cut-away relief

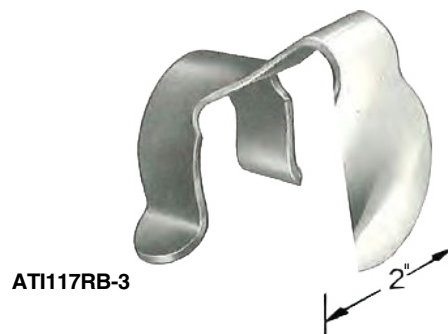
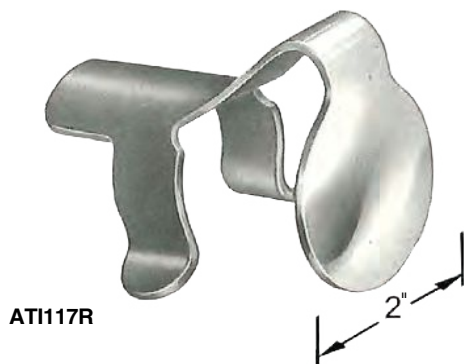

### RIVET SET EXTENSION ADAPTER

.401 Shank; .401 Recess

Part Number	OAL
ATI124A-4	4"
ATI124A-6	6"
ATI124A-12	12"



### SHANK ADAPTERS



#### 1111BV41V498

This sleeve nests in the barrel of the rivet hammer, easily converting .498 bore diameter to .401.



#### ATI124B-3

Converts .401 shank rivet sets to .498. Use 5X, 9X, and 7X guns with .401 tools.

### GRIP GAUGES

#### ATI269C3 & ATI2612

Simple, self-explanatory gauges determine material thickness and proper rivet grip length.





## RIVETING TOOLS AND ACCESSORIES

### SHEET-METAL TOOL KITS AND RIVET CUTTERS



These kits provide the essentials for straight and offset riveting. Ideal for structural and sheet-metal technicians, home builders, and students. Plastic zipped carrying case for tool control and FOD prevention.

<b>ATI590RGK3X</b>	<b>WITH ATIATC3X RIVET GUN</b>
<b>ATI590RGK-4X</b>	<b>WITH ATIATC4X RIVET GUN</b>

Kit includes:

1	RIVET HAMMER	1	ATI101AF-3A
1	ATI100A33/32	1	ATI107A-2
1	ATI100A3-1/8	1	ATI110CB
1	ATI100A35/32	1	ATI114C-3
1	ATI100A33/16	1	ATI638
1	ATI101A33/32	1	ATI647
1	ATI100A3-1/8	1	ATI670
1	ATI101A35/32	1	ATI681
1	ATI101A3316	1	A-1142 (oil)



**ATI590RGK4X**  
Clear zipper case included

<b>ATI590SMKSP1</b>	<b>WITH SIOUX 270 RIVET GUN</b>
<b>ATI590SMKSP6</b>	<b>WITH ATIATC4X RIVET GUN</b>

- Four straight AN470 universal rivet sets (3/32", 1/8", 5/32", 3/16")
- One flush rivet set
- Four integral pilot countersinks (#10, #21, #30, #40) pilot sizes
- Microstop-ball bearing
- Hand rivet cutter
- Rivet hammer (see chart)
- Four spring tension u-clamps
- 12 Each (3/32", 1/8", 5/32", 3/16") temporary fasteners
- Sioux 1410 drill
- Jobber drills- 3/32", 1/8", 5/32", 3/16", #40, #30, #21, #10
- Drill stops- #10, #21, #30, #40
- Sheet holder pliers
- Bucking Bar
- Retainer spring-quick release



**ATI590SMKSP1**



#### ATI501R

This rivet cutter is designed to quickly and easily shear aluminum rivets. It is adjustable for 1/4" to 3/4" long rivets in 1/16" increments, for rivet sizes 3/32", 1/8", 5/32", 3/16", 7/32", and 1/4".



#### ATI501S

This rivet cutter, with 13" tubular handles for additional leverage, was developed for the U.S. Government.





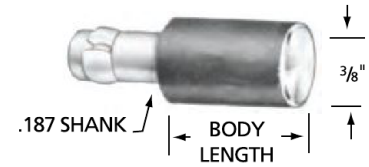
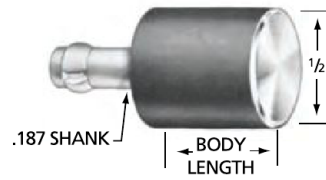
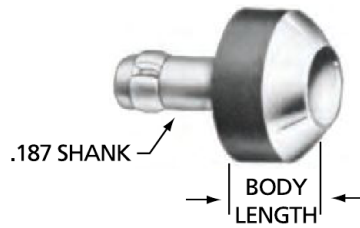

Rivet Size	Rivet Type	Body Diameter	Shank Diameter	1/8" BODY LENGTH	1/4" BODY LENGTH	3/8" BODY LENGTH	1/2" BODY LENGTH	5/8" BODY LENGTH	3/4" BODY LENGTH
3/32"	AN470	3/8"	.187	ATI108AN3/32	ATI108AP3/32	ATI108AR3/32	ATI108AS3/32	ATI108AT3/32	ATI108AW3/32
1/8"	AN470	3/8"	.187	ATI108AN1/8	ATI108AP1/8	ATI108AR1/8	ATI108AS1/8	ATI108AT1/8	ATI108AW1/8
5/32"	AN470	1/2"	.187	ATI108AN5/32	ATI108AP5/32	ATI108AR5/32	ATI108AS5/32	ATI108AT5/32	ATI108AW5/32
3/16"	AN470	1/2"	.187	ATI108AN3/16	ATI108AP3/16	ATI108AR3/16	ATI108AS3/16	ATI108AT3/16	ATI108AW3/16
1/4"	AN470	5/8"	.187	ATI108AN1/4	ATI108AP1/4	ATI108AR1/4	ATI108AS1/4	ATI108AT1/4	ATI108AW1/4
3/32"	AN470	3/8"	.250	ATI108BN3/32	ATI108BP3/32	ATI108BR3/32	ATI108BS3/32	ATI108BT3/32	ATI108BW3/32
1/8"	AN470	3/8"	.250	ATI108BN1/8	ATI108BP1/8	ATI108BR1/8	ATI108BS1/8	ATI108BT1/8	ATI108BW1/8
5/32"	AN470	1/2"	.250	ATI108BN5/32	ATI108BP5/32	ATI108BR5/32	ATI108BS5/32	ATI108BT5/32	ATI108BW5/32
3/16"	AN470	1/2"	.250	ATI108BN3/16	ATI108BP3/16	ATI108BR3/16	ATI108BS3/16	ATI108BT3/16	ATI108BW3/16
1/4"	AN470	5/8"	.250	X	ATI108BP1/4	ATI108BR1/4	ATI108BS1/4	ATI108BT1/4	X
FLUSH	FLUSH	1/2"	.187	ATI109AN	ATI109AP	ATI109AR	ATI109AS	ATI109AT	ATI109AW
FLUSH	FLUSH	3/8"	.187	ATI109EN	ATI109EP	ATI109ER	ATI109ES	ATI109ET	ATI109EW
FLUSH	FLUSH	1/2"	.250	ATI109BN	ATI109BP	ATI109BR	ATI109BS	ATI109BT	ATI109BW

Included in 33 Piece Kit

Included in 16 Piece Kit

### RIVET SQUEEZER SETS FOR MODIFIED UNIVERSAL HEAD RIVETS, BACR15FT

Rivet Size	Rivet Type	Body Diameter	Shank Diameter	1/8" BODY LENGTH	1/4" BODY LENGTH	3/8" BODY LENGTH	1/2" BODY LENGTH	5/8" BODY LENGTH	3/4" BODY LENGTH
5/32"	BACR15FT	1/2"	.187	ATI108AN532F	ATI108AP532F	ATI108AR532F	ATI108AS532F	ATI108AT532F	ATI108AW532F
3/16"	BACR15FT	1/2"	.187	ATI108AN316F	ATI108AP316F	ATI108AR316F	ATI108AS316F	ATI108AT316F	ATI108AW316F
1/4"	BACR15FT	5/8"	.187	ATI108AN1/4F	ATI108AP1/4F	ATI108AR1/4F	ATI108AS1/4F	ATI108AT1/4F	X

### RIVET SQUEEZER KITS

#### ATI108A33PC

- 33 Piece set for installing universal (AN470) and flush (AN426) rivets
- 3/16" Diameter shank with lock ring
- Universal (AN470) cup sizes 3/32", 1/8", 5/32", 3/16" and 1/4"
- Body lengths of 1/8", 1/4", 3/8", 1/2" and 5/8"
- Suitable for either hand or pneumatic squeezers
- See chart above for squeezer sets included

#### ATI108A16PC

- 16 Piece set for installing universal (AN470) and flush (AN426) rivets
- 3/16" Diameter shank with lock ring
- Universal (AN470) cup sizes 3/32", 1/8", 5/32", 3/16" and 1/4"
- Body lengths of 1/8", 1/4", 3/8", 1/2" and 5/8"
- Suitable for either hand or pneumatic squeezers
- See chart above for squeezer sets included



ATI108A33PC



**SAFETY PRECAUTION:** Read and follow all safety and operating instructions.  
**WARNING:** Face & eye protection must be worn while operating power tools, per ANSI B186.1

## RIVETING TOOLS AND ACCESSORIES

### HAND RIVET SQUEEZERS



#### ATI501A - ALLIGATOR-TYPE HAND RIVET SQUEEZER

- 3/32" - 5/32" rivet capacity
- 2 -1/2" reach
- 1-1/8" gap
- 18" handles for ample leverage
- Accepts 3/16" diameter shank rivet squeezer sets and cold dimple dies



ATI501A

#### C-TYPE SWIVEL YOKE HAND RIVET SQUEEZERS

- 3/32" - 5/32" rivet capacity
- 3/8" stroke
- 5/8" ram adjustment to eliminate shims
- 360 degree swivel yoke can be locked in any position
- Accepts 3/16" diameter shank rivet squeezer sets and cold dimple dies

Part Number	Reach	Closed Gap
ATI502AHD	1-1/2"	1-5/8"
ATI502AHE	3"	1-1/2"
ATI502D	1-1/2"	YOKE ONLY
ATI502E	3"	YOKE ONLY

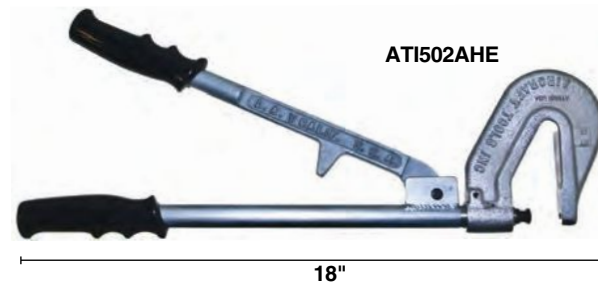

ATI502AHE

18"

### 360° SWIVEL YOKE ATTACHMENTS

The ATI502 Swivel Yokes are furnished with attachment plates to fit the CP214 or equivalent air motor. This unit has a built-in ram adjustment which eliminates the need for washers to adjust the length of the squeezer and will automatically lock in the required position. The yoke can also be locked in any position in the full 360° swing. Uses standard squeezer sets with 3/16" shank diameter.

Part Number	Yoke Depth
ATI502YA	1-1/2"
ATI502YB	3"



\*Does not include power unit

### PNEUMATIC RIVET SQUEEZERS

#### PNEUMATIC RIVET SQUEEZER, ALLIGATOR AND C-TYPE

Use 3/16" shank squeezer sets, refer to ATI108 & ATI109 Series

Part Number	Yoke Style	Cylinder Type	Yoke Reach	Aluminum Rivet Capacity	Steel Rivet Capacity	Overall Length	Weight With Jaws
ATI114A	ALLIGATOR	SINGLE	1-1/2"	1/8"	3/32"	9-1/4"	4 lbs.
ATI114A214	ALLIGATOR	SINGLE	2-1/4"	3/32"	3/32"	10-1/8"	4-1/2 lbs.
ATI114A-3	ALLIGATOR	SINGLE	3"	3/32"	1/16"	10-7/8"	5 lbs.
ATI114TA	ALLIGATOR	TANDEM	1-1/2"	3/16"	5/32"	12"	5-1/2 lbs.
ATI114TA214	ALLIGATOR	TANDEM	2-1/4"	3/16"	1/8"	13"	6 lbs.
ATI114TA-3	ALLIGATOR	TANDEM	3"	5/32"	3/32"	14"	6-1/4 lbs.



ATI114A

Part Number	Yoke Style	Cylinder Type	Yoke Reach	Aluminum Rivet Capacity	Steel Rivet Capacity	Overall Length	Weight With Jaws
ATI114C	C-TYPE	SINGLE	1-1/2"	1/8"	3/32"	10-5/16"	4-1/2 lbs.
ATI114TC	C-TYPE	TANDEM	1-1/2"	3/16"	5/32"	14"	5-1/2 lbs.



ATI114C





Nous contacter :

